



Chipsmall Limited consists of a professional team with an average of over 10 year of expertise in the distribution of electronic components. Based in Hongkong, we have already established firm and mutual-benefit business relationships with customers from,Europe,America and south Asia,supplying obsolete and hard-to-find components to meet their specific needs.

With the principle of "Quality Parts,Customers Priority,Honest Operation,and Considerate Service",our business mainly focus on the distribution of electronic components. Line cards we deal with include Microchip,ALPS,ROHM,Xilinx,Pulse,ON,Everlight and Freescale. Main products comprise IC,Modules,Potentiometer,IC Socket,Relay,Connector.Our parts cover such applications as commercial,industrial, and automotives areas.

We are looking forward to setting up business relationship with you and hope to provide you with the best service and solution. Let us make a better world for our industry!



Contact us

Tel: +86-755-8981 8866 Fax: +86-755-8427 6832

Email & Skype: info@chipsmall.com Web: www.chipsmall.com

Address: A1208, Overseas Decoration Building, #122 Zhenhua RD., Futian, Shenzhen, China



SLE6 • SLE10

Dust Proof



Miniature Power Rocker Switches

C-US UL CSA VDE SEMKO

RoHS Compliant

Features

1. C-US UL, CSA, VDE and SEMKO approved products
2. Snap-in panel mounting
3. Compact size is suited for space-saving design.
4. Best suited for power supply of equipment.
5. Dust-proof type
6. Breaking distance is 3 mm or over.

Specifications

Rating	SLE6	Max.	6A 125VAC · 4A 250AC (Resistive load.)
		Min.	10mA 5VAC/DC (Resistive load.)
	SLE10	Max.	10A 125VAC · 5A 250VAC (Resistive load.)
		Min.	10mA 5VAC/DC (Resistive load.)
Initial contact resistance		20mΩ max. (1A 2~4V DC)	
Dielectric strength		1,500VAC 1 minute (Between terminals)	
Insulation resistance		100MΩ min. (Between terminals) (500VDC)	
Electrical life		10,000 cycles	
Operating force		2.45~12.7N	
Operating temperature range		-25~+85°C	
Storage temperature range		-40~+85°C	

Part Numbering

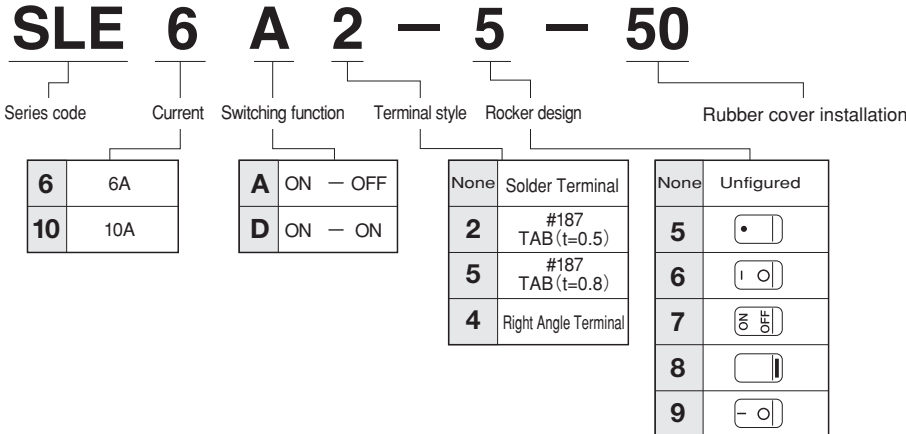

Approvals

UL File No.E43275
 CSA File No.LR38341
 VDE License No.120752
 SEMKO File No.1312452

Terminal Styles

Terminal styles	Solder Terminal	TAB#187		Right Angle Terminal
styles	None	2	5	4
Dimensions				

Marking Color

Frame color-Rocker color	Marking color
Black	White

The black color is standard for the frame and the rocker.
 The gray and the ivory colors are also available as custom-made items.

SLE6 • SLE10

SLE6A
SLE6D
SLE10A
SLE10D

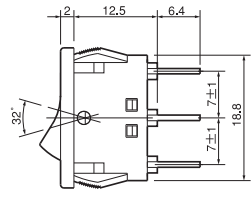
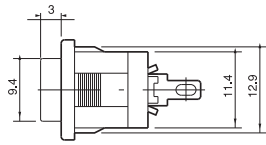
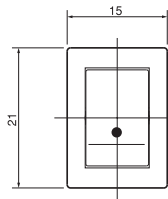

Part No. & rating marking

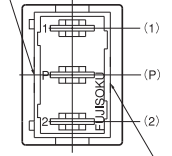

Switching function	Viewed from part No. & rating marking side	
Part No.		
SLE6A-■ SLE10A-■	ON	OFF
Connecting terminals	P-1	-
SLE6D-■ SLE10D-■	ON	ON
Connecting terminals	P-1	P-2

■ : Show the rocker design number.

Solder Terminal

The switching function Type "A" is without terminal number (2).

SLE6A2
SLE6D2
SLE10A2
SLE10D2

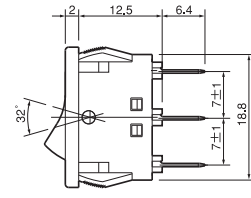
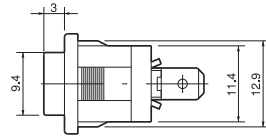
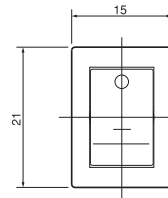

Part No. & rating marking

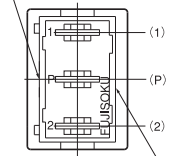

Switching function	Viewed from part No. & rating marking side	
Part No.		
SLE6A2-■ SLE10A2-■	ON	OFF
Connecting terminals	P-1	-
SLE6D2-■ SLE10D2-■	ON	ON
Connecting terminals	P-1	P-2

■ : Show the rocker design number.

TAB # 187

The switching function Type "A" is without terminal number (2).

SLE6A4
SLE6D4
SLE10A4
SLE10D4

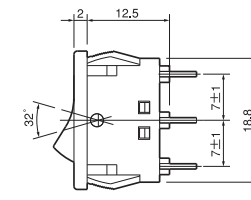
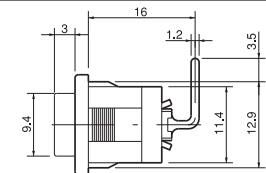
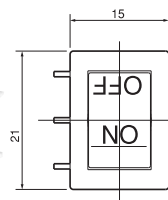

Part No. & rating marking

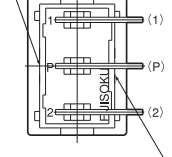

Switching function	Viewed from part No. & rating marking side	
Part No.		
SLE6A4-■ SLE10A4-■	ON	OFF
Connecting terminals	P-1	-
SLE6D4-■ SLE10D4-■	ON	ON
Connecting terminals	P-1	P-2

■ : Show the rocker design number.

Right Angle Terminal

The switching function Type "A" is without terminal number (2).

SLE6A-50 SLE6D-50
SLE6A2-50 SLE6D2-50
SLE6A4-50 SLE6D4-50
SLE6A5-50 SLE6D5-50

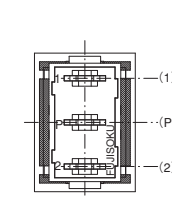
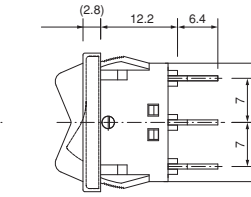
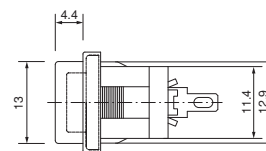
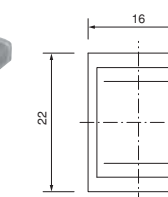

Switching function	Viewed from part No. & rating marking side	
Part No.		
SLE6A-50 SLE6A2-50 SLE6A4-50 SLE6A5-50	ON	OFF
Connecting terminals	P-1	-
SLE6D-50 SLE6D2-50 SLE6D4-50 SLE6D5-50	ON	ON
Connecting terminals	P-1	P-2

Rubber cover installation

The switching function Type "A" is without terminal number (2).

PC Hole Layouts

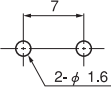
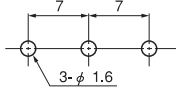
Series	SLE6A4 SLE10A4	SLE6D4 SLE10D4
Dimensions		

Panel Cut-Out Dimensions

Switches



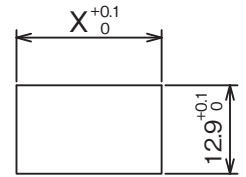

Panel thickness	X
0.75~1.25	19.2
1.25~3.5	19.4

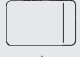

Switch Guard Installation

Panel thickness	X
0.75~2.8	19.4

Table of Part Numbers

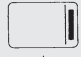
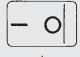
Current	Terminal styles	Switching function	Part No. and rating marking side					
								
6A	Solder Terminal	ON-OFF	SLE6A	SLE6A-5	SLE6A-6	SLE6A-7	★SLE6A-8	☆SLE6A-9
		ON-ON	SLE6D	★SLE6D-5	☆SLE6D-6	▲SLE6D-7	▲SLE6D-8	▲SLE6D-9
	t=0.5 TAB	ON-OFF	SLE6A2	SLE6A2-5	SLE6A2-6	SLE6A2-7	▲SLE6A2-8	☆SLE6A2-9
		ON-ON	SLE6D2	★SLE6D2-5	▲SLE6D2-6	★SLE6D2-7	▲SLE6D2-8	★SLE6D2-9
	t=0.8 TAB	ON-OFF	▲SLE6A5	★SLE6A5-5	★SLE6A5-6	★SLE6A5-7	▲SLE6A5-8	★SLE6A5-9
		ON-ON	▲SLE6D5	▲SLE6D5-5	▲SLE6D5-6	▲SLE6D5-7	▲SLE6D5-8	★SLE6D5-9
	Right Angle Terminal	ON-OFF	▲SLE6A4	★SLE6A4-5	★SLE6A4-6	★SLE6A4-7	▲SLE6A4-8	▲SLE6A4-9
		ON-ON	★SLE6D4	★SLE6D4-5	★SLE6D4-6	★SLE6D4-7	▲SLE6D4-8	▲SLE6D4-9
10A	Solder Terminal	ON-OFF	★SLE10A	★SLE10A-5	★SLE10A-6	☆SLE10A-7	▲SLE10A-8	★SLE10A-9
		ON-ON	★SLE10D	★SLE10D-5	▲SLE10D-6	▲SLE10D-7	▲SLE10D-8	▲SLE10D-9
	t=0.5 TAB#187	ON-OFF	★SLE10A2	SLE10A2-5	SLE10A2-6	★SLE10A2-7	▲SLE10A2-8	★SLE10A2-9
		ON-ON	▲SLE10D2	★SLE10D2-5	★SLE10D2-6	▲SLE10D2-7	▲SLE10D2-8	▲SLE10D2-9
	t=0.8 TAB#187	ON-OFF	▲SLE10A5	☆SLE10A5-5	★SLE10A5-6	▲SLE10A5-7	▲SLE10A5-8	★SLE10A5-9
		ON-ON	★SLE10D5	▲SLE10D5-5	▲SLE10D5-6	★SLE10D5-7	▲SLE10D5-8	▲SLE10D5-9
	Right Angle Terminal	ON-OFF	▲SLE10A4	★SLE10A4-5	▲SLE10A4-6	★SLE10A4-7	▲SLE10A4-8	▲SLE10A4-9
		ON-ON	★SLE10D4	▲SLE10D4-5	▲SLE10D4-6	▲SLE10D4-7	▲SLE10D4-8	▲SLE10D4-9

Fit on rubber cover

Current	Terminal styles	Switching function	Part No.
6A	Solder Terminal	ON-OFF	★SLE6A-50
		ON-ON	★SLE6D-50
	t-0.5 TAB	ON-OFF	★SLE6A2-50
		ON-ON	★SLE6D2-50
	t-0.8 TAB	ON-OFF	★SLE6A5-50
		ON-ON	★SLE6D5-50
	Right Angle Terminal	ON-OFF	★SLE6A4-50
		ON-ON	★SLE6D4-50

Handling Precautions

1. Soldering Specifications

(1) Manual Soldering

Device : Soldering iron
380°C, Max.; 3 seconds, Max.

※The tab terminals cannot be soldered

2. Precautions for panel mounting

Page.....314

Switch Guard

For details, refer to page 312.