



Chipsmall Limited consists of a professional team with an average of over 10 year of expertise in the distribution of electronic components. Based in Hongkong, we have already established firm and mutual-benefit business relationships with customers from,Europe,America and south Asia,supplying obsolete and hard-to-find components to meet their specific needs.

With the principle of "Quality Parts,Customers Priority,Honest Operation,and Considerate Service",our business mainly focus on the distribution of electronic components. Line cards we deal with include Microchip,ALPS,ROHM,Xilinx,Pulse,ON,Everlight and Freescale. Main products comprise IC,Modules,Potentiometer,IC Socket,Relay,Connector.Our parts cover such applications as commercial,industrial, and automotives areas.

We are looking forward to setting up business relationship with you and hope to provide you with the best service and solution. Let us make a better world for our industry!



Contact us

Tel: +86-755-8981 8866 Fax: +86-755-8427 6832

Email & Skype: info@chipsmall.com Web: www.chipsmall.com

Address: A1208, Overseas Decoration Building, #122 Zhenhua RD., Futian, Shenzhen, China



SML-LX4014UWC-TR, 4.0x1.4mm Ultra Bright White SMT LED

ITW ECS Lumex announces the release of the QuasarBrite 4.0X1.4mm ultra bright white surface mount LED. The combined feature of this LED which includes a unique rectangular surface mount package, wide viewing angle and very high intensity output makes it ideal for backlighting, sunlight visible indication and even small space lighting applications.

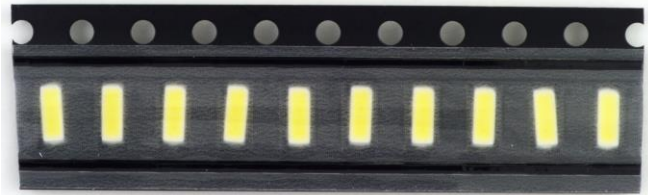
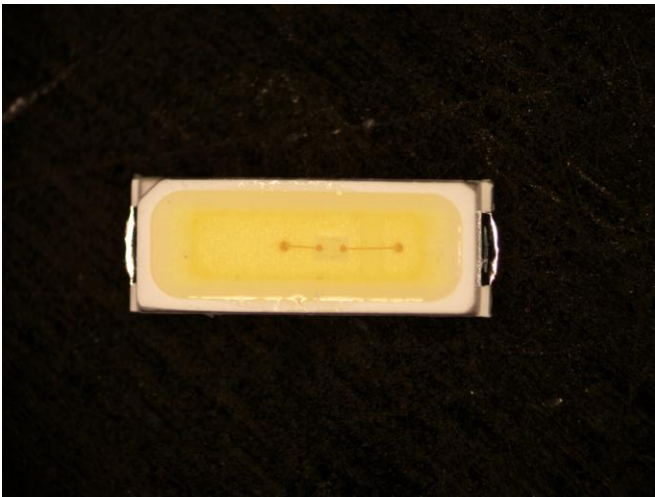

Product Features	Benefits
Rectangular package	Illuminates wider spread of light thus reducing multiple LEDs
Surface Mount	Offers assembly savings of up to 25%
Tape & Reel packaging	Easy mounting with pick and place process
Increased intensity of 50% compared to similar size LEDs	Greater visibility and clarity
Low current	Power saving

SML-LX4014UWC-TR, 4.0x1.4mm Ultra Bright White SMT LED

Technical Information & Drawing

PN	Emitted Color	Chip Material	Color Temperature (K)	Lens Type	Forward Voltage Vf		Typical Intensity (Lumens)	View Angle 2xTheta	If (mA)
					Min	Max			
SML-LX4014UWC-TR	White	InGaN	6500	Clear	2.9	3.4	21	120	60

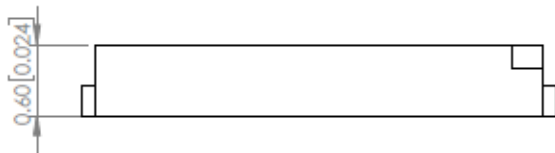
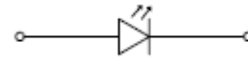
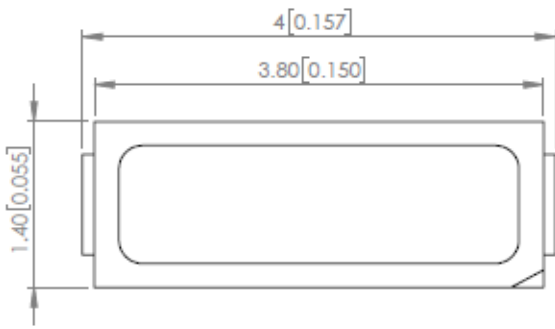

RECOMMENDED PCB LAYOUT

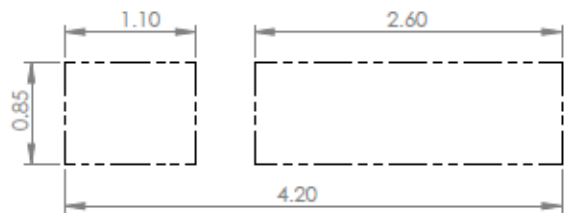
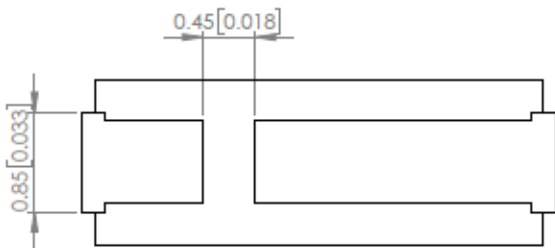

SML-LX4014UWC-TR, 4.0x1.4mm Ultra Bright White SMT LED

Markets	Applications
<ul style="list-style-type: none"> ▪ Medical ▪ Telecommunications ▪ Industrial Controls ▪ Appliance ▪ Security ▪ Transportation 	<ul style="list-style-type: none"> ▪ Portable Medical Diagnostics ▪ Routers, Switches, Indications ▪ Indications, Controls & Switches ▪ Backlighting & Illumination ▪ Switches & indications ▪ Illumination, Switches, Indications, backlighting

