



Chipsmall Limited consists of a professional team with an average of over 10 year of expertise in the distribution of electronic components. Based in Hongkong, we have already established firm and mutual-benefit business relationships with customers from,Europe,America and south Asia,supplying obsolete and hard-to-find components to meet their specific needs.

With the principle of “Quality Parts,Customers Priority,Honest Operation,and Considerate Service”,our business mainly focus on the distribution of electronic components. Line cards we deal with include Microchip,ALPS,ROHM,Xilinx,Pulse,ON,Everlight and Freescale. Main products comprise IC,Modules,Potentiometer,IC Socket,Relay,Connector.Our parts cover such applications as commercial,industrial, and automotives areas.

We are looking forward to setting up business relationship with you and hope to provide you with the best service and solution. Let us make a better world for our industry!



Contact us

Tel: +86-755-8981 8866 Fax: +86-755-8427 6832

Email & Skype: info@chipsmall.com Web: www.chipsmall.com

Address: A1208, Overseas Decoration Building, #122 Zhenhua RD., Futian, Shenzhen, China



NOTES:

1. MATERIALS AND FINISHES:
 - BODY & CONTACT - BeCu, GOLD PLATING
 - REAR BODY - BRASS, GOLD PLATING
 - INSULATORS - PTFE, NATURAL
 - FERRULE - COPPER, NICKEL PLATING
 - RETAINING RING - BeCu, NICKEL PLATING
2. ELECTRICAL:
 - A. IMPEDANCE: 50 OHM
 - B. FREQUENCY RANGE: DC - 6 GHz
3. MECHANICAL:
 - A. DURABILITY: 100 CYCLES MIN.
 - B. TEMPERATURE RANGE: -65°C TO +165°C
4. PACKAGING:
 - A. QUANTITY: SINGLE PACK
 - B. MARKING: BAG TO BE MARKED
"AMPHENOL RF, SMP-FS-C08-1-R AND DATE CODE"
 - C. CONTACT PIN AND FERRULE ARE PACKAGED LOOSE.
中心针和压接套筒散装。
5. CABLE ASSEMBLY INSTRUCTIONS:
 - A. TRIM CABLE AS SHOWN.
 - B. SOLDER CABLE CENTER CONDUCTOR TO CONTACT.
 - C. CRIMP FERRULE WITH 0.128" HEX.

6 SHOWS CABLE ENTRY DIMENSIONS.

THIRD ANGLE PROJ. 

REVISIONS				
REV	DESCRIPTION	DATE	ECO	APPR
A	RELEASE TO MFG.	15-Apr-15	50495	JTS
B	FREQUENCY UPDATED TO 6 GHz	17-Nov-16	02424	NR
C	DOCUMENTATION CHANGE	01-Dec-16	02641	BMG

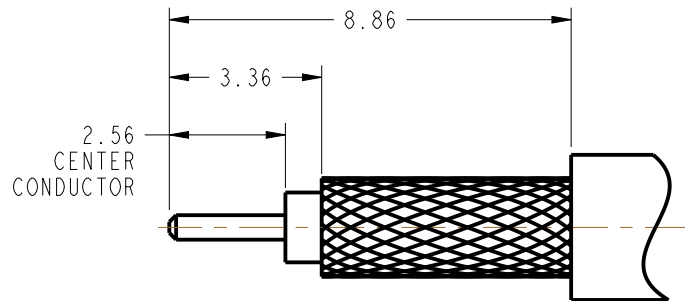

RECOMMENDED CABLE STRIPPING DIMENSIONS

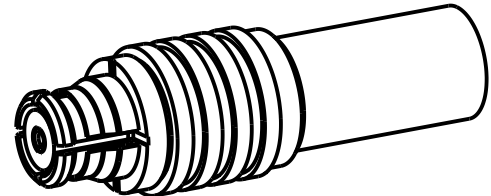

SCALE 4.000

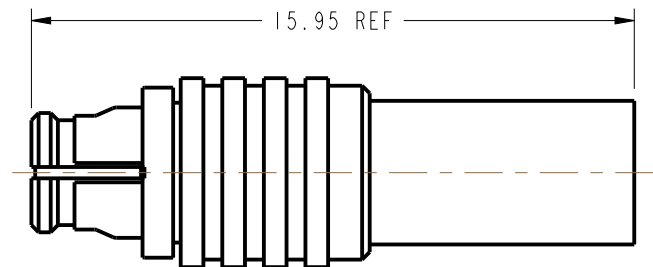

ASSEMBLED VIEW

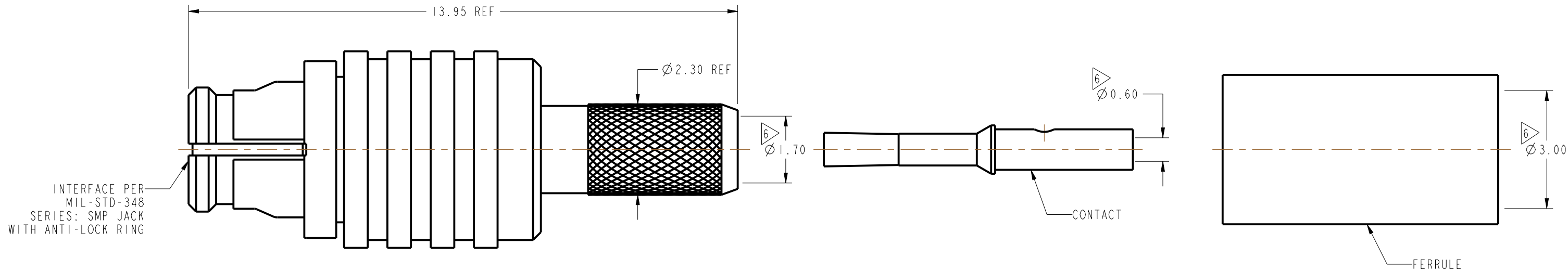

CUSTOMER OUTLINE DRAWING

ALL OTHER SHEETS ARE FOR INTERNAL USE ONLY

UNLESS OTHERWISE SPECIFIED, DIMENSIONS ARE IN METRIC AND TOLERANCES ARE: <0.5mm 0.5 - 6mm 6 - 30mm 30 - 120mm ANGLES ± 0.05mm ±0.1mm ±0.2mm ± 0.3mm ±1° NOTICE - These drawings, specifications, or other data (1) are, and remain the property of Amphenol corp. (2) must be returned upon request; and (3) are confidential and not to be disclosed to any person other than those to whom they are given by Amphenol Corp. the furnishing of these drawings, specifications, or other data by Amphenol Corp., or to any other person to anyone for any purpose is not to be regarded by implication or otherwise in any manner licensing, granting rights to permitting such holder or any other person to manufacture, use or sell any product, process or design, patented or otherwise, that may in any way be related to or disclosed by said drawings, specifications, or other data.	MATERIAL	DRAWN STAR	DATE 17-Nov-16	TITLE SMP STR PLUG WITH FEMALE CONTACT FOR RG 316 CABLE		Amphenol RF www.amphenolrf.com	
	SEE NOTES	ENGINEER SUNDE	DATE 22-Apr-15			DRAWING NO. SMP-FS-C08-1-R	
	REFERENCE EAR # 4720.2	APPROVED HARRY	DATE 22-Nov-16	SCALE: 10.0:1.0	SHEET 2 OF 2	ITEM NO. SMP-FS-C08-1-R	
	CONFIGURATION LEVEL: In Work	CAD FILE	DWG SIZE B		REV C	PART NO. SMP-FS-C08-1-R	
	FINISH						