



Chipsmall Limited consists of a professional team with an average of over 10 year of expertise in the distribution of electronic components. Based in Hongkong, we have already established firm and mutual-benefit business relationships with customers from,Europe,America and south Asia,supplying obsolete and hard-to-find components to meet their specific needs.

With the principle of "Quality Parts,Customers Priority,Honest Operation,and Considerate Service",our business mainly focus on the distribution of electronic components. Line cards we deal with include Microchip,ALPS,ROHM,Xilinx,Pulse,ON,Everlight and Freescale. Main products comprise IC,Modules,Potentiometer,IC Socket,Relay,Connector.Our parts cover such applications as commercial,industrial, and automotives areas.

We are looking forward to setting up business relationship with you and hope to provide you with the best service and solution. Let us make a better world for our industry!



Contact us

Tel: +86-755-8981 8866 Fax: +86-755-8427 6832

Email & Skype: info@chipsmall.com Web: www.chipsmall.com

Address: A1208, Overseas Decoration Building, #122 Zhenhua RD., Futian, Shenzhen, China



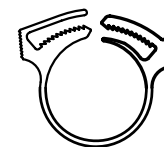
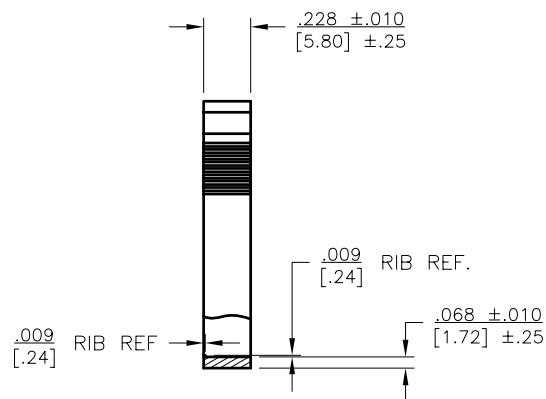
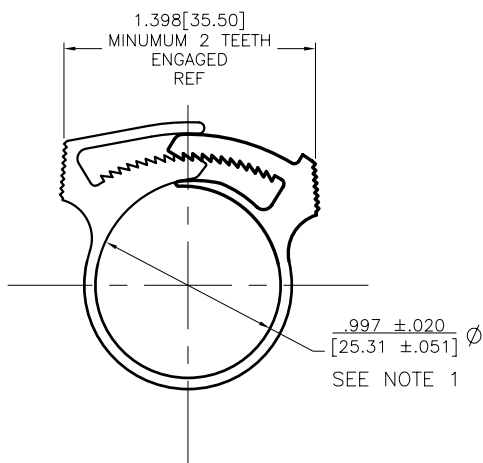
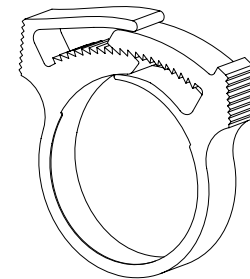
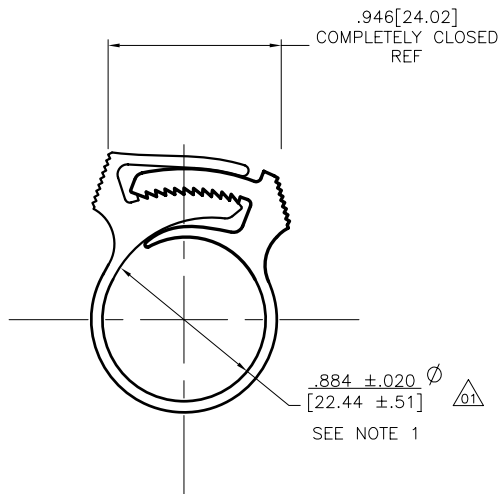

AS MOLDED
FULL SCALE

REDUCED
NO SCALE

HellermannTyton.

ALL PROPRIETARY RIGHTS IN THE SUBJECT MATTER SHOWN ON
THIS DRAWING ARE EXCLUSIVE PROPERTY OF HELLERMANN TYTON.

name	date	city, state

NOTES

NOTE:

- 1) INSIDED DIAMETERS ARE MEASURED IN THREE PLACES SPACED 120°
APART EXCLUDING .009 WIDE RIB.
- 2) 22 TOTAL TEETH, 10 TEETH POSITIONS
- 3) DRAWING CREATED FROM SNP-24 DATA BASE.
USE FOR DIMENSIONAL INFO. ONLY.

REVISION

level	date	by	ECN #
01	10/31/00	AAM	002214
part level	A		

DIMENSIONS

.XXXX=	.XXX= NOTED
.XX=	.X=
∠=	
unless otherwise specified	
units	inches/[mm]

PART

number	phase
SNP1910	PRODUCTION
name	SNAPPER 19 HOSE CLAMP
material	ACETAL WHITE

DRAWING

FORMAT	C version	L	CAD	ACAD	scale
CP\EST\2019002_01					2X
computer file number	previous number				
CP\EST\2019002A					
drawn	checked	by	date	approved	
A.A.M.		K.A.C.	02/18/00	11/01/00	
type	CUSTOMER	sheet	1	of	1
number	CP2019002CST				