



Chipsmall Limited consists of a professional team with an average of over 10 year of expertise in the distribution of electronic components. Based in Hongkong, we have already established firm and mutual-benefit business relationships with customers from,Europe,America and south Asia,supplying obsolete and hard-to-find components to meet their specific needs.

With the principle of “Quality Parts,Customers Priority,Honest Operation,and Considerate Service”,our business mainly focus on the distribution of electronic components. Line cards we deal with include Microchip,ALPS,ROHM,Xilinx,Pulse,ON,Everlight and Freescale. Main products comprise IC,Modules,Potentiometer,IC Socket,Relay,Connector.Our parts cover such applications as commercial,industrial, and automotives areas.

We are looking forward to setting up business relationship with you and hope to provide you with the best service and solution. Let us make a better world for our industry!



## Contact us

Tel: +86-755-8981 8866 Fax: +86-755-8427 6832

Email & Skype: info@chipsmall.com Web: www.chipsmall.com

Address: A1208, Overseas Decoration Building, #122 Zhenhua RD., Futian, Shenzhen, China



XXXY	STYLE	SEE SHEET
998ELF	"A"	1
998ZLF	"B"	2

**NOTE RoHS INFORMATION**

- The "LF" products meet european union Directives and other country regulations as described in 65-22-008.
- Packaging spec: see 65-14-920

TABLE 1				
PART NUMBER			DIMENSION	
SPF080-1 X [ ]	[ ]	- XXXYLF	"A"	"B"
	01		0	0
	02		.100	1
	03		.200	2
	04		.300	3
	05		.400	4
	06		.500	5
	07		.600	6
	08		.700	7
	09		.800	8
	10		.900	9
	11		1.000	10
	12		1.100	11
	13		1.200	12
	14		1.300	13
	15		1.400	14
	16		1.500	15
	17		1.600	16
	18		1.700	17

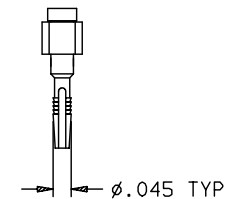
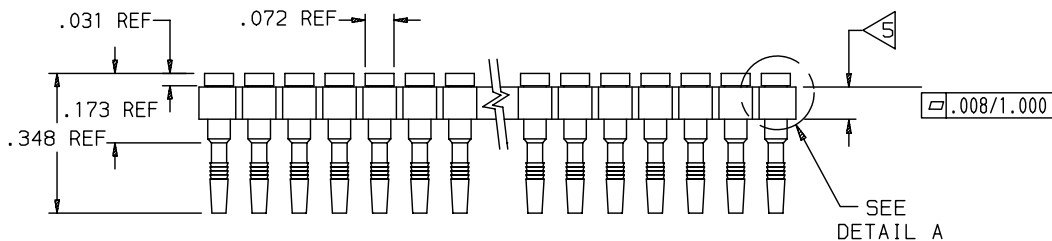
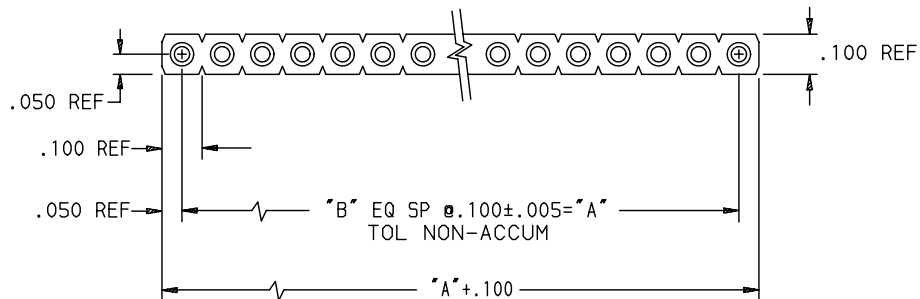

STYLE "A"

**NOTES:**

- CONTACT MATERIAL:  
OUTER SHELL: BRASS ALLOY 360, 1/2 HARD, PER ASTM B16.  
INNER CONTACT: BERYLLIUM COPPER, ALLOY 172, PER ASTM B194.
- CONTACT PLATING:  
OUTER SHELL: 80u" TO 120u" TIN/LEAD PER SAE AMS-P-81728,  
OUTER SHELL: 80u" TO 120u" TIN for LEAD FREE VERSION  
OVER 100u" TO 200u" NICKEL PER QQ-N-290.  
INNER CONTACT: 200u" TIN/LEAD PER SAE AMS-P-81728,  
INNER CONTACT: 200u" TIN for LEAD FREE VERSION  
OVER 50u" NICKEL PER QQ-N-290.
- NUMBER OF CONTACTS PER ROW (01 TO 18).
- RECOMMENDED PCB THRU HOLE DIA. .040±.003
- INSULATOR THICKNESS MAY BE .080 OR .100.
- INSULATOR MATERIAL:  
BLACK GLASS FILLED POLYESTER (PCT)

www.fciconnect.com		surface ISO 1302	tolerance std ISO 406 ISO 1101	projection INCH
TOLERANCES UNLESS OTHERWISE SPECIFIED				
Dr	D-WOLFORD	2000/10/01	0.X	±0.1
Eng	A-VASBINDER	2000/10/01	0.XX	±0.1
Chr	A-VASBINDER	2000/10/01	0.XXX	±0.1
Appr	A-VASBINDER	2000/10/01	Product family SOCKET Spec ref -	
FCj		SINGLE ROW SIP		size A3
COMPLIANT PRESS FIT		SEE TABLE		Scale 1:1
title	58808			ECN LS08-0051
catalog no	CUSTOMER			sheet 1 of 2

rev	ecn no	dr	date
H	LS07-0271	HLE	2007/10/29
J	LS07-0299	HLE	2007/11/21
K	LS08-0038	STG	2008/02/01
L	LS08-0051	HLE	2008/02/11
-	-	-	-
F	LS06-0189	HLE	2006/11/20
G	LS07-0141	HLE	2007/05/21

Copyright FCJ. FCj

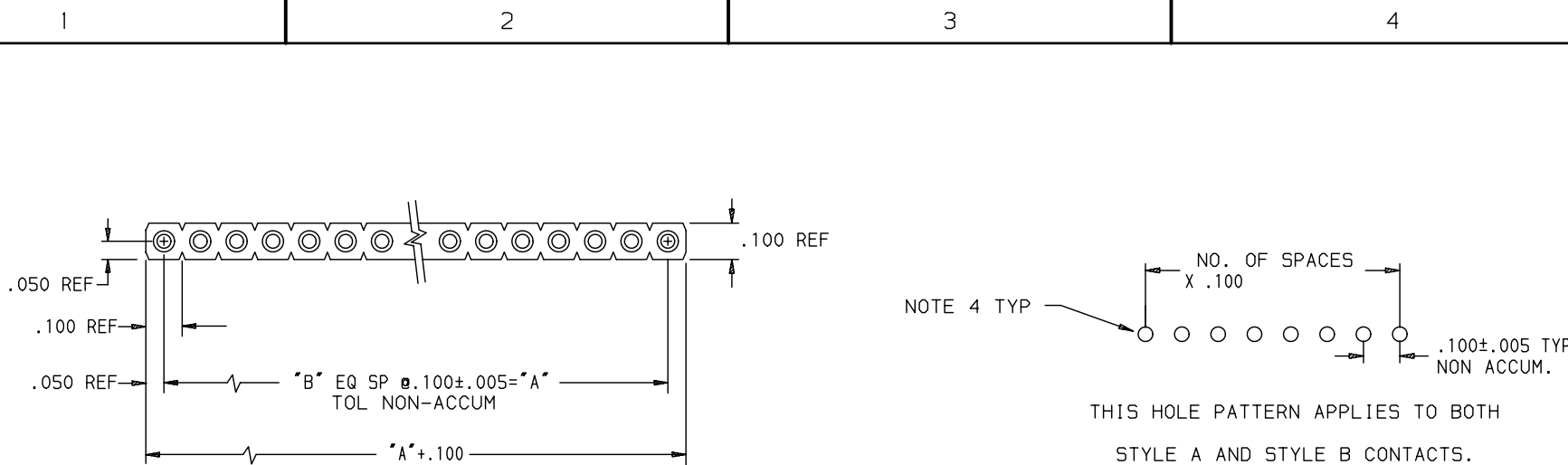

NOTE 4 TYP

THIS HOLE PATTERN APPLIES TO BOTH  
STYLE A AND STYLE B CONTACTS.

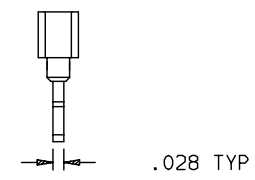
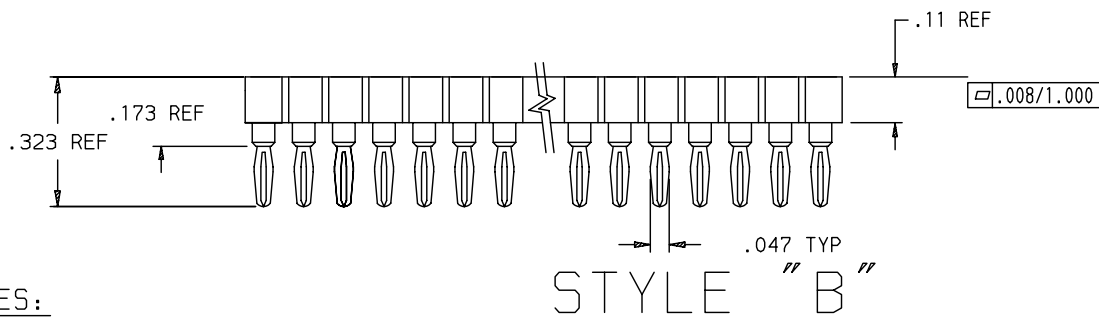

STYLE "B"

NOTES:

1. CONTACT MATERIAL:  
OUTER SHELL: PHOSPHOR BRONZE.  
INNER CONTACT: BERYLLIUM COPPER.
2. CONTACT PLATING:  
OUTER SHELL: 200u" TIN/LEAD PER SAE AMS-P-81728,  
OUTER SHELL: 200u" TIN for LEAD FREE VERSION  
OVER 100u" NICKEL PER QQ-N-290.  
INNER CONTACT: 200u" TIN/LEAD PER SAE AMS-P-81728,  
INNER CONTACT: 200u" TIN for LEAD FREE VERSION  
OVER 100u" NICKEL PER QQ-N-290.
3. NUMBER OF CONTACTS PER ROW (01 TO 18).
4. COMPLIANT PRESS FIT IN  $\phi$  .040±.003 PLATED HOLE, RECOMMENDED DRILL SIZE 1.15 MM FOR .090 TO .130 THICK BOARD.
5. INSULATOR MATERIAL:  
BLACK GLASS FILLED POLYESTER (PCT)

NOTE RoHS INFORMATION

- The "LF" products meet european union Directives and other country regulations as described in 65-22-008.
- Packaging spec: see 65-14-920

www.fciconnect.com		surface ISO 1302 ✓	tolerance std ISO 406 ISO 1101	projection inch
TOLERANCES UNLESS OTHERWISE SPECIFIED				
Dr	D-WOLFORD	2000/10/01	ANGULAR	0.X ±0.1
Eng	A-VASBINDER	2000/10/01	LINEAR	0.XX ±0.1
Chr	A-VASBINDER	2000/10/01	0.XX' ±2'	0.XXX ±0.1
Appr	A-VASBINDER	2000/10/01	Product family	SOCKET
size				A3
Scale				1:1
ECN				LS08-0051
Spec ref				-
title			58808	
SINGLE ROW SIP			Rev.	
COMPLIANT PRESS FIT			L	
catalog no			SEE TABLE	CUSTOMER
			sheet 2 of 2	

rev	ecn no	dr	date
H	LS07-0271	HLE	2007/10/29
J	LS070299	DLW	2007/11/21
K	LS08-0038	STG	2008/02/01
L	LS08-0051	HLE	2008/02/11
-	-	-	-
F	LS06-0189	HLE	2006/11/20
G	LS07-0141	HLE	2007/05/21

Copyright FCJ.