



Chipsmall Limited consists of a professional team with an average of over 10 year of expertise in the distribution of electronic components. Based in Hongkong, we have already established firm and mutual-benefit business relationships with customers from,Europe,America and south Asia,supplying obsolete and hard-to-find components to meet their specific needs.

With the principle of “Quality Parts,Customers Priority,Honest Operation,and Considerate Service”,our business mainly focus on the distribution of electronic components. Line cards we deal with include Microchip,ALPS,ROHM,Xilinx,Pulse,ON,Everlight and Freescale. Main products comprise IC,Modules,Potentiometer,IC Socket,Relay,Connector.Our parts cover such applications as commercial,industrial, and automotives areas.

We are looking forward to setting up business relationship with you and hope to provide you with the best service and solution. Let us make a better world for our industry!



Contact us

Tel: +86-755-8981 8866 Fax: +86-755-8427 6832

Email & Skype: info@chipsmall.com Web: www.chipsmall.com

Address: A1208, Overseas Decoration Building, #122 Zhenhua RD., Futian, Shenzhen, China



Rocker Switch

Single Pole SR Series – SRJ



Features

- Self-locking tabs
- Minimum 50,000 operations mechanical life
- RoHS compliant

Standard Parts¹

North America and Europe			
SRJ22A3BBBNN	SRJ23A3BBBNN	SRJ24A3BBBNN	SRJ24A3HBBNN

¹The part number configuration matrix below provides details to the part numbers above. For configurable part numbers that are not listed above, contact the factory or your distributor.

Part Number Breakdown

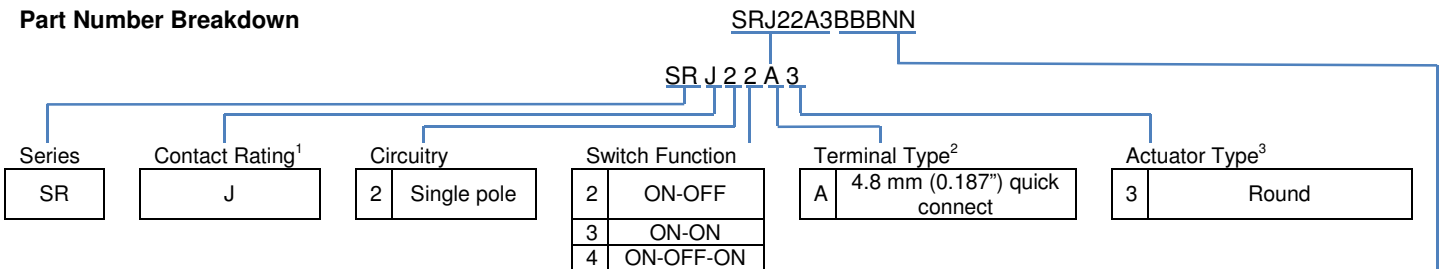

¹See Electrical Specifications section

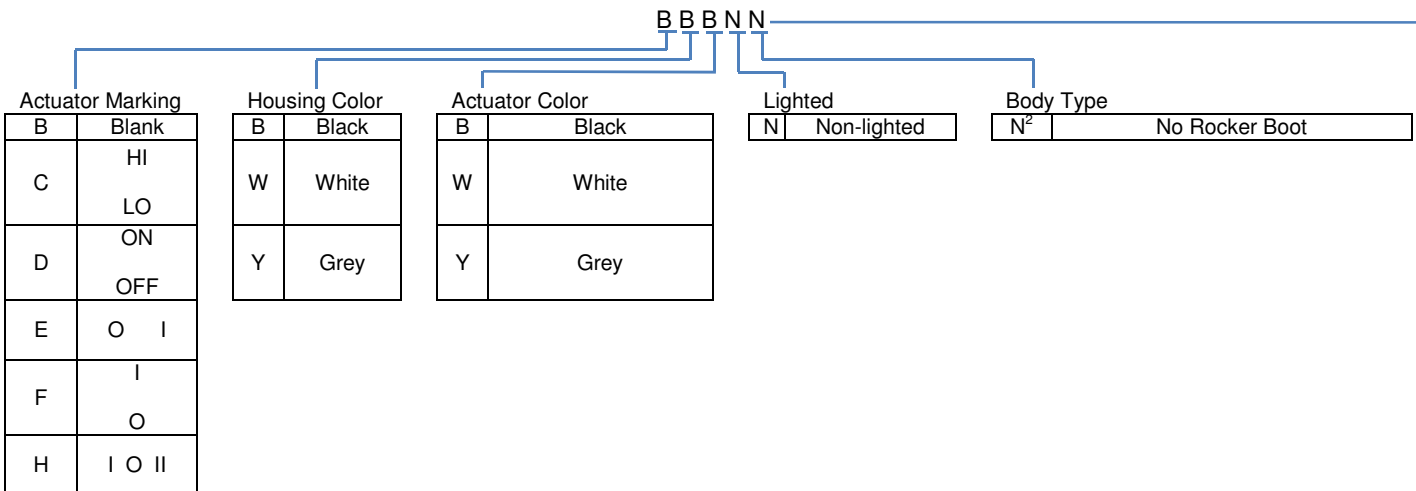

²A splash-proof boot can be ordered separately as part number 00150751

PLEASE NOTE

CHERRY
 will become
ZF in 2017.

Electrical Specifications

Inrush Rating – 2 Position		48 A
Inrush Rating – 3 Position		24 A
Dielectric Strength		1000 VAC for 1 minute
Insulation Resistance		100 MΩ min at 500 VDC
Initial Contact Resistance		0.020 Ω max
Switch Function	<u>EN61058-1 Rating</u>	<u>UL General Purpose Rating</u>
All	N/A	20 A 125 VAC / 12 A 250 VAC
Electrical Life at Rated Load	<u>VDE</u>	<u>UL</u>
Minimum Operations	N/A	6,000

UL File No: E23301

Material and Environmental Specifications

Actuator		Nylon 66 94V-2
Base		Nylon 66 94V-2
Spring		Steel Wire
Contacts		Silver Alloy
Movable Arm		Silver-Plated Copper Alloy
Terminals		Tin-Plated Copper Alloy
Operating Temperature Range		-20 °C to +65 °C (-4 °F to +149 °F)

Circuitry and Switch Functions

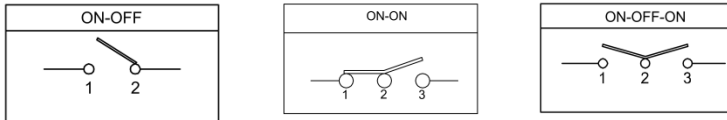

Dimensions mm (inches)

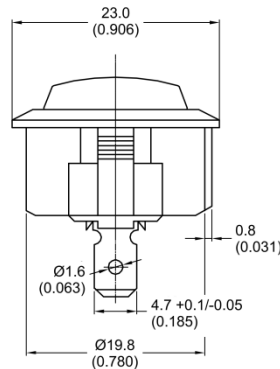
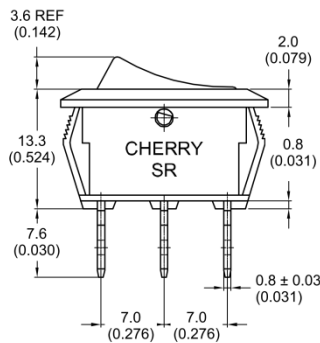
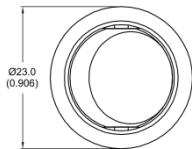

NOTE: TOLERANCES ± 0.3 (0.012) UNLESS OTHERWISE SPECIFIED

