



Chipsmall Limited consists of a professional team with an average of over 10 year of expertise in the distribution of electronic components. Based in Hongkong, we have already established firm and mutual-benefit business relationships with customers from,Europe,America and south Asia,supplying obsolete and hard-to-find components to meet their specific needs.

With the principle of "Quality Parts,Customers Priority,Honest Operation,and Considerate Service",our business mainly focus on the distribution of electronic components. Line cards we deal with include Microchip,ALPS,ROHM,Xilinx,Pulse,ON,Everlight and Freescale. Main products comprise IC,Modules,Potentiometer,IC Socket,Relay,Connector.Our parts cover such applications as commercial,industrial, and automotives areas.

We are looking forward to setting up business relationship with you and hope to provide you with the best service and solution. Let us make a better world for our industry!



## Contact us

Tel: +86-755-8981 8866 Fax: +86-755-8427 6832

Email & Skype: info@chipsmall.com Web: www.chipsmall.com

Address: A1208, Overseas Decoration Building, #122 Zhenhua RD., Futian, Shenzhen, China



# SS220K-23

## Miniature Slide Switches



RoHS Compliant



### Features

#### 1. For Embedded Use

The switch can be embedded in the plastic mold housing of equipment or power tools to reduce the overall size.

#### 2. Power Switch Application

Suitable for power supplies where small size and large current capacity is required (inrush current: 70 A).

#### 3. Anti-welding (forced separation) mechanism

In case the contacts are welded, the switch is structured to force separation of the contacts.

### Specifications

Rating	Resistive load	20A 250VAC
	Inductive load	250VAC 70A (p.f.=0.7)/20A (p.f.=0.9)
Initial contact resistance	20mΩ max. (1A 2~4VDC)	
Dielectric strength	250VAC 1 minute	
Insulation resistance	100MΩ min. (500VDC)	
Electrical life	10,000 operations.	
Operating force	3.43~7.35 N	
Operating temperature range	-10~+50°C	
Storage temperature range	-20~+70°C	

### Terminal style

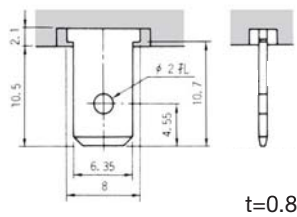

(TAB terminals)

### Structure

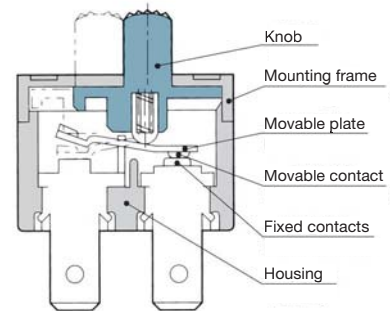

### SS220K-23-Z DPST



#250  
(TAB terminals)

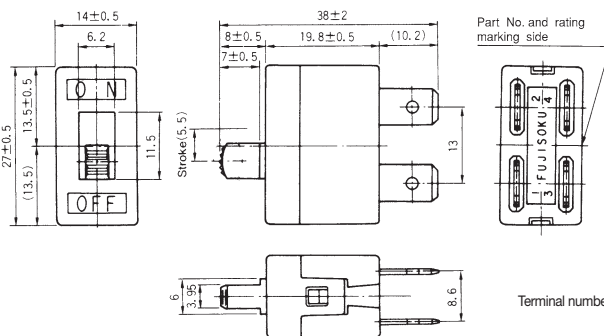

Terminal numbers are shown on the bottom of the switch.

Switchingfunction	Viewed from part No. marking side	
Part No.	ON	OFF
★SS220K-23-Z	ON	OFF
Connecting terminals	1-2 3-4	—