



Chipsmall Limited consists of a professional team with an average of over 10 year of expertise in the distribution of electronic components. Based in Hongkong, we have already established firm and mutual-benefit business relationships with customers from,Europe,America and south Asia,supplying obsolete and hard-to-find components to meet their specific needs.

With the principle of "Quality Parts,Customers Priority,Honest Operation,and Considerate Service",our business mainly focus on the distribution of electronic components. Line cards we deal with include Microchip,ALPS,ROHM,Xilinx,Pulse,ON,Everlight and Freescale. Main products comprise IC,Modules,Potentiometer,IC Socket,Relay,Connector.Our parts cover such applications as commercial,industrial, and automotives areas.

We are looking forward to setting up business relationship with you and hope to provide you with the best service and solution. Let us make a better world for our industry!



Contact us

Tel: +86-755-8981 8866 Fax: +86-755-8427 6832

Email & Skype: info@chipsmall.com Web: www.chipsmall.com

Address: A1208, Overseas Decoration Building, #122 Zhenhua RD., Futian, Shenzhen, China



REVISIONS					
REV	ECO	DESCRIPTION	DATE	BY	APPR
B1	-	RELEASED DRAWING	AUG-18-2014	BEN	TOMMY

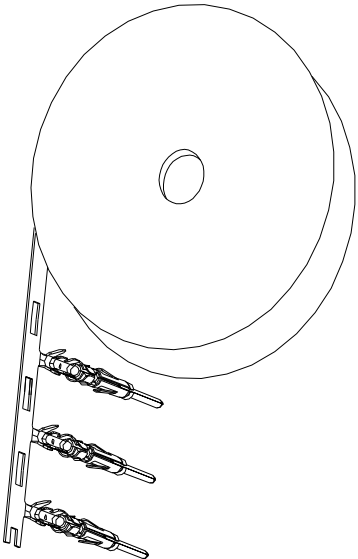

CONTACT ORIENTATION ON ROLL

NOTES : (UNLESS OTHERWISE SPECIFIED)

1. MATERIAL :

1.1. CONTACT BODY : COPPER ALLOY.

1.2. OUTER SPRING : STAINLESS STEEL.
2. SPECIFICATIONS :

2.1 CURRENT RATING : 5A MAX.

2.2 TERMINATION TYPE : CRIMPING.

2.3 WIRE RANGE : 30~28AWG.

2.4 WIRE INSULATION DIA(MAX) : Ø2.6mm.
3. ROHS COMPLIANT.
4. ALL DIMENSIONS ARE FOR REFERENCE USE ONLY.
5. AVAILABLE TOOLS :

5.1 HAND CRIMPER : MFX-3954.

5.2 CRIMP APPLICATOR : MFX-3957.

5.3 EXTRACTION TOOL : QXRT20.

P/N	CONTACT PLATING(MATING AREA)
SS28W1T	TIN PLATING OVER NICKEL
SS28W1F	GOLD FLASH PLATING OVER NICKEL
SS28W1G5	5µ" GOLD PLATING OVER NICKEL
SS28W1G10	10µ" GOLD PLATING OVER NICKEL
SS28W1G15	15µ" GOLD PLATING OVER NICKEL
SS28W1G30	30µ" GOLD PLATING OVER NICKEL

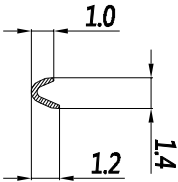

SECTION A-A

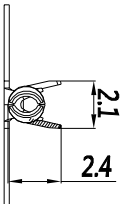

SECTION B-B

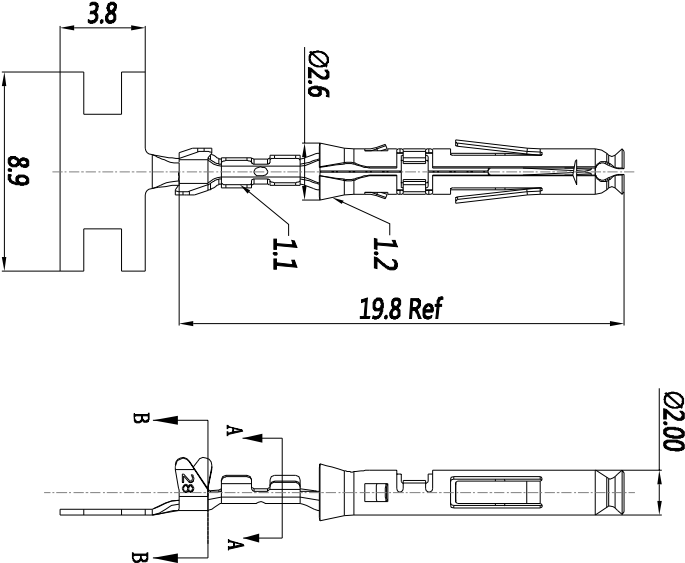

QUANTITY	PART NUMBER	DESCRIPTION	ITEM
MATERIALS LIST			
UNLESS OTHERWISE SPECIFIED			
1) All dimensions are in millimeters.			
2) Tolerances are as follows:			
1 PL DEC 20 20			
3 PL DEC 20 20			
3) Note reference = A			
MATERIAL SPECIFICATIONS:			
CUSTOMER:			
THIS DRAWING IS SUPPLIED FOR SPECIFICATIONS AND PERFORMANCE DATA. THE INFORMATION AND THE INFORMATION OF REPRODUCTION ARE LIMITED. ALL MANUFACTURING VARIATION.			
PROCESS SPECIFICATIONS:			
NEXT ASST:			

Amphenol

Shine Systems - www.amphenol-shine.com
44724 Money Drive
Clinton Township, MI 48038

ECO-MATE SOCKET,
STAMPED, 30-28AWG, SIZE 20.

SIZE TYPE B C-
DWG NO. SS28W1X
SCALE NONE
SHEET 1 OF 1

REVISION B1