



Chipsmall Limited consists of a professional team with an average of over 10 year of expertise in the distribution of electronic components. Based in Hongkong, we have already established firm and mutual-benefit business relationships with customers from,Europe,America and south Asia,supplying obsolete and hard-to-find components to meet their specific needs.

With the principle of “Quality Parts,Customers Priority,Honest Operation,and Considerate Service”,our business mainly focus on the distribution of electronic components. Line cards we deal with include Microchip,ALPS,ROHM,Xilinx,Pulse,ON,Everlight and Freescale. Main products comprise IC,Modules,Potentiometer,IC Socket,Relay,Connector.Our parts cover such applications as commercial,industrial, and automotives areas.

We are looking forward to setting up business relationship with you and hope to provide you with the best service and solution. Let us make a better world for our industry!



Contact us

Tel: +86-755-8981 8866 Fax: +86-755-8427 6832

Email & Skype: info@chipsmall.com Web: www.chipsmall.com

Address: A1208, Overseas Decoration Building, #122 Zhenhua RD., Futian, Shenzhen, China



PANDUIT PART NUMBER	I.D.	O.D.	T	QUANTITY
SSFW14-C	1/4" [6mm]	5/8" [16mm]	.07 [1.6mm]	100
SSFW38-C	3/8" [26mm]	7/8" [22mm]	.05 [1.3mm]	100

NOTES:

- 1. PART NUMBERS: SSFW14, SSFW38
- 2. MATERIAL: STAINLESS STEEL
- 3. DIMENSIONS IN PARENTHESIS ARE MILLIMETERS

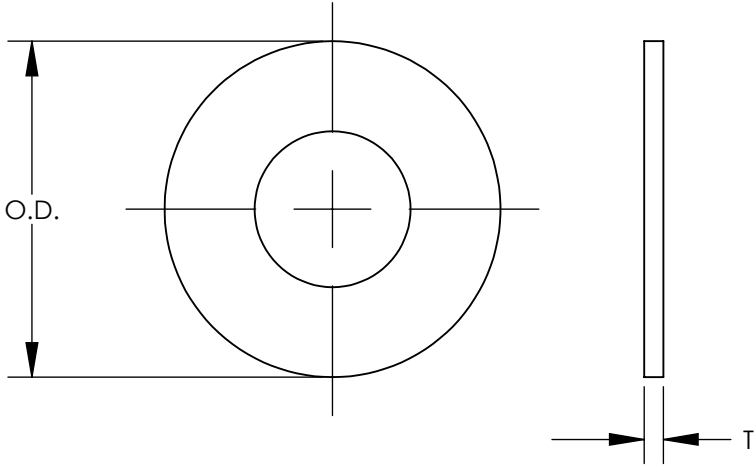

								<div><div>PANDUIT</div><div>CORP. TINLEY PARK, ILLINOIS</div><div>STAINLESS STEEL FLAT WASHER (SSFW14-C, SSFW38-C) CUSTOMER DRAWING</div></div>			
02	12/16	JHNU	JHNU	VOIDED DRAWING, PARTS MOVED TO 15J350BH-DC	N11000BH-C41734	RGB	RGB				
01	5/08	JHNU	JHNU	ADDED I.D. COLUMN TO TABLE							
00	5/08	JHNU	JHNU	DRAWING RELEASED							
REV	DATE	BY	CHK	DESCRIPTION	ECN	-R	SUP	DRAWN BY JHNU	CHK'D	SCALE NONE	DRAWING NO / CAD FILE C41734