



Chipsmall Limited consists of a professional team with an average of over 10 year of expertise in the distribution of electronic components. Based in Hongkong, we have already established firm and mutual-benefit business relationships with customers from,Europe,America and south Asia,supplying obsolete and hard-to-find components to meet their specific needs.

With the principle of "Quality Parts,Customers Priority,Honest Operation,and Considerate Service",our business mainly focus on the distribution of electronic components. Line cards we deal with include Microchip,ALPS,ROHM,Xilinx,Pulse,ON,Everlight and Freescale. Main products comprise IC,Modules,Potentiometer,IC Socket,Relay,Connector.Our parts cover such applications as commercial,industrial, and automotives areas.

We are looking forward to setting up business relationship with you and hope to provide you with the best service and solution. Let us make a better world for our industry!



Contact us

Tel: +86-755-8981 8866 Fax: +86-755-8427 6832

Email & Skype: info@chipsmall.com Web: www.chipsmall.com

Address: A1208, Overseas Decoration Building, #122 Zhenhua RD., Futian, Shenzhen, China



THIS DOCUMENT IS THE PROPERTY OF KEYSTONE ELECTRONICS CORP. AND SHALL NOT BE REPRODUCED, DISTRIBUTED OR USED AS A BASIS FOR MANUFACTURE WITHOUT PRIOR WRITTEN PERMISSION FROM KEYSTONE ELECTRONICS CORP.

| 4-40 THREAD STANDOFF ENGINEERING KIT CAT. NO. STR-440 | | | | |
|--|-----------------|--------------|----------------------|-------------|
| HEX. = .250 [6.35] | Threaded Female | | Threaded Male/Female | |
| | Aluminum | Nylon | Aluminum | Nylon |
| Length | Cat. No. | Cat. No. | Cat. No. | Cat. No. |
| .250 [6.35] | 2201 | 1902A | 8714 | 4800 |
| .500 [12.70] | 2203 | 1902C | 8401 | 4802 |
| .750 [19.05] | 2204 | 1902D | 8403 | 4804 |
| 1.00 [25.40] | 2205 | 1902E | 8405 | 4806 |
| Cat. No. 9900 4-40 x 1/4" Phillips Drive Machine Screw | | | | |

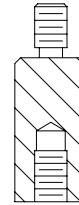
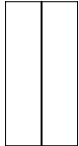

| 6-32 THREAD STANDOFF ENGINEERING KIT CAT. NO. STR-632 | | | | |
|--|-----------------|--------------|----------------------|-------------|
| HEX. = .250 [6.35] | Threaded Female | | Threaded Male/Female | |
| | Aluminum | Nylon | Aluminum | Nylon |
| Length | Cat. No. | Cat. No. | Cat. No. | Cat. No. |
| .250 [6.35] | 2208 | 1903A | 8717 | 4814 |
| .500 [12.70] | 2210 | 1903C | 8414 | 4816 |
| .750 [19.05] | 2211 | 1903D | 8416 | 4818 |
| 1.00 [25.40] | 2212 | 1903E | 8418 | 4820 |
| Cat. No. 9903 6-32 x 1/4" Phillips Drive Machine Screw | | | | |

| 8-32 THREAD STANDOFF ENGINEERING KIT CAT. NO. STR-832 | | | | |
|--|-----------------|--------------|----------------------|-------------|
| HEX. = .250 [6.35] | Threaded Female | | Threaded Male/Female | |
| | Aluminum | Nylon | Aluminum | Nylon |
| Length | Cat. No. | Cat. No. | Cat. No. | Cat. No. |
| .375 [9.53] | 2216 | 1904B | 8426 | 4829 |
| .500 [12.70] | 2217 | 1904C | 8427 | 4830 |
| .750 [19.05] | 2218 | 1904D | 8429 | 4832 |
| 1.00 [25.40] | 2219 | 1904E | 8431 | 4834 |
| Cat. No. 9906 8-32 x 3/8" Phillips Drive Machine Screw | | | | |

NOTES:

1. A KIT HAS 25 PIECES OF EACH CAT.NO. FOR A TOTAL QUANTITY OF 425 PIECES AND IS HOUSED IN A 16 TRAY, LABELED ENCLOSURE.
2. MAT'L - ALUMINUM, CLEAR IRIDITE
MAT'L - NYLON 6/6
3. DRAWS WILL BE ASSEMBLED WITH PLASTIC DIVIDER INSTALLED AND PRODUCT PLACED IN THE FRONT PORTION OF EACH DRAW.
4. SCREWS TO BE PLACED IN THE BACK PORTION OF THE UPPER LEFT MOST DRAW BEHIND THE 1/4" OR 3/8" L. ALUMINUM STANDOFFS.

| | | | |
|--|--|-----------------|------------------------|
| KEYSTONE ELECTRONICS CORP. | | | |
| ASTORIA, N.Y. 11105-2017 | | | |
| PART NAME .250 HEX. STANDOFF HARDWARE KITS | | | |
| MATERIAL AS NOTED | | | |
| FINISH AS NOTED | | DRN BY BOONE | DATE 11.18.05 |
| | | APP'D LN | SCALE - |
| TOLERANCES INCH [MM] DECIMAL ± [±] ANGULAR ± UNLESS OTHERWISE SPECIFIED | | CODE C/M | DWG NO. STR- |

| DATE | DESCRIPTION | REV. |
|------|-------------|------|
| | | |