



Chipsmall Limited consists of a professional team with an average of over 10 year of expertise in the distribution of electronic components. Based in Hongkong, we have already established firm and mutual-benefit business relationships with customers from,Europe,America and south Asia,supplying obsolete and hard-to-find components to meet their specific needs.

With the principle of “Quality Parts,Customers Priority,Honest Operation,and Considerate Service”,our business mainly focus on the distribution of electronic components. Line cards we deal with include Microchip,ALPS,ROHM,Xilinx,Pulse,ON,Everlight and Freescale. Main products comprise IC,Modules,Potentiometer,IC Socket,Relay,Connector.Our parts cover such applications as commercial,industrial, and automotives areas.

We are looking forward to setting up business relationship with you and hope to provide you with the best service and solution. Let us make a better world for our industry!



Contact us

Tel: +86-755-8981 8866 Fax: +86-755-8427 6832

Email & Skype: info@chipsmall.com Web: www.chipsmall.com

Address: A1208, Overseas Decoration Building, #122 Zhenhua RD., Futian, Shenzhen, China



Sample Kit Contents

Part Number	Maximum Operating Voltage (VDC)	Nominal Capacitance		Maximum ESR @ 1 kHz (Ω)	Maximum Current @ 30 Minutes (mA)	Voltage Holding Characteristic Minimum (V)	Weight (g)	Quantity
		Charge System (F)	Discharge System (F)					
FME0H223ZF	5.5	0.022	0.028	40	0.033	—	1.3	10
FME0H473ZF	5.5	0.047	0.06	20	0.071	—	1.3	10
FM0H473ZF	5.5	0.047	0.06	200	0.071	4.2	1.3	10
FM0H104ZF	5.5	0.10	0.13	100	0.15	4.2	1.6	10
FMR0H104ZF	5.5	0.10	—	50	0.15	4.2	1.6	10
FM0H224ZF	5.5	—	0.22	100	0.33	4.2	1.6	10
FM0V224ZF	3.5	0.22	0.30	100	0.20	—	1.6	10
FMC0H334ZF	5.5	—	0.33	25	0.50	4.2	3.5	10

Dimensions – Millimeters

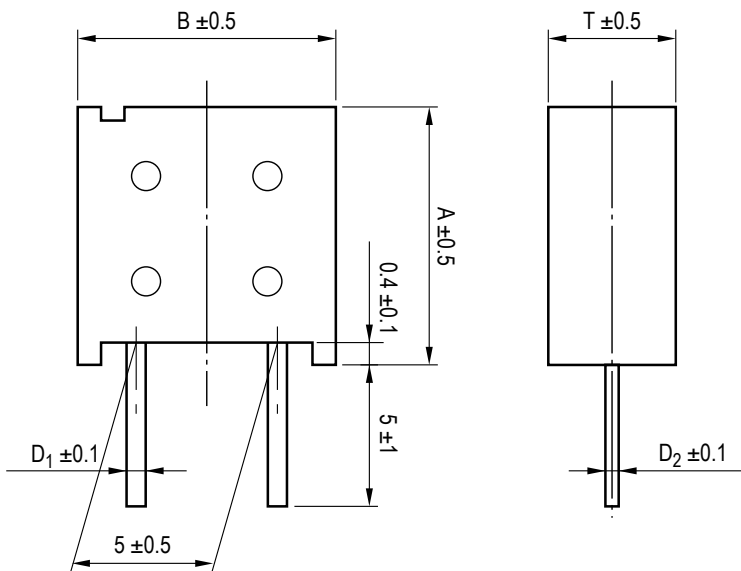

Part Number	A	B	T	D ₁	D ₂
FM0H223ZF	11.5	10.5	5.0	0.5	0.4
FM0H473ZF	11.5	10.5	5.0	0.5	0.4
FME0H473ZF	11.5	10.5	5.0	0.5	0.4
FM0H104ZF	11.5	10.5	6.5	0.5	0.4
FMR0H104ZF	11.5	10.5	6.5	0.5	0.4
FM0H224ZF	11.5	10.5	6.5	0.5	0.4
FM0V224ZF	11.5	10.5	6.5	0.5	0.4
FMC0H334ZF	15.0	14.0	9.0	0.6	0.6

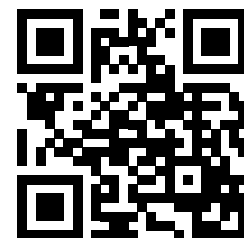

www.kemet.com/fm