



Chipsmall Limited consists of a professional team with an average of over 10 year of expertise in the distribution of electronic components. Based in Hongkong, we have already established firm and mutual-benefit business relationships with customers from,Europe,America and south Asia,supplying obsolete and hard-to-find components to meet their specific needs.

With the principle of “Quality Parts,Customers Priority,Honest Operation,and Considerate Service”,our business mainly focus on the distribution of electronic components. Line cards we deal with include Microchip,ALPS,ROHM,Xilinx,Pulse,ON,Everlight and Freescale. Main products comprise IC,Modules,Potentiometer,IC Socket,Relay,Connector.Our parts cover such applications as commercial,industrial, and automotives areas.

We are looking forward to setting up business relationship with you and hope to provide you with the best service and solution. Let us make a better world for our industry!



Contact us

Tel: +86-755-8981 8866 Fax: +86-755-8427 6832

Email & Skype: info@chipsmall.com Web: www.chipsmall.com

Address: A1208, Overseas Decoration Building, #122 Zhenhua RD., Futian, Shenzhen, China



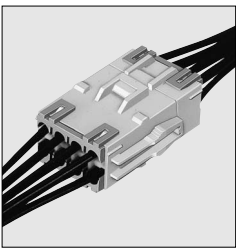

VL CONNECTOR

6.2mm pitch/Disconnectable Crimp style Wire-to-wire connectors

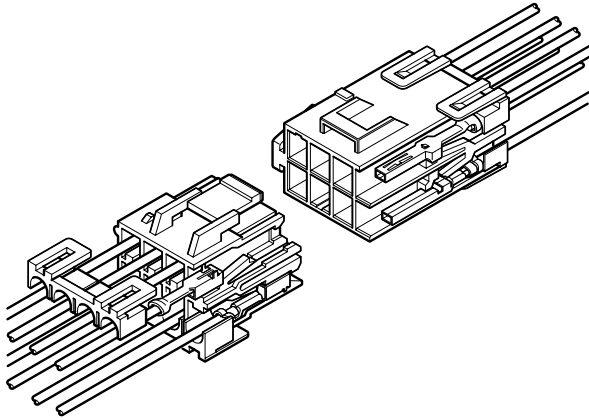

The VL connector is a 6.2mm pitch wire-to-wire connector designed for circuits requiring up to 20A (1 or 2-circuit with AWG #12 wire).

- Housing lances for contact retention
- Secondary retainer
- Suited for circuits with high power requirements
- Panel lock construction

Standards

Recognized E60389

Certified LR20812

R9351103

Specifications

- Current rating: 20A AC, DC max.
- Voltage rating: 600V AC, DC max. (300V in accordance with the Electrical Appliance and Material Safety Law in Japan)
- Temperature range: -25°C to +90°C (including temperature rise in applying electrical current)
- Contact resistance: Initial value/7m Ω max. After environmental testing/10m Ω max.
- Insulation resistance: 1,000M Ω min.
- Withstanding voltage: 2,000V AC/minute
- Applicable wire: AWG #22 to #12 0.3 to 3.5mm²
- Applicable panel thickness: 0.5 to 2.0mm
- * Compliant with RoHS.
- * Refer to "General Instruction and Notice when using Terminals and Connectors" at the end of this catalog.
- * Contact JST for details.

Note: The current rating varies depending on the number of circuits and the wire size used in each connector. The table below lists the current rating as a function of the number of circuits and the wire size.

Current unit: A

Circuits	Wire size (AWG)					
	#12	#14	#16	#18	#20	#22
1	20	15	10	8	6	4
2	20	15	10	8	6	4
3	19	14	9	8	6	4
4	18	13	9	7	6	4
6	16	12	8	7	5	3
8	16	11	7	6	5	3
12	15	10	7	6	4	3

Panel layout and Assembly layout

(2, 3 and single-row 4 circuits)

<Inner-housing lock>

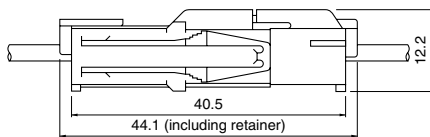

<Outer-housing lock>

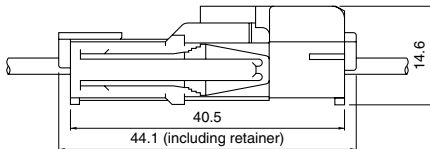

(4, 6, 8 and 12 circuits)

<Inner-housing lock>

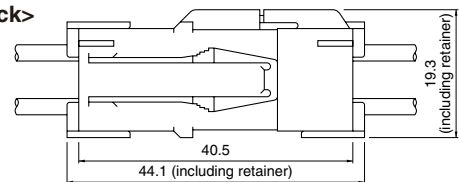

<Outer-housing lock>

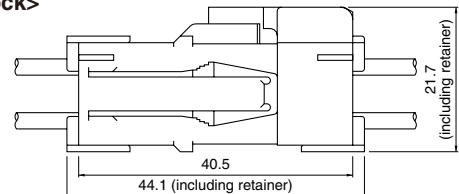

Shape I

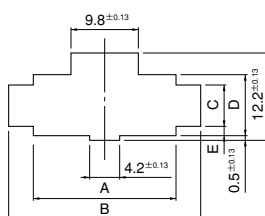

Shape II

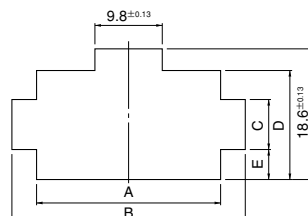

Circuits	Receptacle housing Model No.	Panel hole shape	Panel hole dimensions (mm)					Applicable panel thickness (mm)
			General tolerance A, B, D: ±0.13 C, E: ±0.1					
2	VLR-02V	I	13.8	20.6	5.7	8.5	1.4	0.5~2.0
3	VLR-03V	I	20.0	26.8	5.7	8.5	1.4	
4	VLR-04V	II	13.8	20.6	7.0	15.4	4.2	
4 (Single-row)	VLR-04VN	I	26.2	33.0	5.7	8.5	1.4	
6	VLR-06V	II	20.0	26.8	7.0	15.4	4.2	
8	VLR-08V	II	26.2	33.0	7.0	15.4	4.2	
12	VLR-12V	II	38.9	45.4	7.0	15.4	4.2	

- Note: 1. Punch holes in the panel according to the figures and table shown above. Burrs must be removed.
 2. The strength of the panel must be considered when punching two or more holes.
 3. The connector must be inserted from the same side as the hole is punched.

VL CONNECTOR

Contact

Pin contact

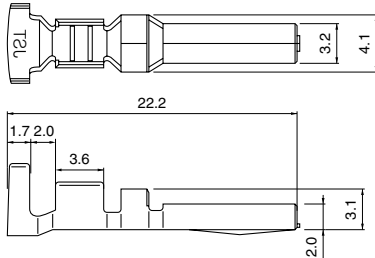

Socket contact

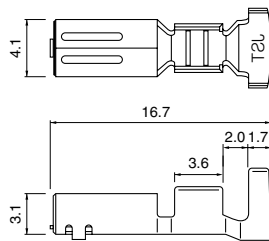

Model No.		Applicable wire		Insulation O.D. (mm)	Q'ty / reel
Pin contact	Socket contact	mm ²	AWG #		
*SVM-42T-P2.0	*SVF-42T-P2.0	0.3~1.25	22~16	1.7~3.2	2,000
		0.3+0.3~ 0.5+0.75	22+22~ 20+18	1.7+1.7~ 2.5+2.7	
SVM-61T-P2.0	SVF-61T-P2.0	0.5~2.0	20~14	1.9~3.4	
		0.5+0.5~ 0.75+1.25	20+20~ 18+16	1.9+1.9~ 2.1+2.7	
SVM-81T-P2.0	SVF-81T-P2.0	3.5	12	4.1	

Material and Finish

Phosphor bronze, tin-plated (reflow treatment)

RoHS compliance

Note: 1. Contact JST for special products.

2. *Marked products are not TÜV approved.

Contact	Crimping machine	Applicator		
		Crimp applicator	Dies	Crimp applicator with dies
SVM-42T-P2.0	AP-K2N	MKS-L	MK/SVF/M-42-20	APLMK SVF/M42-20
SVF-42T-P2.0		—	—	—
SVM-61T-P2.0		MKS-L	MK/SVF/M-61-20	APLMK SVF/M61-20
SVF-61T-P2.0		—	—	—
SVM-81T-P2.0		MKS-L	MK/SVF/M-81-20	APLMK SVF/M81-20
SVF-81T-P2.0		—	—	—

Contact position location numbers

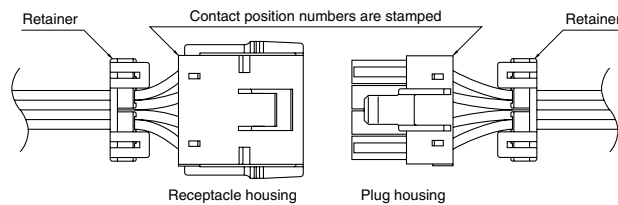

Receptacle housing

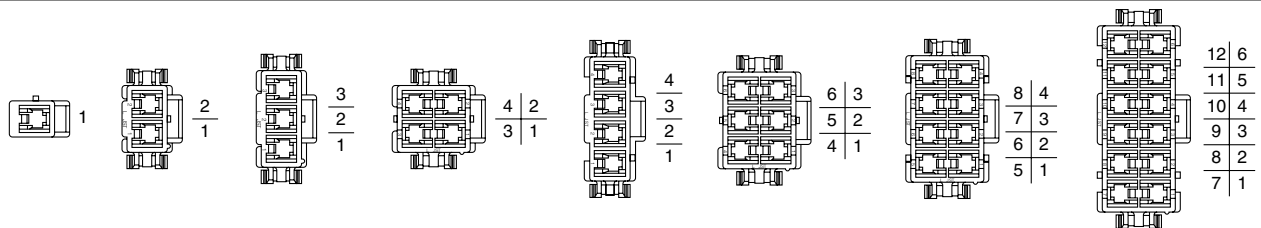

Plug housing

<Inner-housing lock>

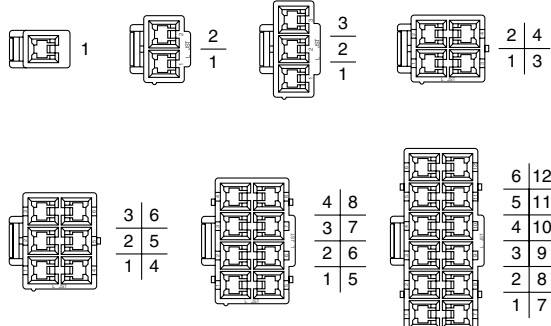

<Outer-housing lock>

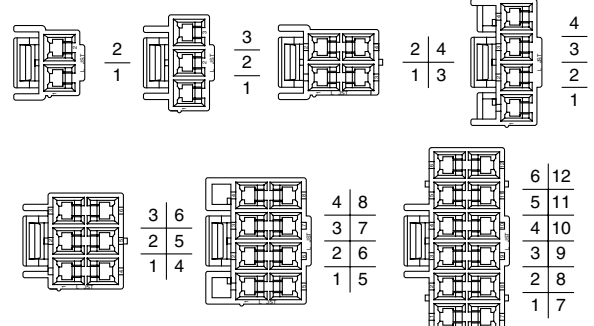

VL CONNECTOR

Housing

Material: Housing...PA 66, UL94V-0, white
Retainer...Glass-filled PA 66, UL94V-0, ivory

Circuits	Voltage rating	Current rating	Receptacle housing(for pin contact)		Plug housing(for socket contact)		Retainer			
1	600V	20A	VLR-01VF (Without panel lock product) 		Q'ty / bag 500	VLP-01V 		Q'ty / bag 500	VLS-01V 	Q'ty / bag 1,000
2	600V	20A	VLR-02V 		Q'ty / bag 500	VLP-02V 		Q'ty / bag 500	VLS-02V (commonly used for 2-circuit housing and 4-circuit housing) 	Q'ty / bag 1,000
			*VLR-02VF (Without panel lock product) 			VLP-02V-1 				
3	600V	19A	VLR-03V 		Q'ty / bag 500	VLP-03V 		Q'ty / bag 500	VLS-03V (commonly used for 3-circuit housing and 6-circuit housing) 	Q'ty / bag 1,000
			*VLR-03VF (Without panel lock product) 			VLP-03V-1 				
4	600V	18A	VLR-04V 		Q'ty / bag 500	VLP-04V 		Q'ty / bag 500	VLS-02V 	Q'ty / bag 1,000
			*VLR-04VF (Without panel lock product) 			VLP-04V-1 				
		VLR-04VN 		Q'ty / bag 500	VLP-04VN-1 		Q'ty / bag 500	VLS-08V (commonly used for 4-circuit housing and 8-circuit housing) 	Q'ty / bag 1,000	

RoHS compliance

Note: 1. Contact JST for special products.

2. *Marked products are not UL/CSA/TÜV approved. (*1 marked product is not only TÜV approved.)

VL CONNECTOR

Housing

Material: Housing...PA 66, UL94V-0, white
Retainer...Glass-filled PA 66, UL94V-0, ivory

Circuits	Voltage rating	Current rating	Receptacle housing(for pin contact)	Plug housing(for socket contact)	Retainer
6	600V	16A	VLR-06V 	VLP-06V 	VLS-03V (commonly used for 3-circuit housing and 6-circuit housing)
				VLP-06V-1 	
8	600V	16A	VLR-08V 	VLP-08V 	VLS-08V (commonly used for 4-circuit housing and 8-circuit housing)
				VLP-08V-1 	
12	600V	15A	VLR-12V 	VLP-12V 	VLS-12V
				VLP-12V-1 	

RoHS compliance

Note: Contact JST for special products.