



Chipsmall Limited consists of a professional team with an average of over 10 year of expertise in the distribution of electronic components. Based in Hongkong, we have already established firm and mutual-benefit business relationships with customers from,Europe,America and south Asia,supplying obsolete and hard-to-find components to meet their specific needs.

With the principle of "Quality Parts,Customers Priority,Honest Operation,and Considerate Service",our business mainly focus on the distribution of electronic components. Line cards we deal with include Microchip,ALPS,ROHM,Xilinx,Pulse,ON,Everlight and Freescale. Main products comprise IC,Modules,Potentiometer,IC Socket,Relay,Connector.Our parts cover such applications as commercial,industrial, and automotives areas.

We are looking forward to setting up business relationship with you and hope to provide you with the best service and solution. Let us make a better world for our industry!



Contact us

Tel: +86-755-8981 8866 Fax: +86-755-8427 6832

Email & Skype: info@chipsmall.com Web: www.chipsmall.com

Address: A1208, Overseas Decoration Building, #122 Zhenhua RD., Futian, Shenzhen, China



PART NUMBER CODING SWR120-NPEG-S--HM-BG

NUMBER OF POSITIONS
(CONTACTS PER ROW)

| REV. | ECO. NO | DESCRIPTION | DATE | BY |
|------|---------|-----------------|-----------|----|
| A | 2002 | INITIAL RELEASE | 7/17/2009 | JH |

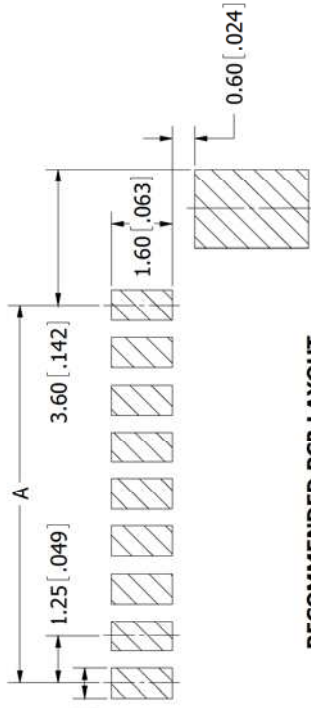
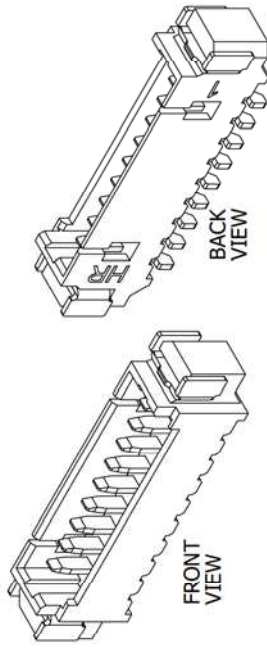

**RECOMMENDED PCB LAYOUT
TOLERANCE: ±0.10[.004]**

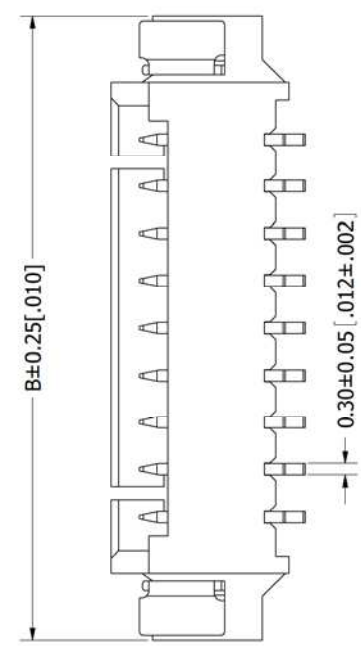
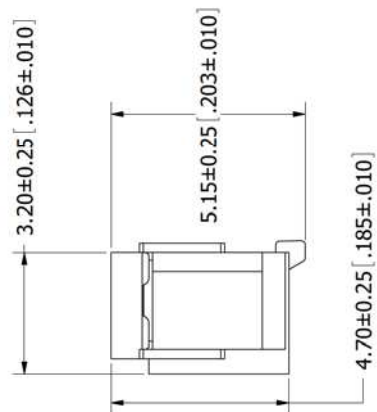
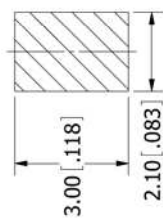
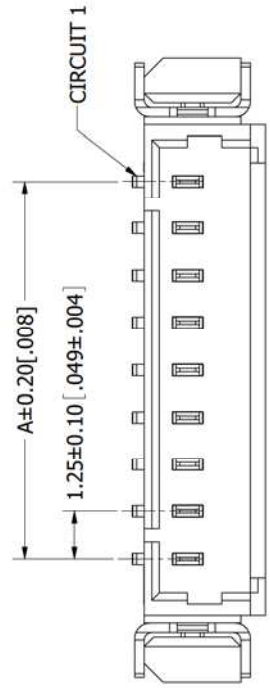

| Part Number | Positions/ Contacts | | A | | B | |
|-----------------------|------------------------|-------|-------|-------|-------|-------|
| | MM | INCH | MM | INCH | MM | INCH |
| SWR120-NPEG-S02-HM-BG | 1.25 | 0.049 | 7.75 | 0.305 | 7.75 | 0.305 |
| SWR120-NPEG-S03-HM-BG | 2.50 | 0.098 | 9.00 | 0.354 | 9.00 | 0.354 |
| SWR120-NPEG-S04-HM-BG | 3.75 | 0.148 | 10.25 | 0.404 | 10.25 | 0.404 |
| SWR120-NPEG-S05-HM-BG | 5.00 | 0.197 | 11.50 | 0.453 | 11.50 | 0.453 |
| SWR120-NPEG-S06-HM-BG | 6.25 | 0.246 | 12.75 | 0.502 | 12.75 | 0.502 |
| SWR120-NPEG-S07-HM-BG | 7.50 | 0.295 | 14.00 | 0.551 | 14.00 | 0.551 |
| SWR120-NPEG-S08-HM-BG | 8.75 | 0.344 | 15.25 | 0.600 | 15.25 | 0.600 |
| SWR120-NPEG-S09-HM-BG | 10.00 | 0.394 | 16.50 | 0.650 | 16.50 | 0.650 |
| SWR120-NPEG-S10-HM-BG | 11.25 | 0.443 | 17.75 | 0.699 | 17.75 | 0.699 |
| SWR120-NPEG-S11-HM-BG | 12.50 | 0.492 | 19.00 | 0.748 | 19.00 | 0.748 |
| SWR120-NPEG-S12-HM-BG | 13.75 | 0.541 | 20.25 | 0.797 | 20.25 | 0.797 |
| SWR120-NPEG-S13-HM-BG | 15.00 | 0.591 | 21.50 | 0.846 | 21.50 | 0.846 |
| SWR120-NPEG-S14-HM-BG | 16.25 | 0.640 | 22.75 | 0.896 | 22.75 | 0.896 |
| SWR120-NPEG-S15-HM-BG | 17.50 | 0.689 | 24.00 | 0.945 | 24.00 | 0.945 |

- NOTES:**
- INSULATOR MATERIAL: NYLON6T, UL94V-0, COLOR:BEIGE.
 - CONTACT MATERIAL: PHOSPHOR BRONZE.
 - CONTACT PLATING: TIN OVERALL.
 - CURRENT RATING: 1 AMP.
 - VOLTAGE RATING: 125V AC/DC.
 - INSULATOR RESISTANCE: 100 MEGOHMS MIN.
 - CONTACT RESISTANCE: 20 MILLIOHMS MAX.
 - DIELECTRIC WITHSTANDING VOLTAGE: 500V AC.
 - OPERATING TEMPERATURE: -25° C TO +85° C.
 - MATES WITH SWH120 SERIES SINGLE ROW HOUSING.



RoHS COMPLIANT

UNLESS OTHERWISE SPECIFIED:
DIMENSIONS ARE IN MM(INCHES)
TOLERANCES:
X = 3 (0.1) ± 5
XX = .15 (0.005)
XXX = .050 (0.002)
XXX = .050 (0.002) Rg
REMOVE ALL BURRS AND SHARP EDGES .010 MAX
INTERPRET DIMENSIONS AND GEOMETRIC
TOLERANCING
PER: ANSI Y14.5M-1994

SULLINS
CONNECTOR SOLUTIONS

DATE: 7/02/2009 NAME: JH

DESCRIPTION: WAFER, 1.25mm CC, 1 ROW, HM

PART NUMBER: SWR120-NPEG-S--HM-BG

SIZE: DWG. NO. 11295

SCALE: 10:1

SHEET 1 OF 1