



Chipsmall Limited consists of a professional team with an average of over 10 year of expertise in the distribution of electronic components. Based in Hongkong, we have already established firm and mutual-benefit business relationships with customers from,Europe,America and south Asia,supplying obsolete and hard-to-find components to meet their specific needs.

With the principle of "Quality Parts,Customers Priority,Honest Operation,and Considerate Service",our business mainly focus on the distribution of electronic components. Line cards we deal with include Microchip,ALPS,ROHM,Xilinx,Pulse,ON,Everlight and Freescale. Main products comprise IC,Modules,Potentiometer,IC Socket,Relay,Connector.Our parts cover such applications as commercial,industrial, and automotives areas.

We are looking forward to setting up business relationship with you and hope to provide you with the best service and solution. Let us make a better world for our industry!



Contact us

Tel: +86-755-8981 8866 Fax: +86-755-8427 6832

Email & Skype: info@chipsmall.com Web: www.chipsmall.com

Address: A1208, Overseas Decoration Building, #122 Zhenhua RD., Futian, Shenzhen, China





SC-1P4-GG



SC-8P1-GT

SC, T SERIES

MACHINED TERMINALS & SOCKETS

SPECIFICATIONS

SC

Contact: BeCu
Shell: Brass
-GG Plating:
 30 μ" (0.76 μm) Au over
 50 μ" (1.27 μm) Ni on contact;
 10 μ" (0.25 μm) Au over
 50 μ" (1.27 μm) Ni on shell
-GT Plating:
 30 μ" (0.76 μm) Au over
 50 μ" (1.27 μm) Ni on contact;
 Sn over 50 μ" (1.27 μm) Ni on shell
-TT Plating:
 Sn over 50 μ" (1.27 μm) Ni on contact; Sn over
 50 μ" (1.27 μm) Ni on shell
-ST Plating:
 10 μ" (0.25 μm) Au over
 50 μ" (1.27 μm) Ni on contact;
 Sn over 50 μ" (1.27 μm) Ni on shell
Lead DIA Accepted:
 (0.38 mm) .015" to
 (0.56 mm) .022" and
 most IC leads

SC-1P1-, SC-6P1-

Part No.	X DIA	X DIA	Z ±.015
SC-1P1-	(0.51) .020	(3.18) .125	(7.62) .300
SC-6P1-	(0.51) .020	(4.57) .180	(8.89) .350

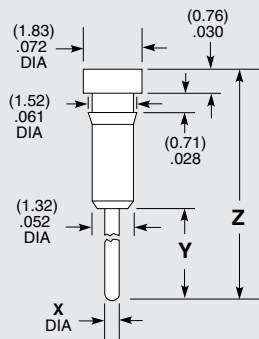

Insertion Depth (SC-1P1, SC-6P1) = (2.41 mm) .95" to (3.68 mm) .145"
 Plating Available (SC-1P1) = GG, GT, TT, ST
 Plating Available (SC-6P1) = GG, GT

SC-8P1

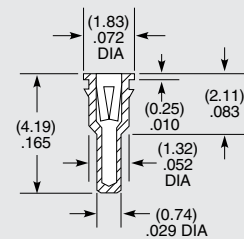

Insertion Depth = (2.16 mm) .085" to .140" (3.56 mm)
 Lead DIA Accepted: (0.41 mm) .016" to (0.51 mm) .020"
 Plating Available = GG, GT, TT

SPECIFICATIONS

SC-1P4

Contact: BeCu
Shell: Brass
-GG Plating:
 20 μ" (0.51 μm) Au over
 50 μ" (1.27 μm) Ni on contact
-GT Plating:
 20 μ" (0.51 μm) Au over
 50 μ" (1.27 μm) Ni on contact
Insertion Force:
 6.5 oz (1.81 N) avg,
 13 oz (3.62 N) max
 (.032" (0.81 mm) DIA probe)
Withdrawal Force:
 3 oz (0.83 N) avg,
 2 oz (0.56 N) min
 (.032" (0.81 mm) DIA probe)

SC-1P4-

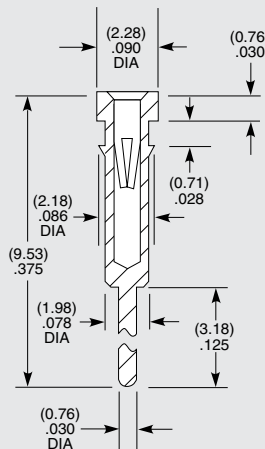

RECOMMENDED PC HOLE SIZE:	
LEAD SIZE	HOLE SIZE
(0.46) .018 DIA	(0.61) .024 DIA
(0.51) .020 DIA	(0.66) .026 DIA
(0.64) .025 DIA	(0.79) .031 DIA
(0.76) .030 DIA	(0.91) .036 DIA
(0.89) .035 DIA	(1.04) .041 DIA
(1.14) .045 DIA	(1.30) .051 DIA
(1.32) .052 DIA	(1.47) .058 DIA
(0.46) .018 SQ	(0.76) .030 DIA
(0.64) .025 SQ	(1.02) .040 DIA
(1.14) .045 SQ	(1.75) .069 DIA
(0.20) .008 x (0.71) .028	(0.89) .035 DIA
(0.25) .010 x (0.51) .020	(0.71) .028 DIA
(0.41) .016 x (0.51) .020	(0.79) .031 DIA
(0.41) .016 x (0.61) .024	(0.89) .035 DIA
(0.41) .016 x (0.79) .031	(1.04) .041 DIA

Insertion Depth = (4.45 mm) .175" to (5.46 mm) .215"
 Lead DIA Accepted = (0.81 mm) .032" to (0.97 mm) .038"
 Plating Available = GG, GT

T-1S6-

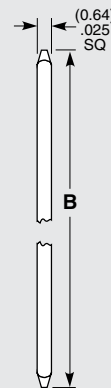

PART NO.	B
T-1S6-07-X-2	(10.92) .430
T-1S6-08-X-2	(13.46) .530
T-1S6-09-X-2	(18.54) .730
T-1S6-10-X-2	(21.08) .830
T-1S6-11-X-2	(23.62) .930
T-1S6-12-X-2	(26.16) 1.030
T-1S6-13-X-2	(31.24) 1.230
T-1S6-14-X-2	(36.32) 1.430
T-1S6-15-X-2	(16.00) .630
T-1S6-16-X-2	(11.30) .445
T-1S6-17-X-2	(12.19) .480
T-1S6-18-X-2	(7.62) .300
T-1S6-19-X-2	(33.78) 1.330
T-1S6-20-X-2	(28.70) 1.130
T-1S6-21-X-2	(8.51) .335

Pins are supplied on a bandolier.

Material: Phosphor Bronze
 X = Plating option (specify G or T)
 -G = 10 μ" (0.25 μm) Gold on (4.19 mm) .165" contact area. Gold flash on balance
 -T = 200 μ" (5.08 μm) Tin

SPECIFICATIONS

T-1S6

T Series is available with a choice of Gold or Tin plating. Add -G or -T as a suffix to the part number shown.

-G Plating:
 Au over 50 μ" (1.27 μm) Ni
-T Plating:
 Sn over 50 μ" (1.27 μm) Ni or 100 μ" (2.54 μm) Cu

Note:
 Some sizes, styles and options are non-standard, non-returnable.

Due to technical progress, all designs, specifications and components are subject to change without notice.

WWW.SAMTEC.COM

All parts within this catalog are built to Samtec's specifications. Customer specific requirements must be approved by Samtec and identified in a Samtec customer-specific drawing to apply.