



Chipsmall Limited consists of a professional team with an average of over 10 year of expertise in the distribution of electronic components. Based in Hongkong, we have already established firm and mutual-benefit business relationships with customers from,Europe,America and south Asia,supplying obsolete and hard-to-find components to meet their specific needs.

With the principle of “Quality Parts,Customers Priority,Honest Operation,and Considerate Service”,our business mainly focus on the distribution of electronic components. Line cards we deal with include Microchip,ALPS,ROHM,Xilinx,Pulse,ON,Everlight and Freescale. Main products comprise IC,Modules,Potentiometer,IC Socket,Relay,Connector.Our parts cover such applications as commercial,industrial, and automotives areas.

We are looking forward to setting up business relationship with you and hope to provide you with the best service and solution. Let us make a better world for our industry!



Contact us

Tel: +86-755-8981 8866 Fax: +86-755-8427 6832

Email & Skype: info@chipsmall.com Web: www.chipsmall.com

Address: A1208, Overseas Decoration Building, #122 Zhenhua RD., Futian, Shenzhen, China



THIS COPY IS PROVIDED ON A RESTRICTED BASIS AND IS NOT TO BE USED IN ANY WAY DETRIMENTAL TO THE INTERESTS OF PANDUIT CORP.

| PANDUIT PART NO. | WEIGHT |
|------------------|-------------------------------------|
| T130DMC | 7.8 LB/100 PCS (3.54 Kg/100 PCS) |

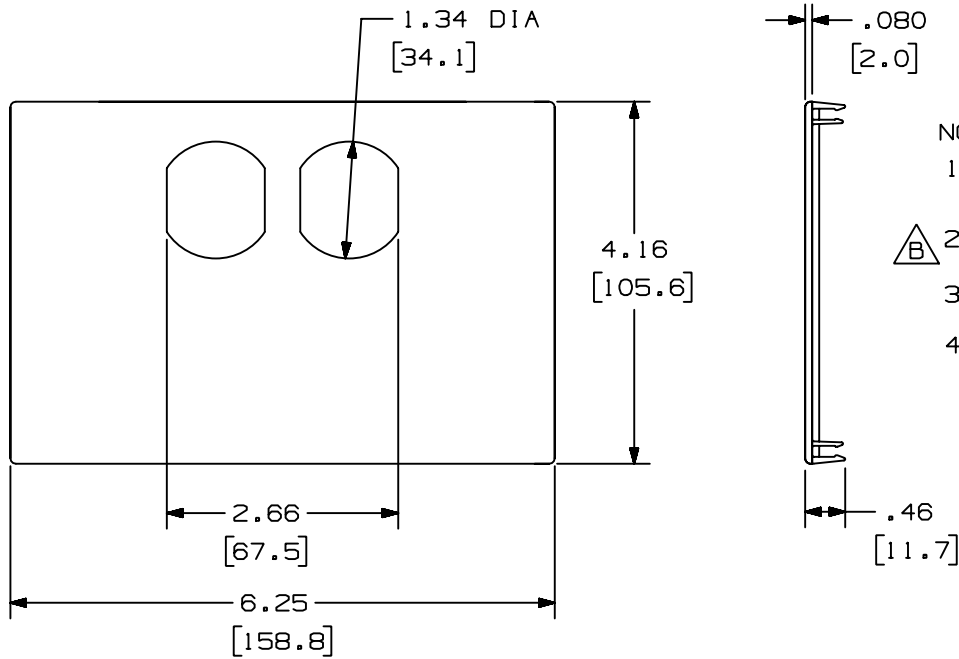

△ A △ C

NOTES:

- SEE CURRENT CATALOG FOR ADDITIONAL PART NUMBER SUFFIXES TO INDICATE COLOR AND OR PACKAGE QUANTITY.
- △ B TO BE USED WITH T130 RACEWAY AND PANDUIT RECEPTACLE BRACKET (T130DB).
- FOR USE WITH STANDARD U.S. DUPLEX RECEPTACLE.
- DIMENSIONS IN PARENTHESES ARE IN METRIC.

CAD FILENAME/LAYERS D34901BE_T130DMC_C_02

| REV | DATE | BY | CHK | DESCRIPTION | ECN | R | CUST | SUP |
|-----|----------|-----|------|---|----------|-----|------|-----|
| 2 | 07-09-99 | DW | HIW | C. REVISED MAT'L AND WEIGHT. | 34901-05 | HIW | HIW | |
| 1 | 03-04-97 | RCA | CEF | B. CHANGED TD130 TO T130 & TD130DB TO T130DB. A. CHANGED WEIGHT & MAT'L FROM ABS(94V-0). | 34901-05 | CEF | CEF | |
| R | 10-04-94 | DW | KRKE | RELEASED TO PRODUCTION. | 34901-05 | CEF | | |

PANDUIT CORP. TINLEY PARK, ILLINOIS
T130 DUPLEX COVER
△ B (T130DMC) CUSTOMER DRAWING

| | |
|---|---|
| UNLESS OTHERWISE SPECIFIED, DIMENSIONAL TOLERANCES ARE: (.X) ± .03(.8)(.XXX) ± .015(.4) (.XX) ± .03(.8) ANGLES ± | UNLESS OTHERWISE SPECIFIED, ALL DIMENSIONS ARE GIVEN IN INCHES, THIRD ANGLE PROJECTION. |
| DRAWN BY DW | MAT'L: PVC |
| DATE 09-29-94 | SCALE NONE |
| CHK'D KRKE | DRAWING NO. 34901-05 |
| △ A △ C | DWG SIZE A |