



Chipsmall Limited consists of a professional team with an average of over 10 year of expertise in the distribution of electronic components. Based in Hongkong, we have already established firm and mutual-benefit business relationships with customers from,Europe,America and south Asia,supplying obsolete and hard-to-find components to meet their specific needs.

With the principle of “Quality Parts,Customers Priority,Honest Operation,and Considerate Service”,our business mainly focus on the distribution of electronic components. Line cards we deal with include Microchip,ALPS,ROHM,Xilinx,Pulse,ON,Everlight and Freescale. Main products comprise IC,Modules,Potentiometer,IC Socket,Relay,Connector.Our parts cover such applications as commercial,industrial, and automotives areas.

We are looking forward to setting up business relationship with you and hope to provide you with the best service and solution. Let us make a better world for our industry!



Contact us

Tel: +86-755-8981 8866 Fax: +86-755-8427 6832

Email & Skype: info@chipsmall.com Web: www.chipsmall.com

Address: A1208, Overseas Decoration Building, #122 Zhenhua RD., Futian, Shenzhen, China



THIS DRAWING IS UNPUBLISHED. RELEASED FOR PUBLICATION 20
 © COPYRIGHT 20 BY - ALL RIGHTS RESERVED.

| REVISIONS | | | | | |
|-----------|-----|-----------------|-----------|-----|------|
| P | LTR | DESCRIPTION | DATE | DWN | APVD |
| A | | INITIAL RELEASE | 16DEC2014 | HMR | CW |
| B | | ECR-15-013292 | 24SEP2015 | DL | CW |
| BI | | ECR-16-011552 | 11AUG2016 | QY | CW |

TYPT-1 / 类型-1

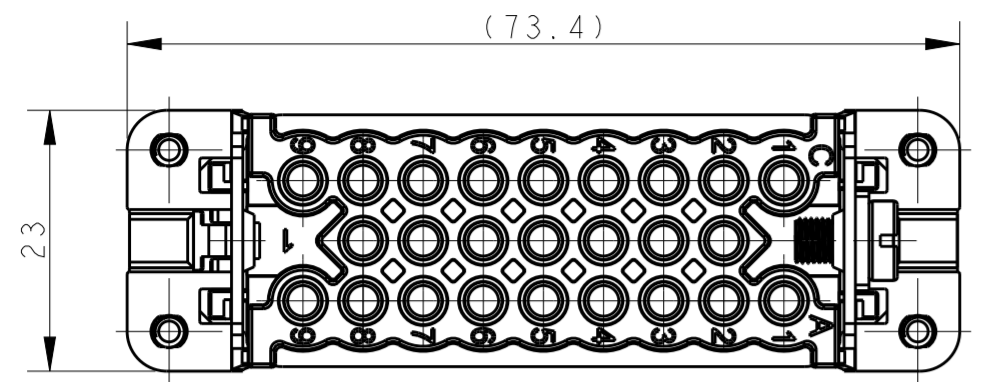

4X M3 SCREW
 RECOMMENDED TIGHTENING TORQUE 0.5Nm
 4X M3螺丝
 推荐锁紧力矩0.5Nm

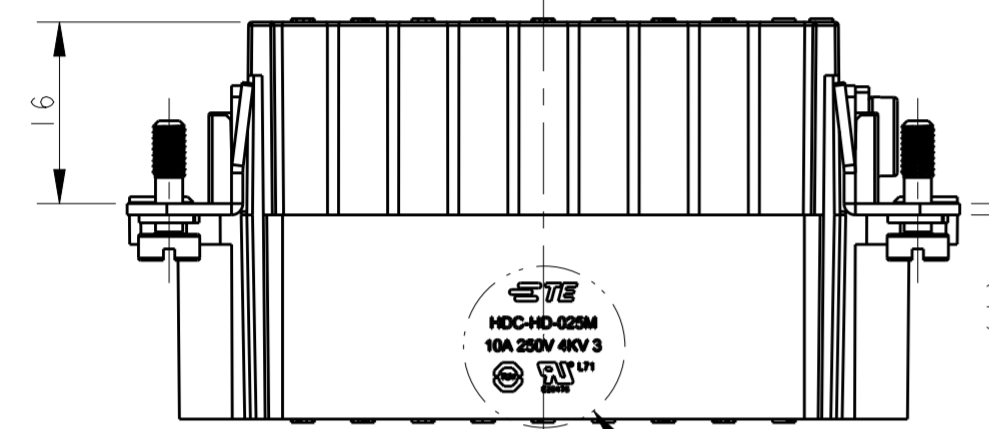

DETAIL C

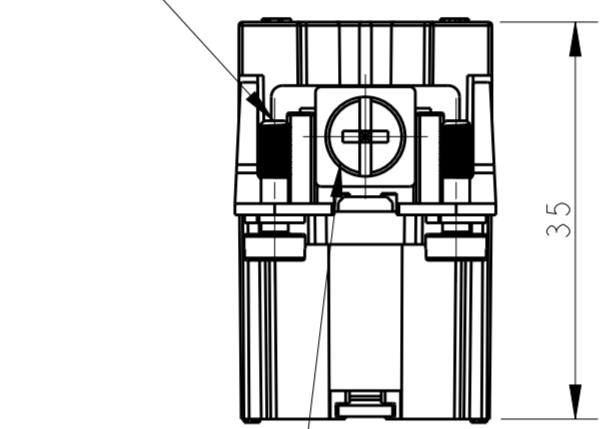

M4 SCREW
 RECOMMENDED TIGHTENING TORQUE 1.2Nm
 M4螺丝
 推荐锁紧力矩1.2Nm

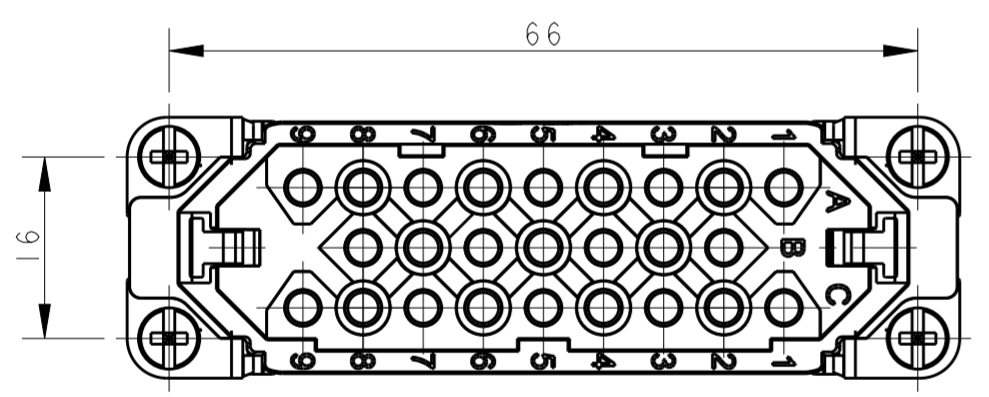

DETAIL C
 SCALE 5:1

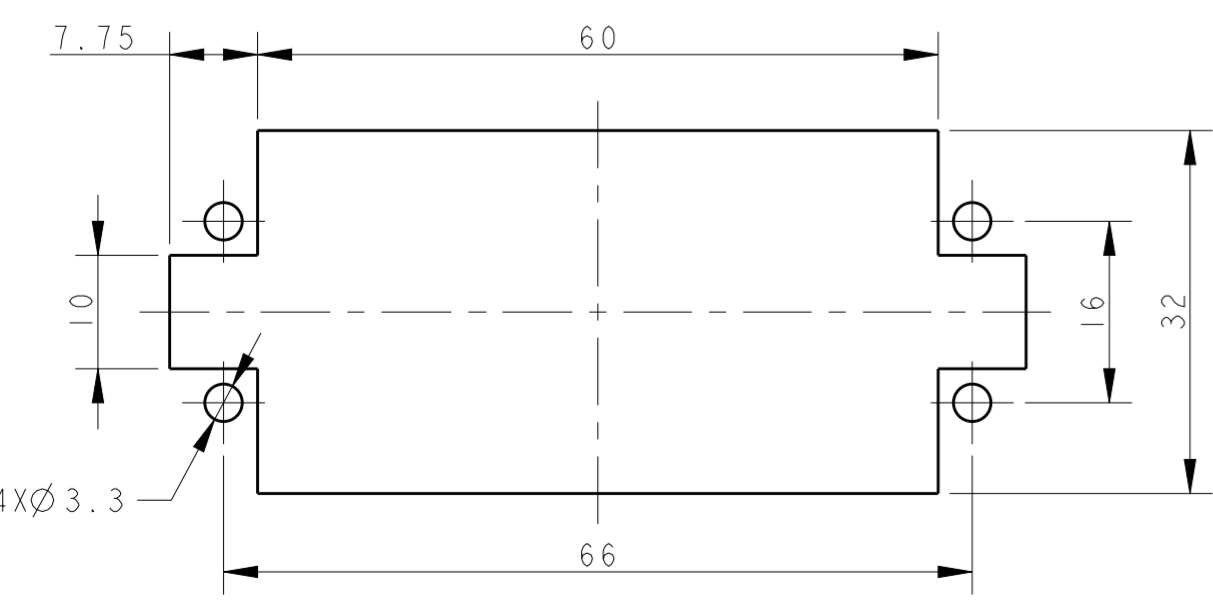

PANEL CUT OUT FOR INSERTS FOR USE WITHOUT HOODS/HOUSINGS

TYPT-2 / 类型-2

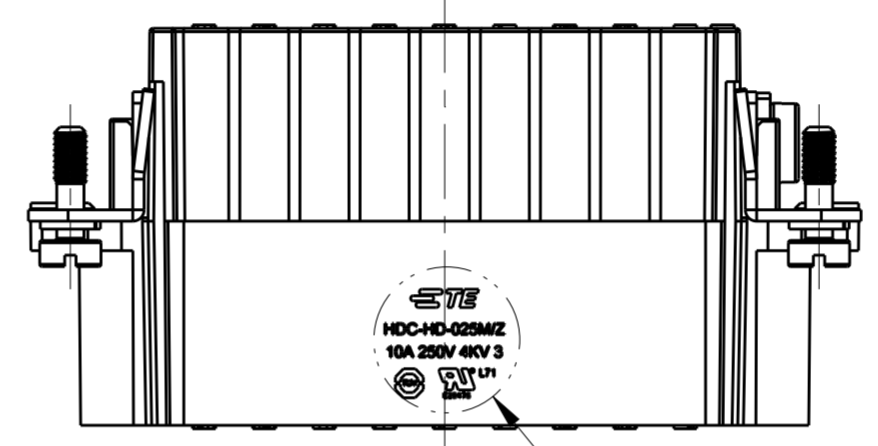
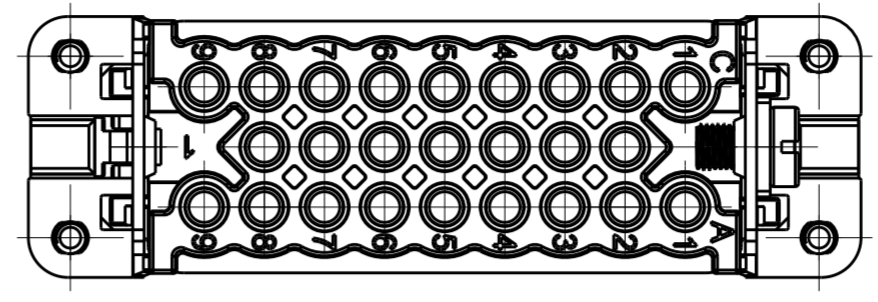

DETAIL A

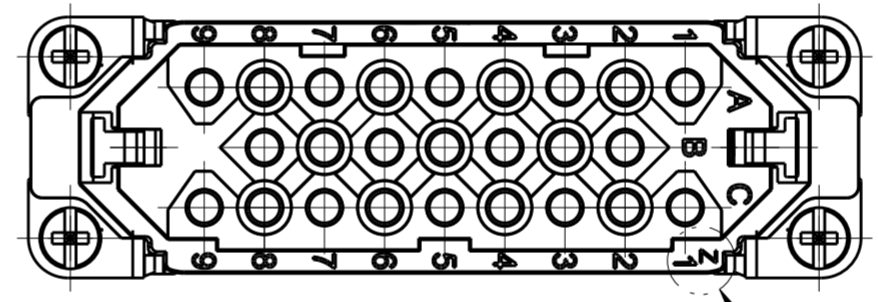

DETAIL B

NOTE: TYPE-2 ALL THE DIMENSIONS ARE THE SAME WITH TYPE-1 EXCEPT THE LASER PRINT MARKINGS
 提示: 类型-2的所有尺寸与类型-1一致, 除了激光打标不一样, 详见视图

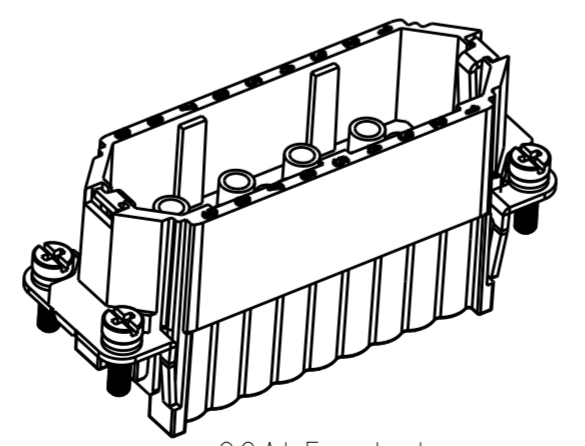

SCALE 1:1

NOTES:
 1. TECHNICAL CHARACTERISTICS:
 INSULATION MATERIAL: PC
 RATED VOLTAGE: 250 V
 RATED CURRENT: 10 A
 INSULATION RESISTANCE: >=400MΩ
 RATED IMPULSE VOLTAGE: 4 KV
 POLLUTION DEGREE: 3
 FLAMMABILITY: UL94V-0
 MATING CYCLES: 500 CYCLES
 WIRE RANGE: 0.14-2.5 mm² (26-14 AWG)
 CONTACT TYPE: CRIMP CONTACT
 2. CONTACT NEED TO BE ORDERED SEPARATELY.
 (ORDER No. REFER TO DRAWING: T20200X10XX000)

注释:
 1. 技术参数:
 绝缘材料: PC
 额定电压: 250V
 额定电流: 10A
 绝缘电阻: >=400MΩ
 额定脉冲电压: 4 KV
 污染等级: 3
 阻燃等级: UL94V-0
 插拔次数: 500次
 接线范围: 0.14-2.5 mm² (26-14 AWG)
 接线类型: 冷压接
 2. 端子需要单独订购。
 (订货号参考图面: T20200X10XX000)

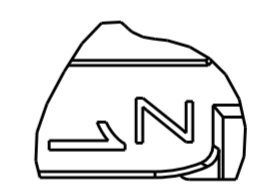

DETAIL B
 SCALE 5:1

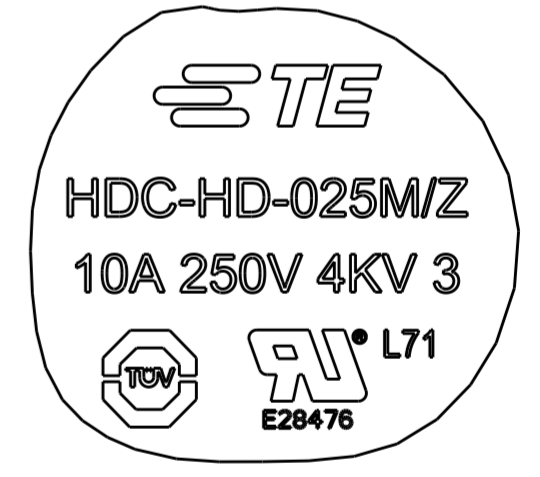

DETAIL A
 SCALE 5:1

| | | | |
|-------------------|------------------------|--------------------------------------|----------------|
| T2020252101-Z00 | HD-025-M/Z | HD-025 MALE INSERT(Z) HD-025公插(Z) | TYPE-2 类型-2 |
| T2020252101-000 | HD-025-M | HD-025 MALE INSERT HD-025公插 | TYPE-1 类型-1 |
| PART NUMBER 料号 | PART DESCRIPTION 描述 | | TYPE 类型 |

| | | | | |
|--|--|-------------------------------------|--------------------------------|--|
| THIS DRAWING IS A CONTROLLED DOCUMENT. | | DWN RAGHAVENDRA H M 16DEC2014 | TE Connectivity | |
| DIMENSIONS: mm | | CHK CHRIS WANG 16DEC2014 | | |
| TOLERANCES UNLESS OTHERWISE SPECIFIED: | | APVD XU XIANG 16DEC2014 | NAME HD-025-M | |
| 0 PLC ± | | PRODUCT SPEC 108-137042 | SIZE A2 | |
| 1 PLC ± | | APPLICATION SPEC 114-137042 | CAGE CODE - | |
| 2 PLC ± | | WEIGHT - | DRAWING NO G-T2020252101000 | |
| 3 PLC ± | | MATERIAL TBD | RESTRICTED TO - | |
| 4 PLC ± | | | SCALE 3:2 SHEET 1 OF 1 REV BI | |
| ANGLES ± | | CUSTOMER DRAWING | | |
| FINISH - | | | | |