



Chipsmall Limited consists of a professional team with an average of over 10 year of expertise in the distribution of electronic components. Based in Hongkong, we have already established firm and mutual-benefit business relationships with customers from,Europe,America and south Asia,supplying obsolete and hard-to-find components to meet their specific needs.

With the principle of “Quality Parts,Customers Priority,Honest Operation,and Considerate Service”,our business mainly focus on the distribution of electronic components. Line cards we deal with include Microchip,ALPS,ROHM,Xilinx,Pulse,ON,Everlight and Freescale. Main products comprise IC,Modules,Potentiometer,IC Socket,Relay,Connector.Our parts cover such applications as commercial,industrial, and automotives areas.

We are looking forward to setting up business relationship with you and hope to provide you with the best service and solution. Let us make a better world for our industry!



Contact us

Tel: +86-755-8981 8866 Fax: +86-755-8427 6832

Email & Skype: info@chipsmall.com Web: www.chipsmall.com

Address: A1208, Overseas Decoration Building, #122 Zhenhua RD., Futian, Shenzhen, China



THIS COPY IS PROVIDED ON A RESTRICTED BASIS AND IS NOT TO BE USED IN ANY WAY DETRIMENTAL TO THE INTERESTS OF PANDUIT CORP.

PANDUIT P/N	WEIGHT
T70CC	.13 LBS/10 PCS (58g/10 PCS)



NOTES:

- SEE CURRENT CATALOG FOR ADDITIONAL PART NUMBER SUFFIXES TO INDICATE COLOR AND OR PACKAGE QUANTITY.
- THE T70CC COUPLING IS USED IN THE JOINING OF T-70 COVER LENGTHS.
- THE T70CC COUPLING IS TO BE USED ON T-70, T-702, AND TG-70 RACEWAY LINES.
- DIMENSIONS IN PARENTHESIS ARE IN METRIC.

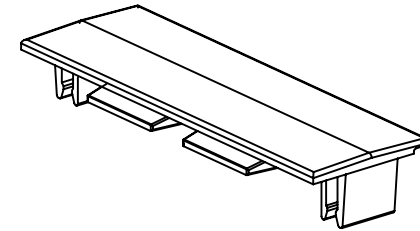
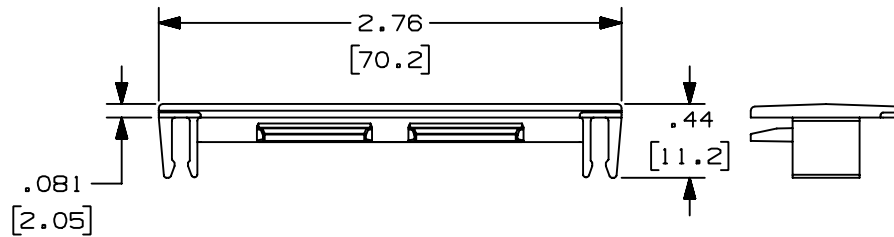

CAD FILENAME/LAYERS D35541BV_T70CC_C_02.PRT

PANDUIT CORP. TINLEY PARK, ILLINOIS
T-70 COUPLER COVER (T70CC)
CUSTOMER DRAWING



UNLESS OTHERWISE SPECIFIED, DIMENSIONAL TOLERANCES ARE:
(.X) ± (.XXX) ±.010(.3)
(.XX) ±.03(.8) ANGLES ±

UNLESS OTHERWISE SPECIFIED, ALL DIMENSIONS ARE GIVEN IN INCHES, THIRD ANGLE PROJECTION.

REV	DATE	BY	CHK	DESCRIPTION	ECN	CHK	CUST	SUP
2	04-14-00	MSO	CAZ	D. ADDED NOTE 3	35541-23	HIW	HIW	
-	-----	---	---	C. 0.13 LB (58g) WAS 0.12 LB (53g)	-----	---	---	
1	01-26-00	MSO	HIW	B. PVC WAS ABS/POLYCARBONATE A. REVISED DRAWING TITLE, T-70 WAS T70	35541-23	HIW	HIW	
R	09-10-96	JBA	CEF	RELEASED TO PRODUCTION	35541-23	CEF	CEF	

DRAWN BY JBA	MAT'L: PVC
DATE 09-10-96	
CHECKED BY CEF	



SCALE NONE	DWG A
DRAWING NO. 35541-23	SIZE