



Chipsmall Limited consists of a professional team with an average of over 10 year of expertise in the distribution of electronic components. Based in Hongkong, we have already established firm and mutual-benefit business relationships with customers from,Europe,America and south Asia,supplying obsolete and hard-to-find components to meet their specific needs.

With the principle of “Quality Parts,Customers Priority,Honest Operation,and Considerate Service”,our business mainly focus on the distribution of electronic components. Line cards we deal with include Microchip,ALPS,ROHM,Xilinx,Pulse,ON,Everlight and Freescale. Main products comprise IC,Modules,Potentiometer,IC Socket,Relay,Connector.Our parts cover such applications as commercial,industrial, and automotives areas.

We are looking forward to setting up business relationship with you and hope to provide you with the best service and solution. Let us make a better world for our industry!



Contact us

Tel: +86-755-8981 8866 Fax: +86-755-8427 6832

Email & Skype: info@chipsmall.com Web: www.chipsmall.com

Address: A1208, Overseas Decoration Building, #122 Zhenhua RD., Futian, Shenzhen, China



THIS COPY IS PROVIDED ON A RESTRICTED BASIS AND IS NOT TO BE USED IN ANY WAY DETRIMENTAL TO THE INTERESTS OF PANDUIT CORP.

PANDUIT P/N	WEIGHT
T70FH2	.77 LB/10 PCS (350 g/10 PCS)

NOTES:

- SEE CURRENT CATALOG FOR ADDITIONAL PART SUFFIXES TO INDICATE COLOR AND OR PACKAGE QUANTITY.
- THE T70FH2 ACCEPTS TWO MINI-COM MODULES.
- DIMENSIONS IN PARENTHESES ARE IN METRIC.
- △ THE T70FH2 FACEPLATE CAN BE USED WITH PANDUIT SURFACE RACEWAY SYSTEMS AND BOXES THAT ACCEPT 70mm SNAP-ON FACEPLATES (INCLUDES: T-70, TWIN-70, TE70, TG-70, ETC.)
- △ POCKETS TO BE USED WITH PANDUIT PART NUMBER CIP***-C AND CID***-C

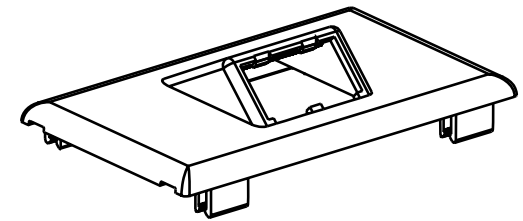
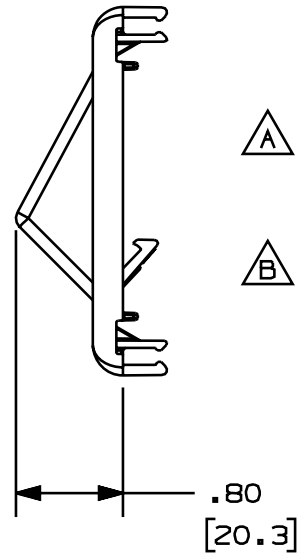
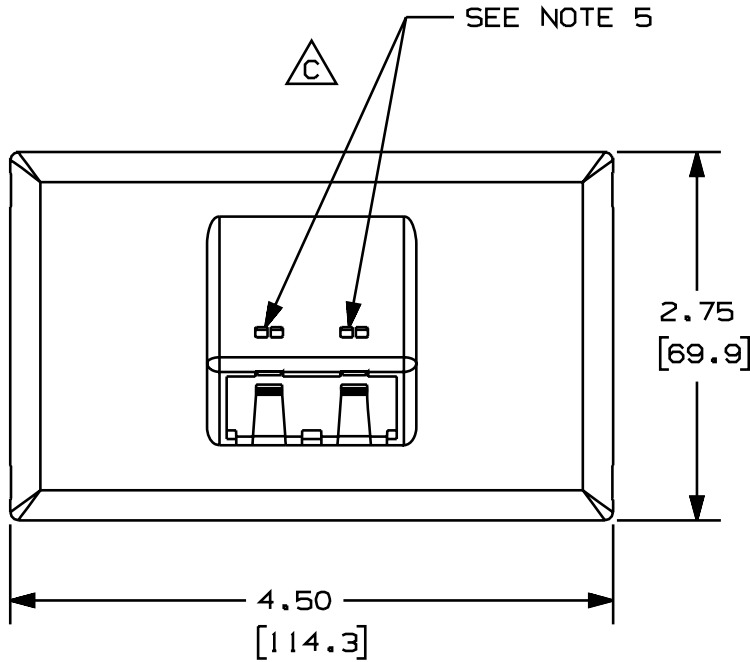

CAD FILENAME/LAYERS D37245BG_DC_T70PBH1_00C

PANDUIT CORP. TINLEY PARK, ILLINOIS

TWO MINI-COM MODULE HORIZONTAL SLOPED SNAP-ON FACEPLATE (T70FH2) CUSTOMER DRAWING

UNLESS OTHERWISE SPECIFIED, DIMENSIONAL TOLERANCES ARE:
 (.X) ± (.XXX) :
 (.XX) ± .03 (.8) ANGLES :

UNLESS OTHERWISE SPECIFIED, ALL DIMENSIONS ARE GIVEN IN INCHES, THIRD ANGLE PROJECTION.

REV	DATE	BY	CHK	DESCRIPTION	ECN	R	CUST	SUP
2	4/18/00	REWE	HIW	C. REVISED GEOMETRY TO INCLUDE ICON POCKETS B. ADDED NOTE 5	37245-08	HIW	HIW	
1	3/2/00	JHNU	HIW	A. ADDED NOTE 4	37245-08	HIW	HIW	
R	9/7/99	DW	CEO	RELEASED TO PRODUCTION.	37245-08	HIW	HIW	

DRAWN BY DW
 DATE 8/12/99
 CHK'D HIW

MAT'L: PVC

SCALE NONE
 DRAWING NO. 37245-08
 DRG SIZE A