



Chipsmall Limited consists of a professional team with an average of over 10 year of expertise in the distribution of electronic components. Based in Hongkong, we have already established firm and mutual-benefit business relationships with customers from,Europe,America and south Asia,supplying obsolete and hard-to-find components to meet their specific needs.

With the principle of “Quality Parts,Customers Priority,Honest Operation,and Considerate Service”,our business mainly focus on the distribution of electronic components. Line cards we deal with include Microchip,ALPS,ROHM,Xilinx,Pulse,ON,Everlight and Freescale. Main products comprise IC,Modules,Potentiometer,IC Socket,Relay,Connector.Our parts cover such applications as commercial,industrial, and automotives areas.

We are looking forward to setting up business relationship with you and hope to provide you with the best service and solution. Let us make a better world for our industry!



Contact us

Tel: +86-755-8981 8866 Fax: +86-755-8427 6832

Email & Skype: info@chipsmall.com Web: www.chipsmall.com

Address: A1208, Overseas Decoration Building, #122 Zhenhua RD., Futian, Shenzhen, China



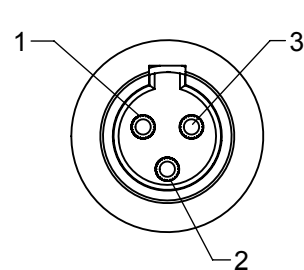

**TA3MS SERIES
3 PIN**

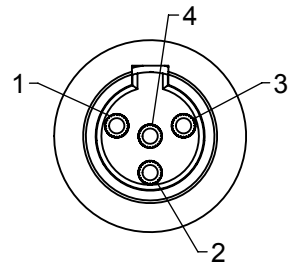

**TA4MS SERIES
4 PIN**

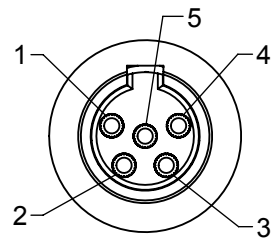

**TA5MS SERIES
5 PIN**

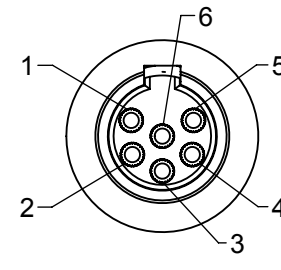

**TA6MS SERIES
6 PIN**

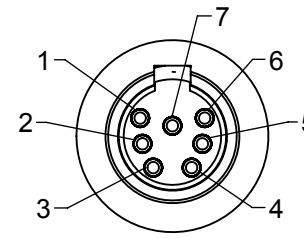

**TA7MS SERIES
7 PIN**

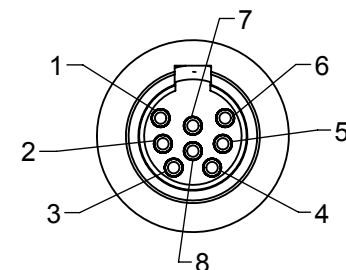

**TA8MS SERIES
8 PIN**

AS VIEWED FROM FRONT MATING VIEW

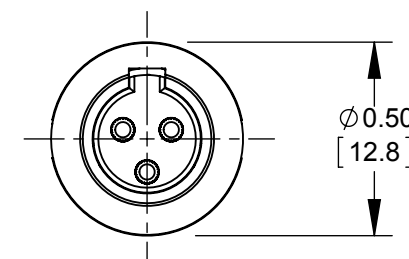
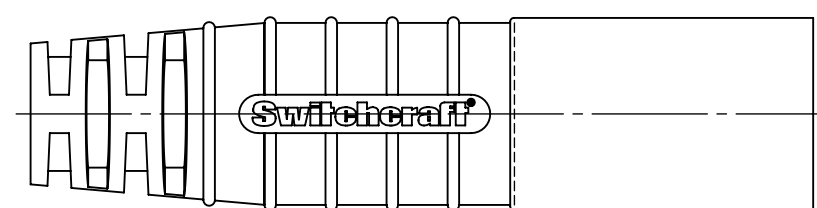
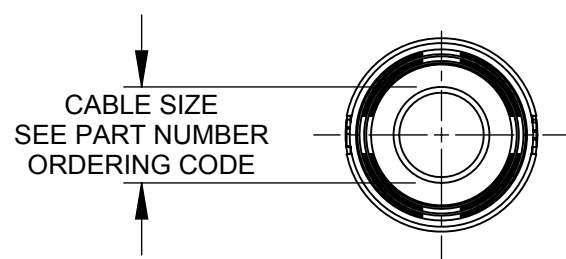
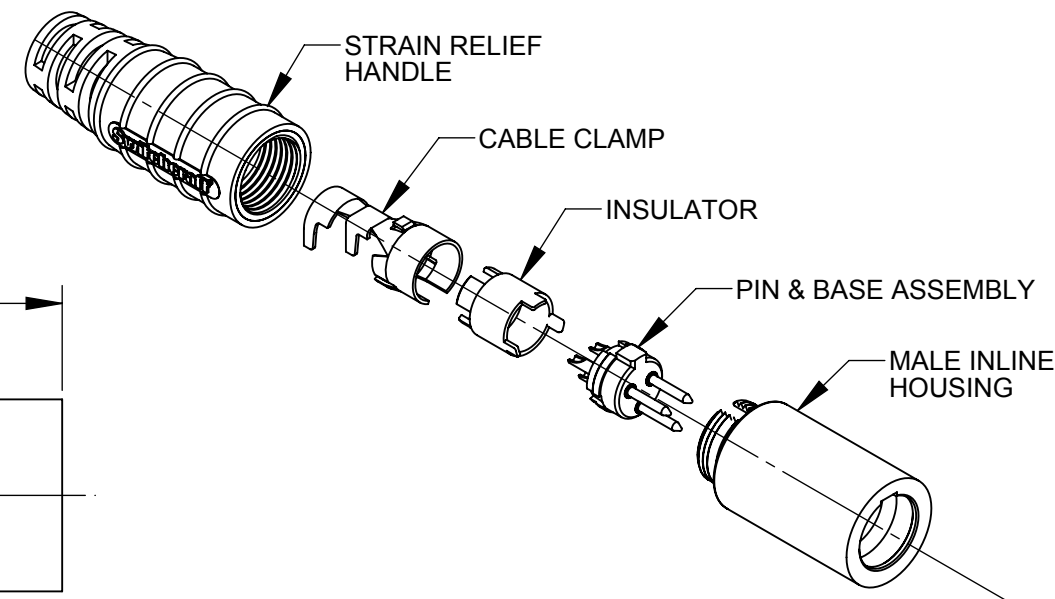
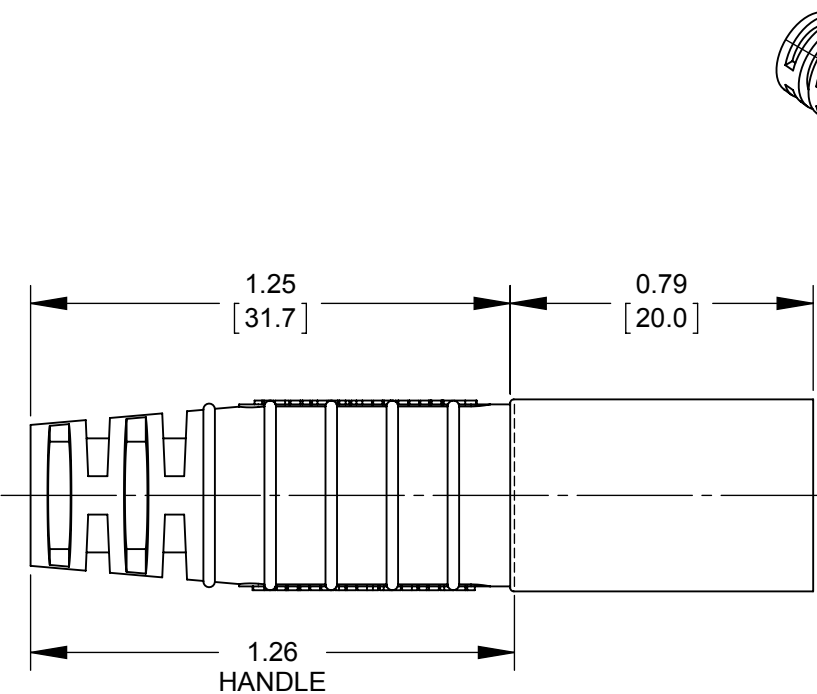
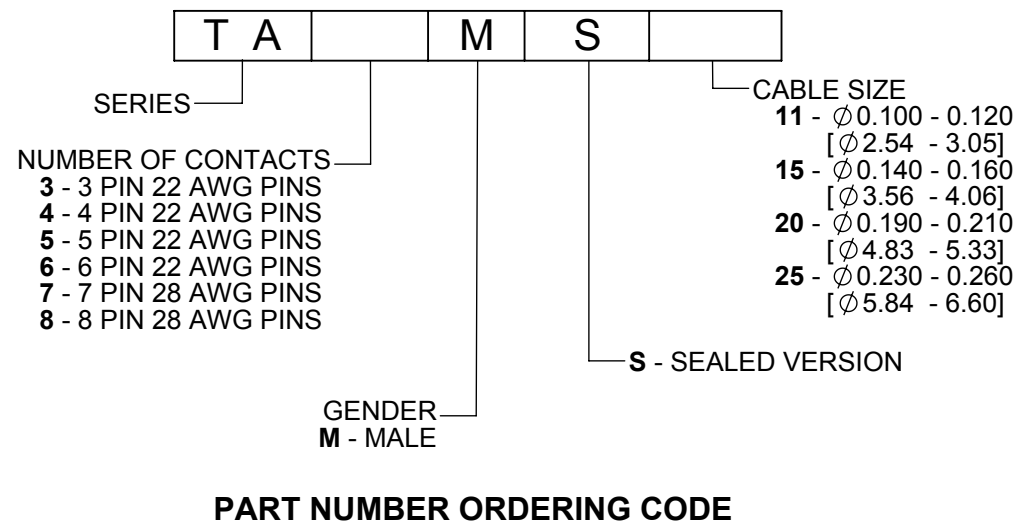

CUSTOMER DRAWING

NOTES:

- MATERIALS:**
HOUSING - COPPER ALLOY, NICKEL-PLATED
PIN CONTACTS - COPPER ALLOY, SILVER PLATED
PIN INSULATOR - RIGID DARK BROWN THERMOPLASTIC
CABLE CLAMP - STEEL, TIN PLATED
BUTTON BOOT - BLACK THERMOPLASTIC RUBBER
INSERT MOLDED HANDLE - THERMOPLASTIC RUBBER OVER RIGID THERMOPLASTIC, BLACK
- THIS PRODUCT IS RoHS COMPLIANT.

					UNLESS OTHERWISE SPECIFIED					THIS DRAWING DESCRIBES A DESIGN CONSIDERED PROPRIETARY IN NATURE, DEVELOPED AND MANUFACTURED BY SWITCHCRAFT INC. AND IS RELEASED ON A CONFIDENTIAL BASIS FOR IDENTIFICATION PURPOSES ONLY.									
					1. ALL DIMENSIONS IN INCHES [mm] - TWO PLACE DECIMALS ±0.02 [0.5] - THREE PLACE DECIMALS ±0.005 [0.13]					SIZE		WIDTH		MULT		LBS/M		TEMPER	
					DO NOT SCALE DRAWING					FINISH				MATERIAL					
										SPEC No.				SPEC No.					
										FIRST USED ON				SCALE					
										DATE DRAWN				APVD					
										1/29/13				TJK					
										BY				CHKD					
										AB				AB					
														1/29/13					
														9-28-15					
										NAME				PART No.					
										SEALED TINI Q-G				TA_MS SERIES					
										MALE, RoHS				REV					
														B					