



Chipsmall Limited consists of a professional team with an average of over 10 year of expertise in the distribution of electronic components. Based in Hongkong, we have already established firm and mutual-benefit business relationships with customers from,Europe,America and south Asia,supplying obsolete and hard-to-find components to meet their specific needs.

With the principle of “Quality Parts,Customers Priority,Honest Operation,and Considerate Service”,our business mainly focus on the distribution of electronic components. Line cards we deal with include Microchip,ALPS,ROHM,Xilinx,Pulse,ON,Everlight and Freescale. Main products comprise IC,Modules,Potentiometer,IC Socket,Relay,Connector.Our parts cover such applications as commercial,industrial, and automotives areas.

We are looking forward to setting up business relationship with you and hope to provide you with the best service and solution. Let us make a better world for our industry!



Contact us

Tel: +86-755-8981 8866 Fax: +86-755-8427 6832

Email & Skype: info@chipsmall.com Web: www.chipsmall.com

Address: A1208, Overseas Decoration Building, #122 Zhenhua RD., Futian, Shenzhen, China



SIZE	A	B	C	D	E	F	G	H	J	K	PART NO.
9	1.209 [30.71]	.984 [24.99]	.668 [16.97]	.500 [12.70]	.592 [15.04]	.749 [19.02]	.314 [7.98]	.455 [11.56]	.380 [9.65]	.187 [4.75]	702 02 09 010
15	1.536 [39.01]	1.312 [33.32]	.995 [25.27]	.500 [12.70]	.918 [23.32]	.749 [19.02]	.314 [7.98]	.455 [11.56]	.380 [9.65]	.187 [4.75]	702 02 15 010
25	2.079 [52.81]	1.832 [47.04]	1.535 [38.99]	.500 [12.70]	1.462 [37.13]	.749 [19.02]	.314 [7.98]	.455 [11.56]	.380 [9.65]	.187 [4.75]	702 02 25 010
37	2.724 [69.19]	2.500 [63.50]	2.183 [55.45]	.500 [12.70]	2.114 [53.70]	.749 [19.02]	.314 [7.98]	.455 [11.56]	.380 [9.65]	.187 [4.75]	702 02 37 010

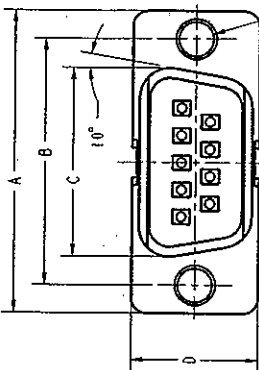

LESS BUSHINGS
2X ϕ 0.136 (3.45)
L ϕ 0.160 (4.06)

ENGAGING SIDE

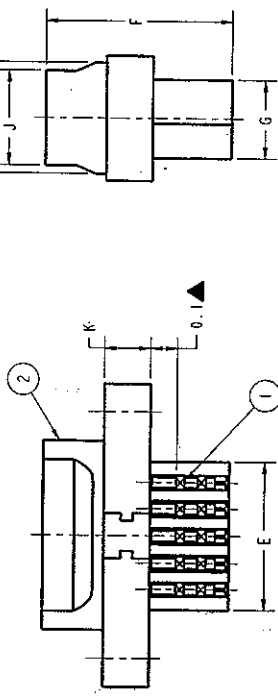

- NOTES:
- UNLESS OTHERWISE SPECIFIED, ALL DIMENSIONS ARE REFERENCE ONLY.
 - RECOMMEND THE USE OF 2 SCREWS 465 13 06 104 (M3) OR 460 18 45 106 (4-40) ON ALL CABLE TO CABLE SCREW MOUNT APPLICATIONS. THESE SCREWS TO BE USED ON BACK SIDE OF MOUNTING FLANGE TO INSURE RETENTION OF BUSHING.
 - INK MARK PER EM-9 THE "CINCH" LOGO PER EM-40, CINCH CATALOG NUMBER PER BOM AND "RoHS" AND DATE CODE PER EM-4-4, 1/16 HIGH CHARACTERS. METHOD 19 OF EM-9 IS PREFERRED METHOD.
 - SMALLEST UNIT PACKAGE MUST BE MARKED PER EM-25 FIGURE 1, PARAGRAPH 7 AND FIGURE 3.
 - RoHS NON COMPLIANT PART NO.'S.: 232 33 09 000, 232 33 15 000, 232 33 25 000 AND 232 33 37 000.

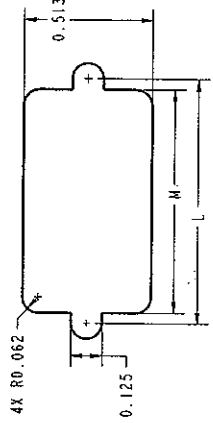

RECOMMENDED PANEL CUT-OUT

SIZE	L	M
9	.984 [24.99]	.900 [22.86]
15	1.312 [33.32]	1.202 [30.53]
25	1.832 [47.04]	1.743 [44.27]
37	2.500 [63.50]	2.391 [60.73]

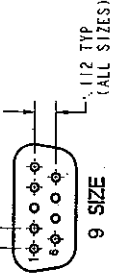
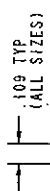

CONTACT ARRANGEMENT - AS VIEWED FROM ENGAGING SIDE

DRAWING REVISIONS

REV	DOCUMENT	APP	DATE
A	DO 06-1033	APB	6-15-00

ROHS COMPLIANT

ENGLISH INCHES		PRO/VE	
DO NOT SCALE DRAWING	UNLESS OTHERWISE SPECIFIED, ALL DIMENSIONS ARE IN INCHES (1"=25.4MM)	DESIGN BY	JIMENEZ
UNLESS OTHERWISE SPECIFIED, ALL DIMENSIONS ARE IN INCHES (1"=25.4MM)	UNLESS OTHERWISE SPECIFIED, ALL DIMENSIONS ARE IN INCHES (1"=25.4MM)	DATE	1/27/06
UNLESS OTHERWISE SPECIFIED, ALL DIMENSIONS ARE IN INCHES (1"=25.4MM)	UNLESS OTHERWISE SPECIFIED, ALL DIMENSIONS ARE IN INCHES (1"=25.4MM)	DESIGN ENGINEER	A. BALLI
UNLESS OTHERWISE SPECIFIED, ALL DIMENSIONS ARE IN INCHES (1"=25.4MM)	UNLESS OTHERWISE SPECIFIED, ALL DIMENSIONS ARE IN INCHES (1"=25.4MM)	DATE	1/27/06
UNLESS OTHERWISE SPECIFIED, ALL DIMENSIONS ARE IN INCHES (1"=25.4MM)	UNLESS OTHERWISE SPECIFIED, ALL DIMENSIONS ARE IN INCHES (1"=25.4MM)	DESIGN ENGINEERING MGR.	A. BALLI
UNLESS OTHERWISE SPECIFIED, ALL DIMENSIONS ARE IN INCHES (1"=25.4MM)	UNLESS OTHERWISE SPECIFIED, ALL DIMENSIONS ARE IN INCHES (1"=25.4MM)	DATE	5/23/06
UNLESS OTHERWISE SPECIFIED, ALL DIMENSIONS ARE IN INCHES (1"=25.4MM)	UNLESS OTHERWISE SPECIFIED, ALL DIMENSIONS ARE IN INCHES (1"=25.4MM)	DESIGN ENGINEER	M. CRUZ
UNLESS OTHERWISE SPECIFIED, ALL DIMENSIONS ARE IN INCHES (1"=25.4MM)	UNLESS OTHERWISE SPECIFIED, ALL DIMENSIONS ARE IN INCHES (1"=25.4MM)	DATE	5/22/06
UNLESS OTHERWISE SPECIFIED, ALL DIMENSIONS ARE IN INCHES (1"=25.4MM)	UNLESS OTHERWISE SPECIFIED, ALL DIMENSIONS ARE IN INCHES (1"=25.4MM)	DESIGN ENGINEERING MGR.	R. QUIROZ
UNLESS OTHERWISE SPECIFIED, ALL DIMENSIONS ARE IN INCHES (1"=25.4MM)	UNLESS OTHERWISE SPECIFIED, ALL DIMENSIONS ARE IN INCHES (1"=25.4MM)	DATE	5/22/06

Cinch

D-SUB ALL PLASTIC IDC T-SERIES
PLUG ASSEMBLY

CONTROL SPEC NUMBER

FACTORY NUMBER

C14690-6

702 02 09 010

2:1 SHEET 1 OF 2