



Chipsmall Limited consists of a professional team with an average of over 10 year of expertise in the distribution of electronic components. Based in Hongkong, we have already established firm and mutual-benefit business relationships with customers from,Europe,America and south Asia,supplying obsolete and hard-to-find components to meet their specific needs.

With the principle of “Quality Parts,Customers Priority,Honest Operation,and Considerate Service”,our business mainly focus on the distribution of electronic components. Line cards we deal with include Microchip,ALPS,ROHM,Xilinx,Pulse,ON,Everlight and Freescale. Main products comprise IC,Modules,Potentiometer,IC Socket,Relay,Connector.Our parts cover such applications as commercial,industrial, and automotives areas.

We are looking forward to setting up business relationship with you and hope to provide you with the best service and solution. Let us make a better world for our industry!



Contact us

Tel: +86-755-8981 8866 Fax: +86-755-8427 6832

Email & Skype: info@chipsmall.com Web: www.chipsmall.com

Address: A1208, Overseas Decoration Building, #122 Zhenhua RD., Futian, Shenzhen, China



DRAWING REVISIONS			
REV	DOCUMENT	APP	DATE
A	DO 06-1033	AKC	6-15-06

SIZE	A	B	C	D	E	F	G	H	J	K	PART NO.
9	1.209	.984	.642	.500	.313	.592	.749	.314	.360	.187	702 12 09 010
15	1.536	1.312	.970	.500	.313	.918	.749	.314	.360	.187	702 12 15 010
25	2.079	1.852	1.510	.500	.313	1.462	.749	.314	.360	.187	702 12 25 010
37	2.724	2.500	2.158	.500	.313	2.114	.749	.314	.360	.187	702 12 37 010

- NOTES:
- UNLESS OTHERWISE SPECIFIED, ALL DIMENSIONS ARE REFERENCE ONLY.
 - SMALLEST UNIT PACKAGE MUST BE MARKED PER EM-25 FIGURE 1, PARAGRAPH 7 AND FIGURE 3.
 - INK MARK PER EM-9 THE "CINCH" LOGO PER EM-40, CINCH CATALOG NUMBER PER BOX AND "RoHS" AND DATE CODE PER EM-4-4, 1716 HIGH CHARACTERS. METHOD 19 OF EM-9 IS PREFERRED METHOD.
 - PARTS TO BE BULK PACKED 1000 PCS PER PACKAGE
 - RoHS NON COMPLIANT PART NO.'S.: 232 34 09 000, 232 34 15 000, 232 34 25 000 AND 232 34 37 000.

THRU HOLE
2X Ø0.138
Ø0.160

ENGAGING SIDE

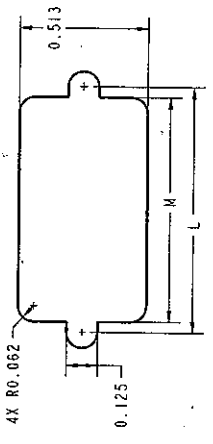
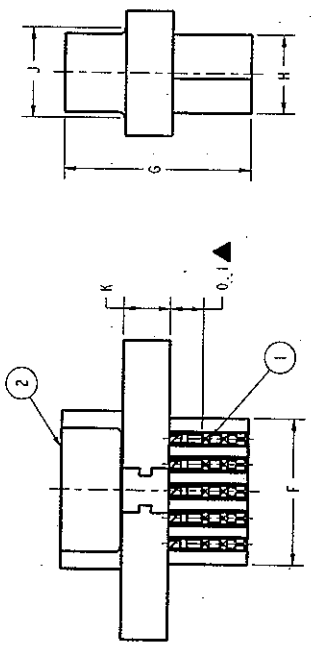

RECOMMENDED PANEL CUT-OUT

SIZE	L	M	H
9	.984	.900	1.202
15	1.312	1.202	1.743
25	1.852	1.743	2.391
37	2.500	2.391	

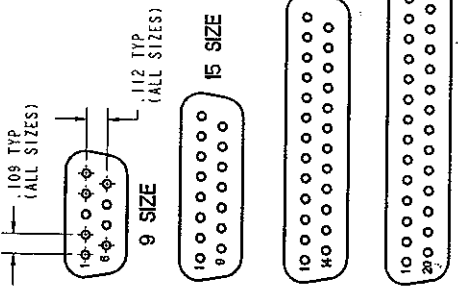

CONTACT ARRANGEMENT - AS VIEWED FROM ENGAGING SIDE

RoHS COMPLIANT

ENGLISH INCHES		PRO/E	
DO NOT SCALE DRAWING	DATE	1/27/06	1/27/06
UNLESS OTHERWISE SPECIFIED, ALL DIMENSIONS ARE IN INCHES	DESIGN ENGINEER	JIMENEZ	
FILLET RADIUS	DESIGN ENGINEER	A. BALLI	
INTELLIGIBLE	DESIGN ENGINEERING NO.	A. BALLI	
1/8" & 3/16" ANGLES ±.05	MECH. ENGINEERING	M. CRUZ	
OF THIS COMPANY, THE PROPERTY OF THE COMPANY, AND THE INFORMATION CONTAINED HEREIN IS UNCLASSIFIED AND IS TO BE RELEASED WITHOUT LIMITATION OF THE RIGHTS OF THE COMPANY.	QUALITY ASSURANCE	R. QUIROZ	
	SCALE	2:1	SHEET 1 OF 2

REV	DOCUMENT	APP	DATE
A	DO 06-1033	AKC	6-15-06

SIZE	L	M	H
9	.984	.900	1.202
15	1.312	1.202	1.743
25	1.852	1.743	2.391
37	2.500	2.391	

SIZE	L	M	H
9	.984	.900	1.202
15	1.312	1.202	1.743
25	1.852	1.743	2.391
37	2.500	2.391	

SIZE	L	M	H
9	.984	.900	1.202
15	1.312	1.202	1.743
25	1.852	1.743	2.391
37	2.500	2.391	

SIZE	L	M	H
9	.984	.900	1.202
15	1.312	1.202	1.743
25	1.852	1.743	2.391
37	2.500	2.391	