



Chipsmall Limited consists of a professional team with an average of over 10 year of expertise in the distribution of electronic components. Based in Hongkong, we have already established firm and mutual-benefit business relationships with customers from,Europe,America and south Asia,supplying obsolete and hard-to-find components to meet their specific needs.

With the principle of “Quality Parts,Customers Priority,Honest Operation,and Considerate Service”,our business mainly focus on the distribution of electronic components. Line cards we deal with include Microchip,ALPS,ROHM,Xilinx,Pulse,ON,Everlight and Freescale. Main products comprise IC,Modules,Potentiometer,IC Socket,Relay,Connector.Our parts cover such applications as commercial,industrial, and automotives areas.

We are looking forward to setting up business relationship with you and hope to provide you with the best service and solution. Let us make a better world for our industry!



## Contact us

Tel: +86-755-8981 8866 Fax: +86-755-8427 6832

Email & Skype: info@chipsmall.com Web: www.chipsmall.com

Address: A1208, Overseas Decoration Building, #122 Zhenhua RD., Futian, Shenzhen, China



THIS COPY IS PROVIDED ON A RESTRICTED BASIS AND IS NOT TO BE USED IN ANY WAY DETRIMENTAL TO THE INTERESTS OF PANDUIT CORP.

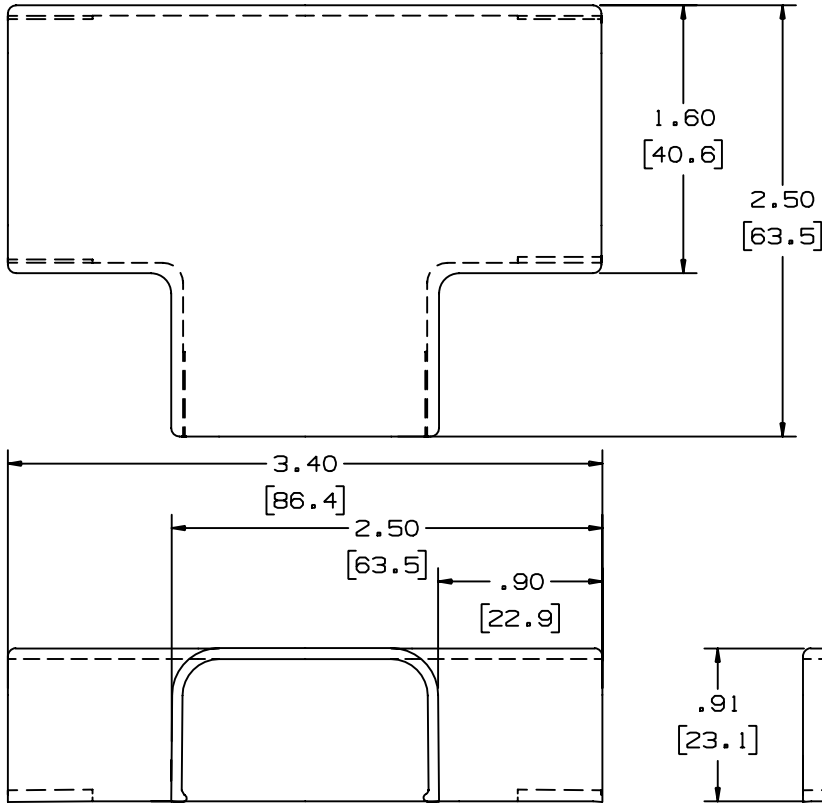

PANDUIT P/N	WEIGHT
TF10	2.77 LB/ 100PCS. (1258g/ 100PCS.)



**NOTES:**

1. SEE CURRENT CATALOG FOR ADDITIONAL PART SUFFIXES TO INDICATE COLOR AND OR PACKAGE QUANTITY.
2. DIMENSIONS IN PARENTHESIS ARE IN METRIC.

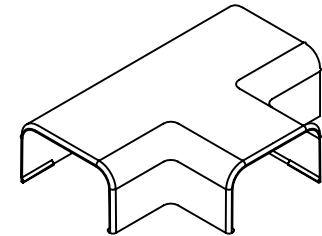

CAD FILENAME/LAYERS D34116BC\_DC\_TF10\_02C.PRT

REV	DATE	BY	CHK	DESCRIPTION	ECN	R	CUST	SUP
6	07-08-02	JHNU	RMHI	G. REVISED MATERIAL IN DRAWING TITLE BLOCK.	17779		RGRC	RGRC
5	09-13-00	JHNU	HIW	F. REVISED SCALE: NONE WAS FULL. E. REVISED AND REDRAWN.	17779		HIW	HIW
4	10-03-91	DW	CF	D. REV'D NOTE AND REMOVED COLOR FROM DWG.	17779	4	WJB/CF	
3	02-28-91	DW	CF	C. REV'D COLORS: OMIT BEIGE, BLACK LIGHT IVORY, AND LIGHT GREY. ADDED INT. WHITE AND INT. GREY	17779	3	WJB	
2	12-02-87	LDB	WJB	B. ADDED P/N TF10EI AND TF10LI.	17779	2	WJS	
1	10-01-84	CEW	HMP	A. REVISED MAT'L.	17779	1	AJC	
R	11-11-82	SS	HMP	DRAWING RELEASED	17779	R	JKR	

PANDUIT CORP. TINLEY PARK, ILLINOIS  
**TEE FITTING (TF10)**  
 CUSTOMER DRAWING

UNLESS OTHERWISE SPECIFIED, DIMENSIONAL TOLERANCES ARE:  
 (.X) ± (.XXX) ±  
 (.XX) ±.03(.8) ANGLES ±

UNLESS OTHERWISE SPECIFIED, ALL DIMENSIONS ARE GIVEN IN INCHES, THIRD ANGLE PROJECTION.

DRAWN BY SARGIS  
 DATE 11-08-82

MAT'L:

ABS

SCALE NONE

DRAWING NO. SS-17779

DWG SIZE A

CHK'D JVL