



Chipsmall Limited consists of a professional team with an average of over 10 year of expertise in the distribution of electronic components. Based in Hongkong, we have already established firm and mutual-benefit business relationships with customers from,Europe,America and south Asia,supplying obsolete and hard-to-find components to meet their specific needs.

With the principle of "Quality Parts,Customers Priority,Honest Operation,and Considerate Service",our business mainly focus on the distribution of electronic components. Line cards we deal with include Microchip,ALPS,ROHM,Xilinx,Pulse,ON,Everlight and Freescale. Main products comprise IC,Modules,Potentiometer,IC Socket,Relay,Connector.Our parts cover such applications as commercial,industrial, and automotives areas.

We are looking forward to setting up business relationship with you and hope to provide you with the best service and solution. Let us make a better world for our industry!



## Contact us

Tel: +86-755-8981 8866 Fax: +86-755-8427 6832

Email & Skype: info@chipsmall.com Web: www.chipsmall.com

Address: A1208, Overseas Decoration Building, #122 Zhenhua RD., Futian, Shenzhen, China



REV	ECN	APP'D
-	6087	

**NOTES:**

**1. MATERIALS:**

HOUSING - POLYETHERIMIDE, COLOR: BLACK.

GROMMET - SILICONE ELASTOMER, COLOR: BLUE

RESISTOR - 1/8W, ±1%,

R1: 200K Ω RNC55H2003FS

R2: 200K Ω RNC55H2003FS

R3: 100K Ω RNC55H1003FS

R4: 100K Ω RNC55H1003FS

R5: 100K Ω RNC55H1003FS

**2. MODULE SUPPLIED WITH 10 PIN CONTACTS, M39029/1-101;  
AND 2 SEALING PLUGS, MS24788-20.**

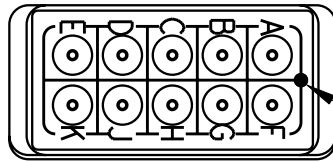

INDEXING  
INDICATOR

**CIRCUIT  
DIAGRAM**

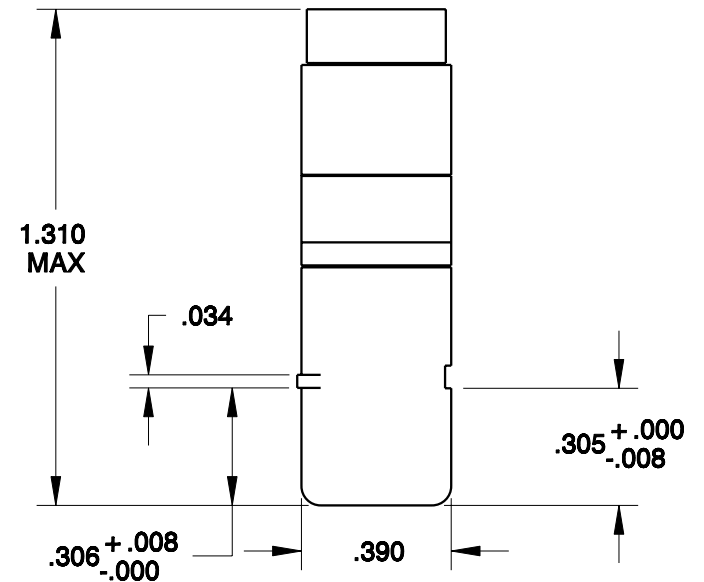
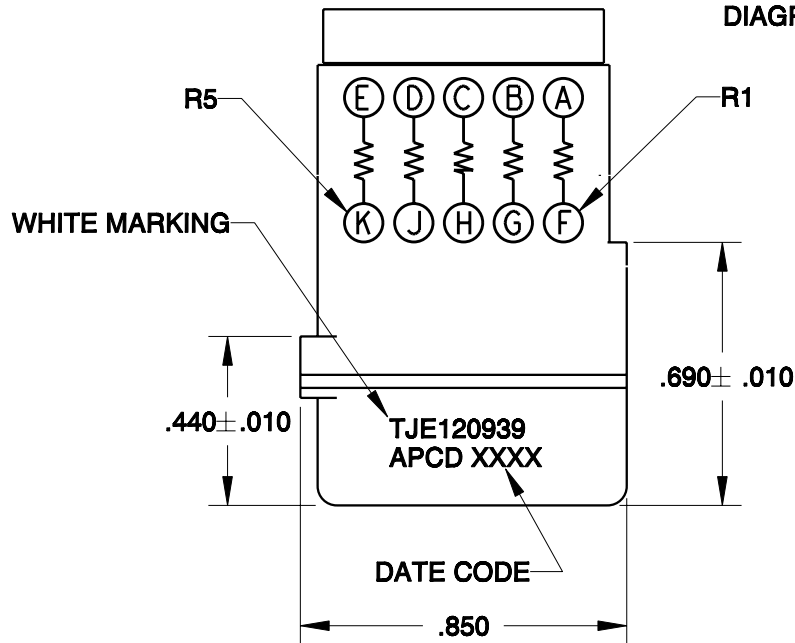

<b>DIMENSIONS</b> ANSI Y14.5M UNITS: INCHES Pro/E FILE	<b>TOLERANCES</b> .XX ±0.01 .XXX ±0.005 ANGLES ±1.0°	<b>PROJECTION</b> 	<b>Amphenol Pcd</b> SPECIFICATION DRAWING		<b>TITLE</b> ELECTRONIC MODULE SZ 20 RESISTOR 2X 200K Ω 3X 100K Ω, 1/8W	
			ENGR E. RABINOWITZ 04/18/07	CHKD	SIZE <b>A</b>	DWG NO. <b>TJE120939_C</b>
THIS DOCUMENT CONTAINS PROPRIETARY INFORMATION WHICH IS THE CONFIDENTIAL PROPERTY OF AMPHENOL PCD, BEVERLY, MA			APPD	CODE: 58982	SCALE: 2:1	SHEET 1 OF 1