



Chipsmall Limited consists of a professional team with an average of over 10 year of expertise in the distribution of electronic components. Based in Hongkong, we have already established firm and mutual-benefit business relationships with customers from,Europe,America and south Asia,supplying obsolete and hard-to-find components to meet their specific needs.

With the principle of “Quality Parts,Customers Priority,Honest Operation,and Considerate Service”,our business mainly focus on the distribution of electronic components. Line cards we deal with include Microchip,ALPS,ROHM,Xilinx,Pulse,ON,Everlight and Freescale. Main products comprise IC,Modules,Potentiometer,IC Socket,Relay,Connector.Our parts cover such applications as commercial,industrial, and automotives areas.

We are looking forward to setting up business relationship with you and hope to provide you with the best service and solution. Let us make a better world for our industry!



Contact us

Tel: +86-755-8981 8866 Fax: +86-755-8427 6832

Email & Skype: info@chipsmall.com Web: www.chipsmall.com

Address: A1208, Overseas Decoration Building, #122 Zhenhua RD., Futian, Shenzhen, China



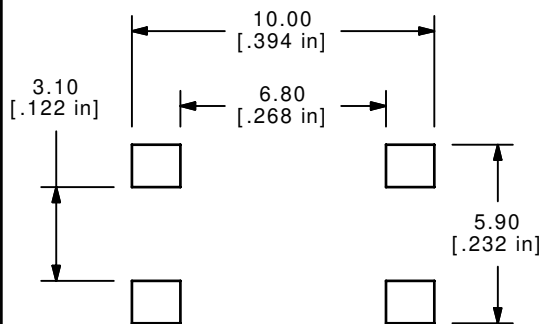

P.C.B MOUNTING

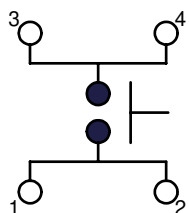

CIRCUIT: SPST

NOTES:

1. ALL DIMENSIONS IN MM [INCH]
2. GENERAL TOLERANCE: X.X= ± 0.4
X.XX= ± 0.25
3. TERMINAL NUMBERS FOR REF ONLY.
4. TRAVEL: 0.25mm +0.2/-0.1
5. RATING: 50mA, 12VDC
- ▲ 6. OPERATING FORCE: 100 \pm 50gf
7. CONTACT RESISTANCE: 100M OHM MAX.
- ▲ 8. ACTUATOR COLOR: BROWN
9. ▲ DENOTES CRITICAL PARAMETER
- ▲ 10. PACKAGING: TAPE AND REEL 1,500 PCS PER
- ▲ 11. 2002/95/EC (ROHS) COMPLIANT

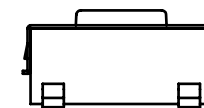
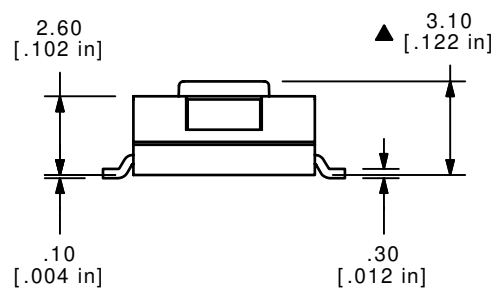
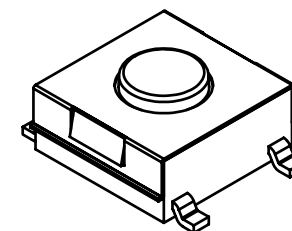
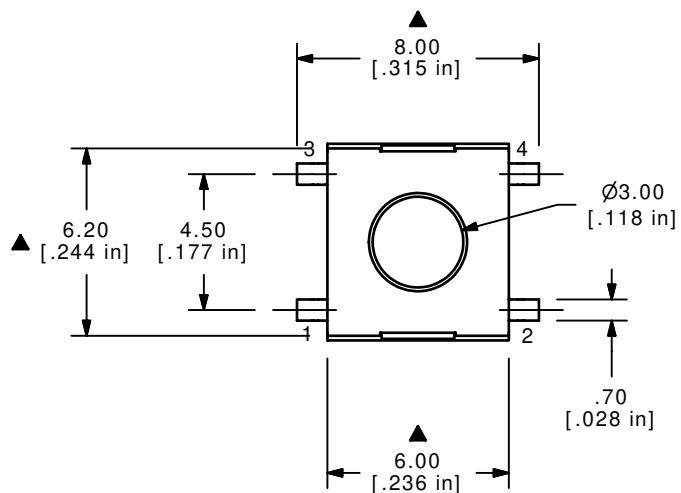

TERMINALS TO BE COPLANAR
WITH IN 0.10mm

D	16024	UPDATE ACTUATOR COLOR	5/16/06	CT
C	15915	REVISED REDRAWN	3/29/06	PH
REV	PCR NO	DESCRIPTION	DATE	BY

THE INFORMATION CONTAINED IN THIS DOCUMENT IS PROPRIETARY
TO E-SWITCH AND IS NOT TO BE COPIED OR TRANSFERRED

E-SWITCH®

TITLE TL3303F100QG

SCALE 4:1

DATE 3/29/2006

DR --

DWG P010425

REV D