



Chipsmall Limited consists of a professional team with an average of over 10 year of expertise in the distribution of electronic components. Based in Hongkong, we have already established firm and mutual-benefit business relationships with customers from,Europe,America and south Asia,supplying obsolete and hard-to-find components to meet their specific needs.

With the principle of “Quality Parts,Customers Priority,Honest Operation,and Considerate Service”,our business mainly focus on the distribution of electronic components. Line cards we deal with include Microchip,ALPS,ROHM,Xilinx,Pulse,ON,Everlight and Freescale. Main products comprise IC,Modules,Potentiometer,IC Socket,Relay,Connector.Our parts cover such applications as commercial,industrial, and automotives areas.

We are looking forward to setting up business relationship with you and hope to provide you with the best service and solution. Let us make a better world for our industry!



## Contact us

Tel: +86-755-8981 8866 Fax: +86-755-8427 6832

Email & Skype: info@chipsmall.com Web: www.chipsmall.com

Address: A1208, Overseas Decoration Building, #122 Zhenhua RD., Futian, Shenzhen, China



# PRODUCT SPECIFICATION

Product Name	1608 SMD POWER INDUCTORS - OPEN TYPE	Page	1
TAMURA Part No.	TO1608-XXX	Rev. No.	0

## 1. CONFIGURATION & DIMENSIONS :

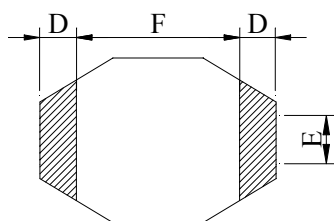
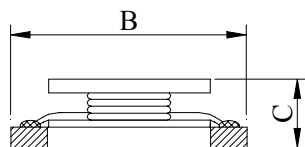
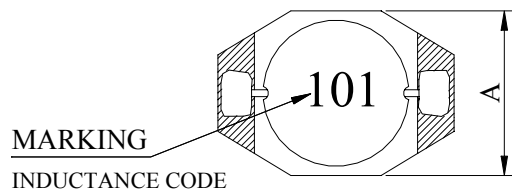

A	: 4.45 MAX	m/m
B	: 6.60 MAX	m/m
C	: 2.92 MAX	m/m
D	: 1.02±0.2	m/m
E	: 1.27±0.2	m/m
F	: 4.32±0.3	m/m
G	: 4.06 REF	m/m
H	: 3.56 REF	m/m
I	: 1.40 REF	m/m

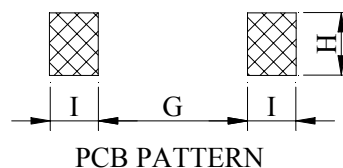

## 2. SCHEMATIC DIAGRAM :

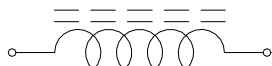

## 3. GENERAL SPECIFICATION :

- a) TEMP. RISE : 40°C TYP.
- b) RATED CURRENT : BASE ON TEMP. RISE &  $\Delta$  LOA=10% TYP.
- c) STORAGE TEMP. : -40°C ~ +125°C
- d) OPERATING TEMP. : -25°C ~ +105°C
- e) RESISTANCE TO SOLDER HEAT : 260°C FOR 10 SECS.

# PRODUCT SPECIFICATION

Product Name	1608 SMD POWER INDUCTORS - OPEN TYPE	Page	2
TAMURA Part No.	TO1608-XXX	Rev. No.	0

## 4. ELECTRICAL CHARACTERISTICS :

TAMURA Part No.	INDUCTANCE ( uH )	TEST FREQ. ( HZ )	SRF ( MHZ ) TYP.	RDC ( Ohm ) MAX	IDC ( A ) MAX
		L			
TO1608-1R0M	1.0±20%	100K	130.0	0.05	2.90
TO1608-1R5M	1.5±20%	100K	115.0	0.05	2.80
TO1608-2R2M	2.2±20%	100K	90.0	0.07	2.40
TO1608-3R3M	3.3±20%	100K	70.0	0.08	2.00
TO1608-4R7M	4.7±20%	100K	50.0	0.09	1.50
TO1608-6R8M	6.8±20%	100K	45.0	0.13	1.40
TO1608-100M	10.0±20%	100K	35.0	0.16	1.10
TO1608-150M	15.0±20%	100K	30.0	0.23	1.00
TO1608-220M	22.0±20%	100K	20.0	0.37	0.80
TO1608-330M	33.0±20%	100K	15.0	0.51	0.60
TO1608-470M	47.0±20%	100K	14.0	0.86	0.40
TO1608-680M	68.0±20%	100K	11.0	1.27	0.30
TO1608-101M	100.0±20%	100K	9.0	1.27	0.30
TO1608-151M	150.0±20%	100K	6.0	2.00	0.25
TO1608-221M	220.0±20%	100K	5.5	3.11	0.20
TO1608-331M	330.0±20%	100K	5.0	3.80	0.16
TO1608-471M	470.0±20%	100K	4.0	5.06	0.15
TO1608-681M	680.0±20%	100K	3.0	9.20	0.12
TO1608-102M	1000.0±20%	100K	2.0	13.80	0.07

# PRODUCT SPECIFICATION

Product Name	1608 SMD POWER INDUCTORS - OPEN TYPE	Page	3
TAMURA Part No.	TO1608-XXX	Rev. No.	0

### RECOMMENDED SOLDERING CONDITIONS REFLOW SOLDERINGS

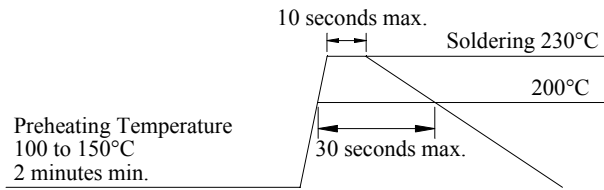

## 5. PACKAGING INFORMATION :

### 1. CONFIGURATION :

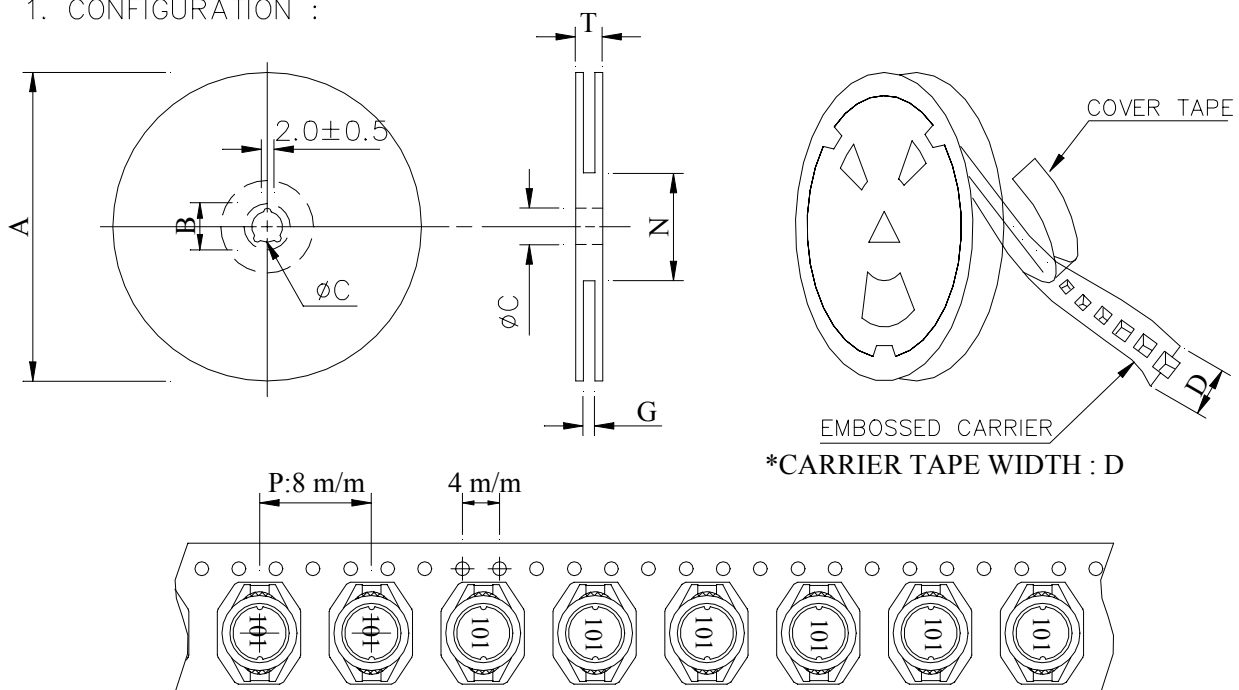

### ( 2 ) DIMENSIONS

Unit:m/m

STYLE	A	B	C	D	G	N	T
13 - 12	330	21	13	12	12.4	100 MIN	18.4

### ( 3 ) Q'TY & G.W. PER PACKAGE

SERIES	INNER : REEL			OUTER : CARTON		
	Q'TY (PCS)	G.W. (gw)	STYLE	Q'TY (PCS)	G.W. (Kg)	SIZE (cm)
TO1608	2,500	825	13 - 12	30,000	10.5	40 x 20 x 26

# PRODUCT SPECIFICATION

Product Name	1608 SMD POWER INDUCTORS - OPEN TYPE	Page	4
TAMURA Part No.	TO1608-XXX	Rev. No.	0

## 6. Part No. FORMAT :

