



Chipsmall Limited consists of a professional team with an average of over 10 year of expertise in the distribution of electronic components. Based in Hongkong, we have already established firm and mutual-benefit business relationships with customers from,Europe,America and south Asia,supplying obsolete and hard-to-find components to meet their specific needs.

With the principle of “Quality Parts,Customers Priority,Honest Operation,and Considerate Service”,our business mainly focus on the distribution of electronic components. Line cards we deal with include Microchip,ALPS,ROHM,Xilinx,Pulse,ON,Everlight and Freescale. Main products comprise IC,Modules,Potentiometer,IC Socket,Relay,Connector.Our parts cover such applications as commercial,industrial, and automotives areas.

We are looking forward to setting up business relationship with you and hope to provide you with the best service and solution. Let us make a better world for our industry!



Contact us

Tel: +86-755-8981 8866 Fax: +86-755-8427 6832

Email & Skype: info@chipsmall.com Web: www.chipsmall.com

Address: A1208, Overseas Decoration Building, #122 Zhenhua RD., Futian, Shenzhen, China



D

C

B

A

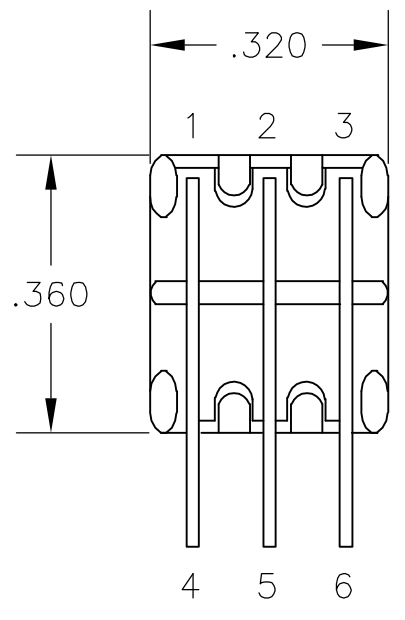
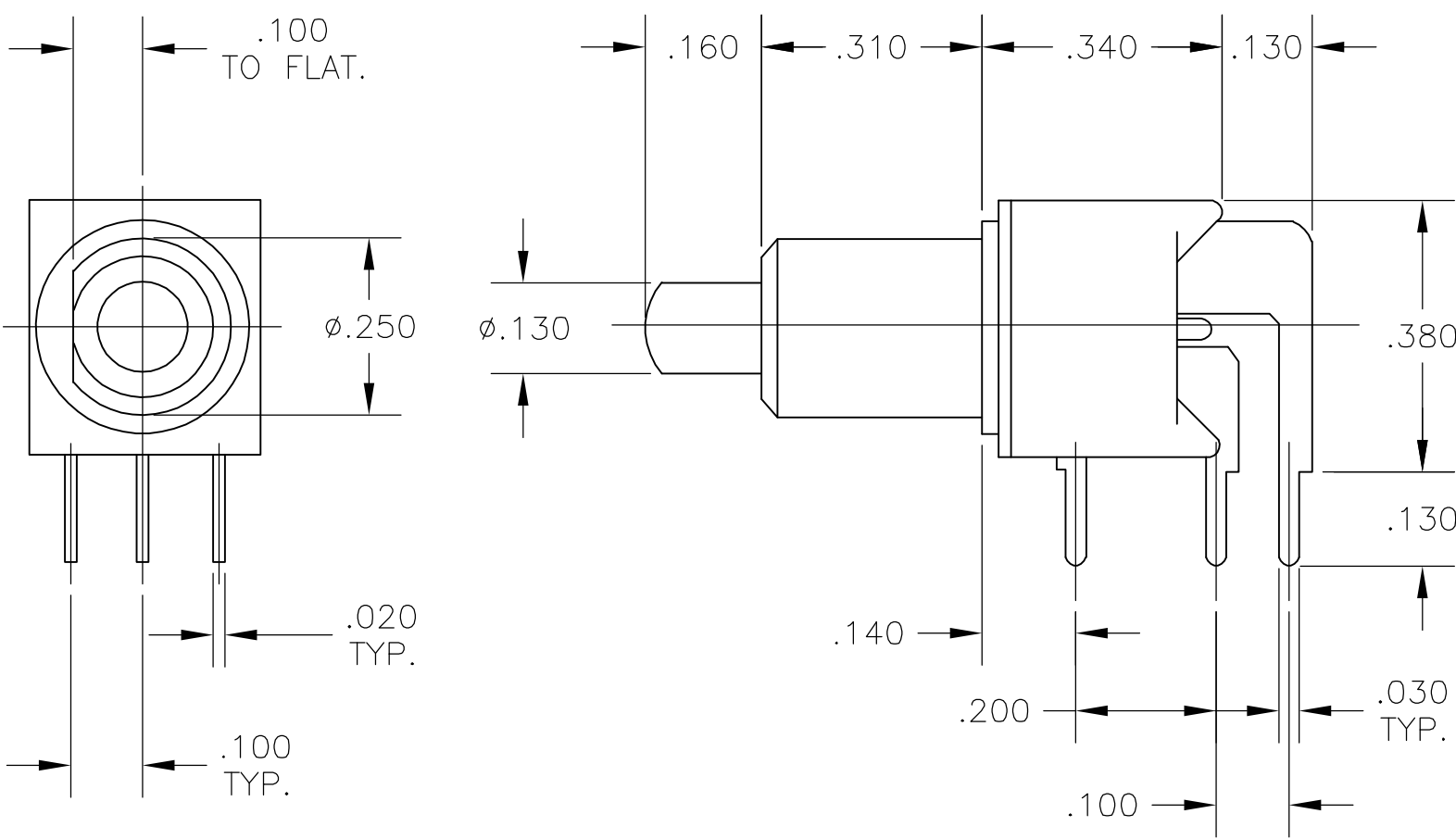

2 SPECIFICATIONS:

MATERIALS:
CASE: HIGH TEMPERATURE POLYESTER, UL 94V-0.
ACTUATOR BUTTON: THERMOPLASTIC. COLORS: SEE CHART BELOW.
MOVING CONTACT: COPPER ALLOY, GOLD OVER NICKEL PLATE.
FIXED CONTACT: COPPER ALLOY, GOLD OVER NICKEL PLATE.
TERMINAL: COPPER ALLOY, TIN-LEAD PLATE.
TERMINAL SEAL: SP EPOXY.
DP EPOXY. OPTIONAL.

ELECTRICAL:
CONTACT RATING: 0.4 VA MAX. @ 20 VDC OR PEAK AC.
INITIAL CONTACT RESISTANCE: 20 MILLIOHMS MAX.
INSULATION RESISTANCE: 1000 MEGHAOHMS @ 500 VDC MIN.
DIELECTRIC STRENGTH: 1.000 VOLTS RMS @ SEA LEVEL.
LIFE EXPECTANCY: GOLD: 1 POLE = 100,000 CYCLES.
2 POLES = 80,000 CYCLES.

MECHANICAL:
ACTUATION FORCE: 50 TO 400 GRAMS.
ACTUATION TRAVEL: .030" APPROX.

ENVIRNAMENTAL:
OPERATING TEMPARATURE: -22°F TO +149°F (-30°C TO +65°C)
STORAGE TEMPRATURE -22°F TO +149°F (-30°C TO +65°C).

2 NOTES:

- 1 INTERPRET DRAWING PER ANSI Y14.5M-1994.

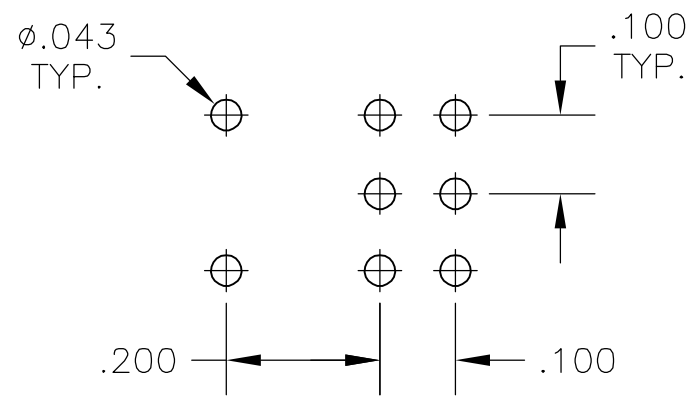

RECOMMENDED HOLE LAYOUT
TOLERANCE $\pm .002$ UNLESS OTHERWISE NOTED.

(*)	BUTTON COLOR
(0)	BLACK
(2)	RED
(6)	BLUE

TPD21MG-RA(*)	DPST	NONE	(1-3).(4-6)
TPD21RG-RA(*)	DPDT	1-2-4-5	(2-3).(5-6)
MODEL NO.	TYPE		
TERMINAL CONNECTED WHEN PLUNGER IS IN POSITION SHOWN.			
TERMINAL DESIGNATION NUMBERS ARE FOR REFERENCE ONLY AND DO NOT APPEAR IN THE SWITCHES.			
() - INDICATES MOMENTARY			
NO CENTER TERMINAL ON "M" ACTION SWITCH.			

THIS DRAWING IS A CONTROLLED DOCUMENT.

DIMENSIONS:
INCHES

MATERIAL
SEE SPECIFICATIONS

TOLERANCES UNLESS OTHERWISE SPECIFIED:

0 PLC	\pm	-
1 PLC	\pm	-
2 PLC	\pm	-
3 PLC	\pm	.010
4 PLC	\pm	-
ANGLES	\pm	1°

FINISH
SEE SPECIFICATIONS

DWN
J.A.R.

CHK
C.M.M.

APVD
T.S.

PRODUCT SPEC
—

APPLICATION SPEC
—

WEIGHT
—

CUSTOMER DRAWING

05AUG87

10AUG87

13AUG87

NAME
SWITCH PUSH BUTTON
TPD21*G-RA(*)

SIZE
A2

CAGE CODE
00779

DRAWING NO
6-1437572-2

RESTRICTED TO
—

SCALE
4:1

SHEET
1 OF 1

REV
B

tyco
Electronics

Tyco Electronics Corporation
Harrisburg, Pa 17105-3608

6-1437572-2

A