



Chipsmall Limited consists of a professional team with an average of over 10 year of expertise in the distribution of electronic components. Based in Hongkong, we have already established firm and mutual-benefit business relationships with customers from,Europe,America and south Asia,supplying obsolete and hard-to-find components to meet their specific needs.

With the principle of “Quality Parts,Customers Priority,Honest Operation,and Considerate Service”,our business mainly focus on the distribution of electronic components. Line cards we deal with include Microchip,ALPS,ROHM,Xilinx,Pulse,ON,Everlight and Freescale. Main products comprise IC,Modules,Potentiometer,IC Socket,Relay,Connector.Our parts cover such applications as commercial,industrial, and automotives areas.

We are looking forward to setting up business relationship with you and hope to provide you with the best service and solution. Let us make a better world for our industry!



## Contact us

Tel: +86-755-8981 8866 Fax: +86-755-8427 6832

Email & Skype: [info@chipsmall.com](mailto:info@chipsmall.com) Web: [www.chipsmall.com](http://www.chipsmall.com)

Address: A1208, Overseas Decoration Building, #122 Zhenhua RD., Futian, Shenzhen, China



PRODUCT NUMBER  
TRX10GDL0610

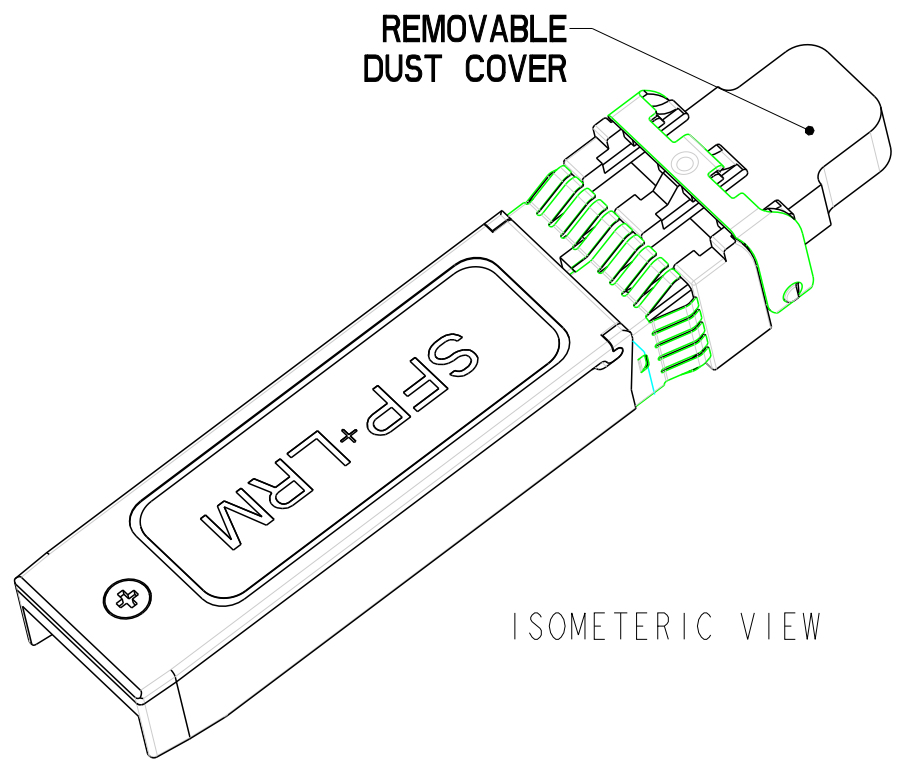
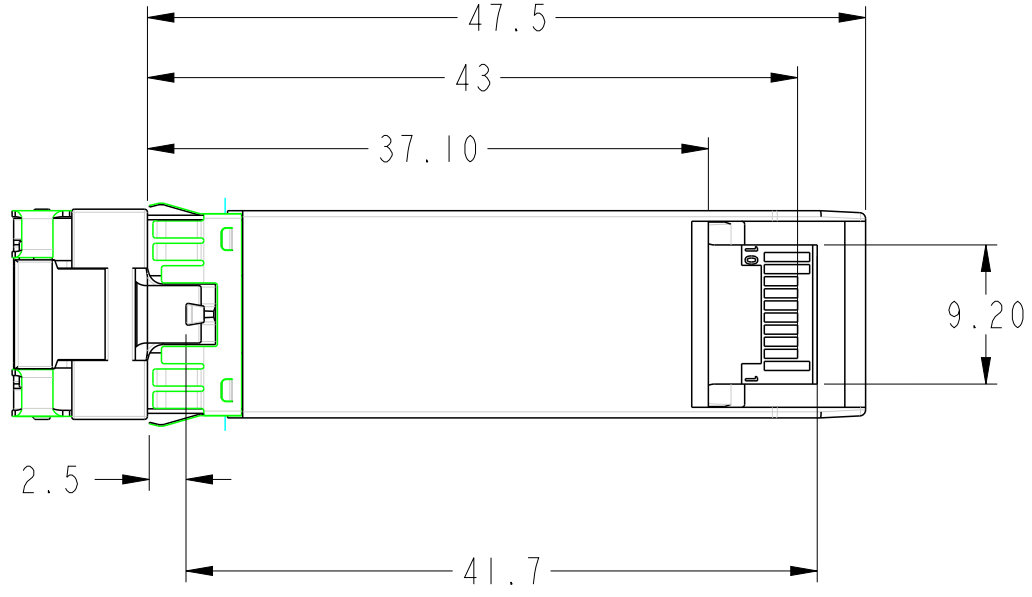
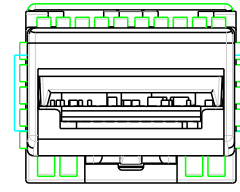
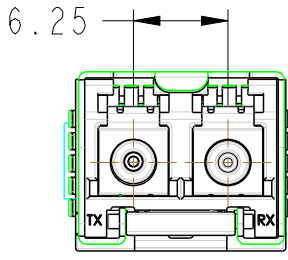
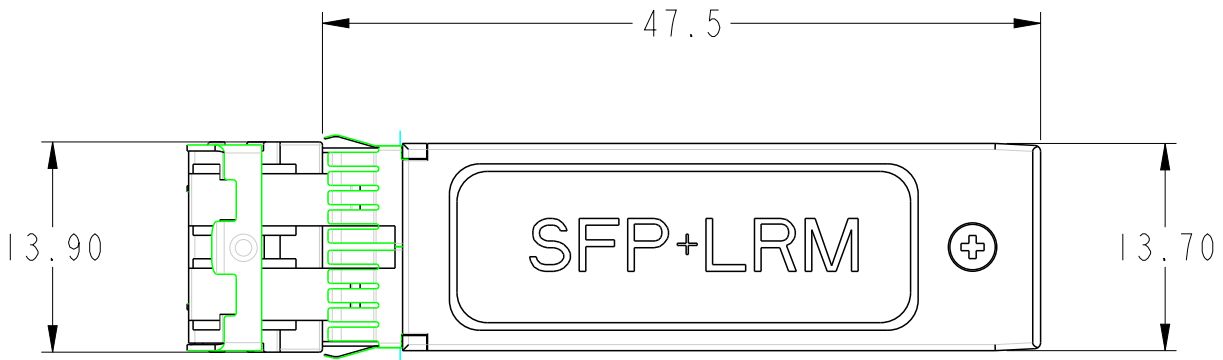

ISOMETRIC VIEW

- NOTES:
- 1. REFERENCE DATA SHEET TRX10GDL0610 FOR DETAILED TRANSCEIVER SPECIFICATIONS.
  - 2. TRANSCEIVER ASSEMBLY IS RoHS 6/6 COMPLIANT.
  - 3. TRANSCEIVER ASSEMBLY IS PACKAGED IN BLISTER PACKAGING.
  - 4. DIMENSIONS ARE FOR REFERENCE ONLY.
  - 5. REVISION A IS EQUIVALENT TO MERGE OPTICS REVISION B01.

FCI  
Copyright FCI.

spec ref		-		dr		Deborah Ingram		2011/01/14		projection		MM		size		A3		scale		2:1							
tolerance std		TOLERANCES UNLESS OTHERWISE SPECIFIED		eng		Deborah Ingram		2011/01/19						ecn no		-		-		-							
- ASME Y14.5				chr		-		-																			
-				appr		Brad Brubaker		2011/01/20														product family		-		rel level	
surface		-				linear		0.X		±-				title		SFP+ LRM ASSEMBLY		10GBd 1310nm LRM LINEAR TRANSCEIVER		dwg no		10116249		rev		A	
ASME Y14.5		0.XX						±-																			
-		0.XXX						±-																			
angular		A		±°		www.fci.com		cat. no.		-		Product - Customer Drw		sheet 1 of 1													