



Chipsmall Limited consists of a professional team with an average of over 10 year of expertise in the distribution of electronic components. Based in Hongkong, we have already established firm and mutual-benefit business relationships with customers from,Europe,America and south Asia,supplying obsolete and hard-to-find components to meet their specific needs.

With the principle of "Quality Parts,Customers Priority,Honest Operation,and Considerate Service",our business mainly focus on the distribution of electronic components. Line cards we deal with include Microchip,ALPS,ROHM,Xilinx,Pulse,ON,Everlight and Freescale. Main products comprise IC,Modules,Potentiometer,IC Socket,Relay,Connector.Our parts cover such applications as commercial,industrial, and automotives areas.

We are looking forward to setting up business relationship with you and hope to provide you with the best service and solution. Let us make a better world for our industry!



## Contact us

Tel: +86-755-8981 8866 Fax: +86-755-8427 6832

Email & Skype: info@chipsmall.com Web: www.chipsmall.com

Address: A1208, Overseas Decoration Building, #122 Zhenhua RD., Futian, Shenzhen, China



Nazwa / Name **TX13/7.9/6.4-3C90**  
 Numer kodu / Code number **4327 030 13451**

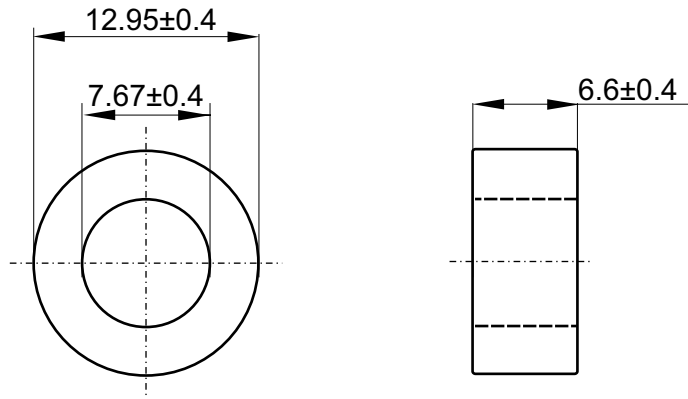

**Magnetical dimensions according to: / Właściwości magnetyczne zgodne z: IEC 205**

$\Sigma l/A$ (mm <sup>-1</sup> )	$\Sigma l/A^2$ (mm <sup>-3</sup> )	$A_e$ : 14.1 mm <sup>2</sup>	$l_e$ : 31.2 mm	$V_e$ : 442 mm <sup>3</sup>
2.213	0.157			Weight/Waga: ≈ 2.3 g

**Specified value / Wartości specyfikowane**

Symbol Symbol	Nominal Nominał	Unit Jednostka	Frequency Częstotliwość f [kHz]	Induction Indukcja B [mT]	Field strength Natężenie pola H [A/m]	Equipment Wyposażenie	Temperature Temperatura t [°C]
Pv	< 0.044	W	25	200	---	---	100
Pv	< 0.044	W	100	100	---	---	100
Al	1380±20%	nH	100	≤1	---	HP-4284A	25±3

(1) Or similar / Lub podobny

**VISUAL REQUIREMENTS according to: I-15-002**

**KONTROLA WIZUALNA według: I-15-002**

**High voltage insulation >1.5kV / Napięcie przebicia izolacji >1.5kV**

		Tolerances unless otherwise stated Tolerancja (jeśli nie ustalono inaczej)				Name Nazwisko		Signature Podpis		Date Data	
Ra w mikrometrach (μm)		Dimensions Wymiary ±3%		Angle Kąt		Check Sprawdził		Jarosław Przybysz		<b>UNCONTROLLED COPY</b> generated electronically, conform with original up to the date of its creation <b>KOPIA NIEKONTROLOWANA</b> wygenerowana elektronicznie, zgodna z oryginałem w dniu jego zatwierdzenia	
Approval Zatwierdził		MATERIAL <b>3C90</b> acc. to zgodnie z:		<b>KPN-K1959</b>		Other Inne		Mariusz Borkiewicz			
Scale Skala Brak		PROJ.EURO PROJ.EURO		TYPE NUMBER / TYP		LAB REF No.		---			
Status/Status		<b>TX13/7.9/6.4-3C90</b>		Toroid coated: Epoxy Cream RAL 1014 Toroid pokryty: Epoxy kremowy RAL 1014		<b>4327 030 13450</b>		D C B A		09-04-01	
Issued by: Wydano przez: M.Zagórska / K.S.		SUPERSEDES ZASTĘPUJE		SHEETS STRONY <b>1</b>		SHEET STRONA <b>110-02</b>		DATE DATA 09-04-01		A-4	
K.S.		Property of WŁAŚCICIEL		<b>Ferroxcube Polska Sp. z o.o. SKIERNIEWICE, POLAND</b>							