



Chipsmall Limited consists of a professional team with an average of over 10 year of expertise in the distribution of electronic components. Based in Hongkong, we have already established firm and mutual-benefit business relationships with customers from,Europe,America and south Asia,supplying obsolete and hard-to-find components to meet their specific needs.

With the principle of “Quality Parts,Customers Priority,Honest Operation,and Considerate Service”,our business mainly focus on the distribution of electronic components. Line cards we deal with include Microchip,ALPS,ROHM,Xilinx,Pulse,ON,Everlight and Freescale. Main products comprise IC,Modules,Potentiometer,IC Socket,Relay,Connector.Our parts cover such applications as commercial,industrial, and automotives areas.

We are looking forward to setting up business relationship with you and hope to provide you with the best service and solution. Let us make a better world for our industry!



## Contact us

Tel: +86-755-8981 8866 Fax: +86-755-8427 6832

Email & Skype: info@chipsmall.com Web: www.chipsmall.com

Address: A1208, Overseas Decoration Building, #122 Zhenhua RD., Futian, Shenzhen, China



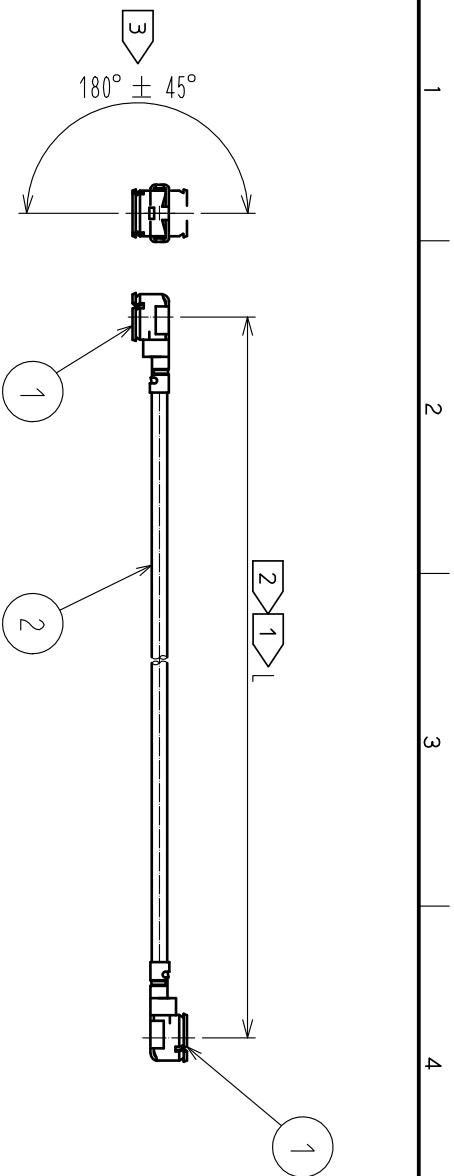

Part No.	Cable color
~04*1~	WHITE
~04*2~	BLACK
~04*3~	BROWN
~04*4~	BLUE
~04*5~	GRAY

NOTE ① We indicate the length of the harness on the last of product name. 'L' part.

② Tolerance for [L]

Length L [mm]	Tolerance [mm]
35 ≤ L ≤ 200	±4
200 < L ≤ 500	±8
500 < L ≤ 1000	±12
1000 < L	±1.5%

③ Connector rotation angle is within ±45 degree from the above image. For long length in the case of L>500, the angle is optional.

4. Specifications are subject to change without notice.

[ DIMENSIONS OF CONNECTOR ]

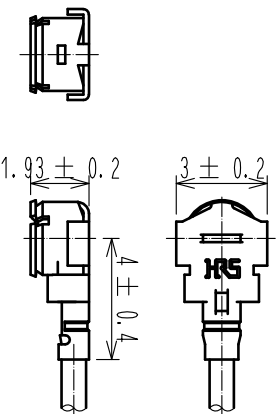

1	U.FL-LP-040	C1331-0451-2	2	0.81 Dia. coaxial cable
NO.	PART NO.	CODE NO.	NO.	PART NO.

UNITS	SCALE	COUNT	DESCRIPTION OF REVISIONS	DESIGNED	CHECKED	DATE
mm	FREE					

**HRS** HIROSE ELECTRIC CO., LTD.

APPROVED : NK. NINOMIYA	16.07.20	DRAWING NO.	
CHECKED : MT. KANEKO	16.07.19	PART NO.	U.FL-2LP-04**T-AC-L
DESIGNED : MS. MATSUJOTO	16.07.15	CODE NO.	
DRAWN : MS. MATSUJOTO	16.07.15		