



Chipsmall Limited consists of a professional team with an average of over 10 year of expertise in the distribution of electronic components. Based in Hongkong, we have already established firm and mutual-benefit business relationships with customers from,Europe,America and south Asia,supplying obsolete and hard-to-find components to meet their specific needs.

With the principle of "Quality Parts,Customers Priority,Honest Operation,and Considerate Service",our business mainly focus on the distribution of electronic components. Line cards we deal with include Microchip,ALPS,ROHM,Xilinx,Pulse,ON,Everlight and Freescale. Main products comprise IC,Modules,Potentiometer,IC Socket,Relay,Connector.Our parts cover such applications as commercial,industrial, and automotives areas.

We are looking forward to setting up business relationship with you and hope to provide you with the best service and solution. Let us make a better world for our industry!



Contact us

Tel: +86-755-8981 8866 Fax: +86-755-8427 6832

Email & Skype: info@chipsmall.com Web: www.chipsmall.com

Address: A1208, Overseas Decoration Building, #122 Zhenhua RD., Futian, Shenzhen, China



2 - 50GHz Power Amplifier

Features

- 30dBm output power @ 10GHz
- 26dBm output power @ 40GHz
- 18dB gain to 26GHz
- 15dB gain to 40GHz
- Useful gain and power to 50GHz
- 10.6W power dissipation
- Small size
- ECCN 3A001.b.4.c

Description

The UA2V50LM Amplifier is a broadband, high power, moderate gain instrumentation grade amplifier. The amplifier was designed to provide exceptional gain flatness per octave over greater than 5 octaves of frequency coverage. The 2 GHz to 50 GHz amplifier provides up to 18dB of gain and 30 dBm output power with low harmonics and low residual phase noise.

Application

The UA2V50LM Amplifier is an ideal selection for laboratory and instrumentation systems where a high performance broadband RF power amplifier is required. Examples include use as a post amplifier for synthesizers, mixers, modulators, etc. where output powers are low and need to be increased to the 20dBm to 30dBm range. The amplifier was designed for use in communications systems, test equipment, military systems, etc.

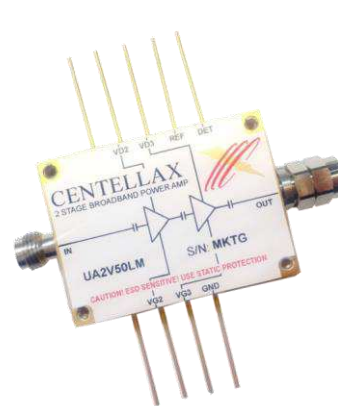

Key Characteristics @ 25°C: VD1 = VD2 = 6V; VD3 = 7V; Vg1 = Vg2 = Vg3 = -0.1V; Zo = 50Ω

Parameter	Description	Min	Typ	Max	Min	Typ	Max
S21 (dB)	Small Signal Gain	15	18	-	12	15	-
S11 (dB)	Input Match	-	-10	-8	-	-8	-5
S22 (dB)	Output Match	-	-12	-10	-	-8	-5
S12 (dB)	Reverse Isolation	-	28	-	-	25	-

Typical Performance

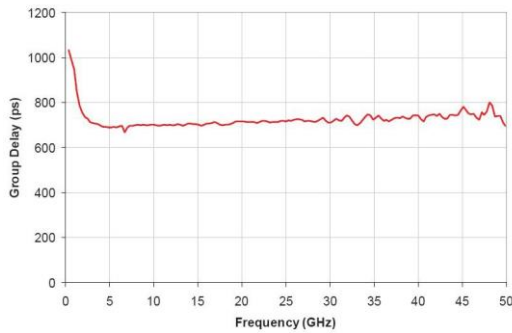
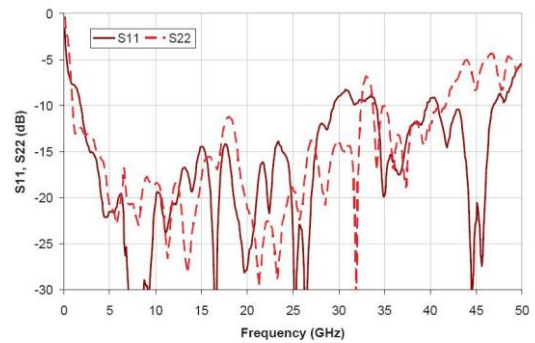
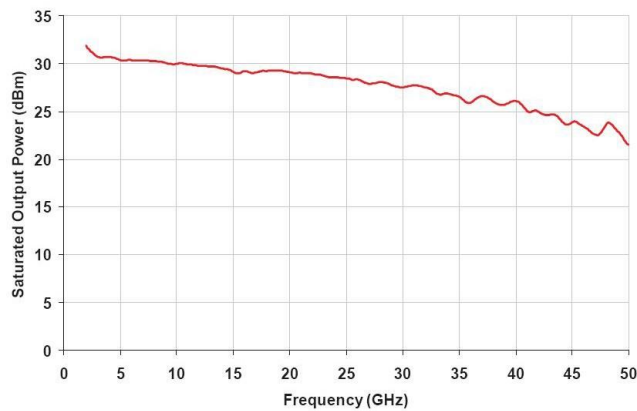
UA2V50LM Group Delay

UA2V50LM S11, S22

UA2V50LM Saturated Output Power

Supplemental Specifications¹

Parameter	Description	Minimum	Typ	Maximum
Vd2 (V)	Drain Bias Voltage FET2	-	6	8
Vg2 (V)	Gate Bias Voltage FET2	-4	-0.2 to 0	0.5
Idd2 (mA)	Drain Bias Current FET2	-	600	1000
Vd3 (V)	Dain Bias Voltage FET3	-	6	8
Vg3 (V)	Gate Bias Voltage FET3	-4	-0.2 to 0	0.5
Idd3	Drain Bias Current FET3	-	1000	1200
Pin	Input Power (CW)	-	-	28 dBm
Pdc	Power Dissipation	-	10.6	-
Tbs	Backside Case Temperature	-	-	75°C

Note:

It is recommended to apply gate bias voltages before drain bias voltages, however, it is not necessary to absolutely guarantee this sequence. This device is robust and will survive drain voltages being applied before gate voltages.

¹Operation listed under the Supplemental Specifications may cause permanent damage to the device. These are stress ratings only, and functional operation of the device at these or any other conditions beyond those indicated in the Operating Specifications is not implied. Prolonged use at the absolute maximum rating conditions may affect device reliability.

Physical Dimensions and Pin Assignment

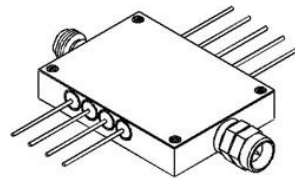
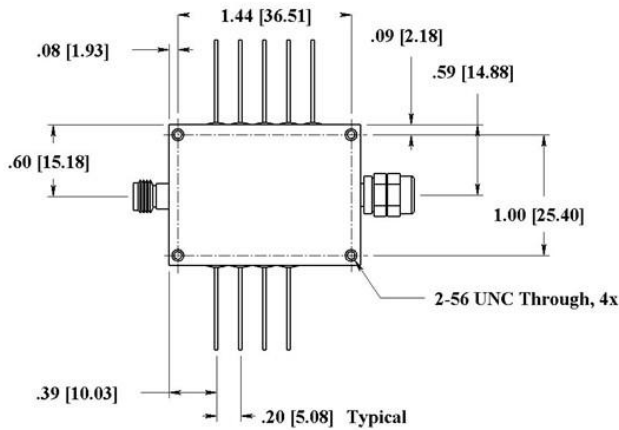

Physical Characteristics

(all measurements in inches[mm])

Tolerance typically
 ± 0.0025 in
 $(\pm 0.0635$ mm)

DC pin diameter is
 0.03 in [0.76 mm]

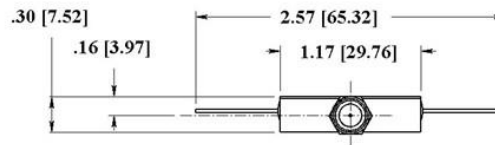
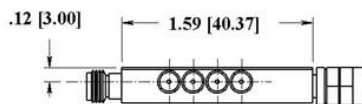

Pin	Function	Operational Notes
RFin	RF input	V-connector (female)
RFout	RF output	V-connector (male)
Vg2	1st stage gate bias	Set at typical operating specification
Vg3	2nd stage gate bias	Set at typical operating specification
Vd2	1st stage drain bias	Set at typical operating specification
Vd3	2nd stage drain bias	Set at typical operating specification
Ref	DC reference offset (optional)	Remove this offset from the detector voltage (see appnote MM-AAP-004)
Det	RF power detector (optional)	Remove the DC offset from this signal and linearize (see appnote MM-AAP-004)
Gnd	Connected	Connected to Ground

Information contained in this document is proprietary to Microsem. This document may not be modified in any way without the express written consent of Microsemi. Product processing does not necessarily include testing of all parameters. Microsemi reserves the right to change the configuration and performance of the product and to discontinue product at any time.

Microsemi Corporate Headquarters

One Enterprise, Aliso Viejo CA 92656 USA
Within the USA: +1 (949) 380-6100
Sales: +1 (949) 380-6136
Fax: +1 (949) 215-4996

Microsemi Corporation (Nasdaq: MSCC) offers a comprehensive portfolio of semiconductor and system solutions for communications, defense and security, aerospace, and industrial markets. Products include high-performance and radiation-hardened analog mixed-signal integrated circuits, FPGAs, SoCs, and ASICs; power management products; timing and synchronization devices and precise time solutions, setting the world's standard for time; voice processing devices; RF solutions; discrete components; security technologies and scalable anti-tamper products; Power-over-Ethernet ICs and midspans; as well as custom design capabilities and services. Microsemi is headquartered in Aliso Viejo, Calif. and has approximately 3,400 employees globally. Learn more at www.microsemi.com.

© 2014 Microsemi Corporation. All rights reserved. Microsemi and the Microsemi logo are trademarks of Microsemi Corporation. All other trademarks and service marks are the property of their respective owners.