



Chipsmall Limited consists of a professional team with an average of over 10 year of expertise in the distribution of electronic components. Based in Hongkong, we have already established firm and mutual-benefit business relationships with customers from,Europe,America and south Asia,supplying obsolete and hard-to-find components to meet their specific needs.

With the principle of “Quality Parts,Customers Priority,Honest Operation,and Considerate Service”,our business mainly focus on the distribution of electronic components. Line cards we deal with include Microchip,ALPS,ROHM,Xilinx,Pulse,ON,Everlight and Freescale. Main products comprise IC,Modules,Potentiometer,IC Socket,Relay,Connector.Our parts cover such applications as commercial,industrial, and automotives areas.

We are looking forward to setting up business relationship with you and hope to provide you with the best service and solution. Let us make a better world for our industry!



Contact us

Tel: +86-755-8981 8866 Fax: +86-755-8427 6832

Email & Skype: info@chipsmall.com Web: www.chipsmall.com

Address: A1208, Overseas Decoration Building, #122 Zhenhua RD., Futian, Shenzhen, China



ALUMINUM ELECTROLYTIC CAPACITORS



HM Low Impedance,
For PC motherboard
series



- Lower impedance than HD, HC series.
- Compliant to the RoHS directive (2002/95/EC).

Products which are scheduled to be discontinued.
Not recommended for new designs

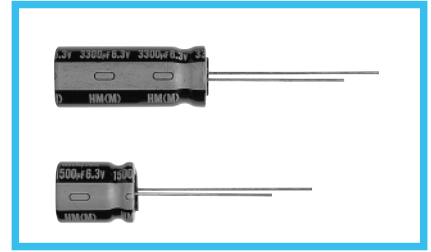

Specifications

Item	Performance Characteristics				
Category Temperature Range	-40 to +105°C				
Rated Voltage Range	6.3 to 16V				
Rated Capacitance Range	330 to 12000µF				
Capacitance Tolerance	±20% (120Hz, 20°C)				
Leakage Current	After 2 minutes' application of rated voltage, leakage current is less than 0.03CV				
Tangent of loss angle (tan δ)	For capacitance of more than 1000µF, add 0.02 for every increase of 1000µF				
	Rated voltage (V)	6.3	10	16	120Hz 20°C
Stability at Low Temperature	tan δ (MAX.)	0.22	0.19	0.16	
	Rated voltage (V)	6.3	10	16	120Hz
Endurance	Impedance ratio ZT / Z20 (MAX.)	Z-40°C / Z+20°C	3	3	3
	The specifications listed at right shall be met when the capacitors are restored to 20°C after D.C. bias plus rated ripple current is applied for 2000 hours at 105°C, the peak voltage shall not exceed the rated voltage.		Capacitance change	Within ±25% of the initial capacitance value	
Marking	Printed with white color letter on black sleeve.	tan δ	200% or less than the initial specified value		
		Leakage current	Less than or equal to the initial specified value		

Radial Lead Type

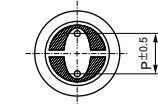
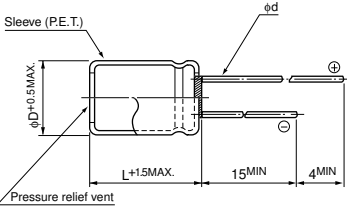

	(mm)				
φD	8	10	12.5	16	18
P	3.5	5.0	5.0	7.5	7.5
φd	0.6	0.6	0.6	0.8	0.8

Type numbering system (Example : 6.3V 1800µF)

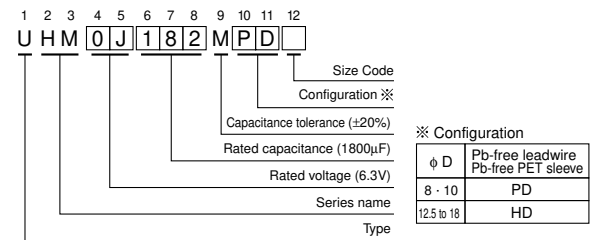

- Please refer to page 20 about the end seal configuration.

Standard Ratings

Cap. (µF)	V (Code)	Item Code	6.3 (0J)			10 (1A)			16 (1C)		
			Case size φD × L (mm)	Impedance (mΩ) MAX. 20°C / 100kHz	Rated ripple (mAmps) 105°C / 100kHz	Case size φD × L (mm)	Impedance (mΩ) MAX. 20°C / 100kHz	Rated ripple (mAmps) 105°C / 100kHz	Case size φD × L (mm)	Impedance (mΩ) MAX. 20°C / 100kHz	Rated ripple (mAmps) 105°C / 100kHz
330		331				8 × 11.5	30	1140	8 × 11.5	30	1140
470		471				8 × 11.5	30	1140	8 × 11.5	30	1140
560		561	8 × 11.5	30	1140				▲ 10 × 12.5	25	1540
680	681					8 × 11.5	30	1140	10 × 12.5	25	1540
						▲ 10 × 12.5	25	1540	▲ 8 × 15	28	1490
820	821					▲ 10 × 12.5	25	1540	● 8 × 20	18	1870
						● 8 × 11.5	30	1140	○ 10 × 16	18	2000
1000	102					8 × 15	28	1490	10 × 16	18	2000
						▲ 10 × 12.5	25	1540	▲ 8 × 20	18	1870
1200	122					● 8 × 11.5	30	1140	● 10 × 20	13	2550
1500	152					8 × 15	28	1490	10 × 16	18	2000
						▲ 10 × 12.5	25	1540	▲ 8 × 20	18	1870
1800	182					● 10 × 16	18	2000	10 × 20	13	2550
						▲ 8 × 20	16	1950	▲ 10 × 20	11	3000
2200	222					▲ 8 × 20	16	1950	10 × 25	12	2800
						● 10 × 16	18	2000			
2700	272					10 × 16	19	2000	12.5 × 20	11	3000
						▲ 8 × 20	16	1950			
3300	332					10 × 20	13	2550	12.5 × 25	10	2900
						▲ 8 × 20	16	1950			
5600	562					● 10 × 16	18	2000	16 × 25	9	3070
						▲ 10 × 12.5	25	1540	○ 10 × 20	13	2550
6800	682					10 × 20	13	2550			
						▲ 8 × 20	16	1950			
8200	822					12.5 × 20	11	3000	18 × 25	8	3250
						▲ 10 × 12.5	25	1540			
12000	123					16 × 25	9	3070			
						18 × 25	8	3250			

Please refer to page 20, 21, 22 about the formed or taped product spec.
Please refer to page 4 for the minimum order quantity.

- ▲ : In this case, [6] will be put at 12th digit of type numbering system.
- : In this case, [3] will be put at 12th digit of type numbering system.
- : In this case, [9] will be put at 12th digit of type numbering system.

CAT.8100A-1