



Chipsmall Limited consists of a professional team with an average of over 10 year of expertise in the distribution of electronic components. Based in Hongkong, we have already established firm and mutual-benefit business relationships with customers from,Europe,America and south Asia,supplying obsolete and hard-to-find components to meet their specific needs.

With the principle of “Quality Parts,Customers Priority,Honest Operation,and Considerate Service”,our business mainly focus on the distribution of electronic components. Line cards we deal with include Microchip,ALPS,ROHM,Xilinx,Pulse,ON,Everlight and Freescale. Main products comprise IC,Modules,Potentiometer,IC Socket,Relay,Connector.Our parts cover such applications as commercial,industrial, and automotives areas.

We are looking forward to setting up business relationship with you and hope to provide you with the best service and solution. Let us make a better world for our industry!



Contact us

Tel: +86-755-8981 8866 Fax: +86-755-8427 6832

Email & Skype: info@chipsmall.com Web: www.chipsmall.com

Address: A1208, Overseas Decoration Building, #122 Zhenhua RD., Futian, Shenzhen, China



TOP VIEW

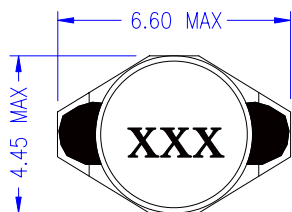

FRONT VIEW

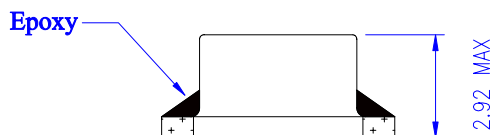

BOTTOM VIEW

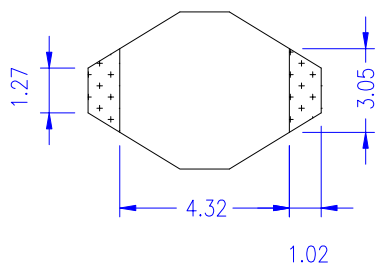

RECOMMENDED PCB LAYOUT

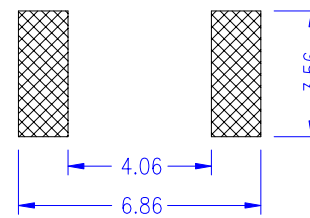

Component Side

SCHEMATIC

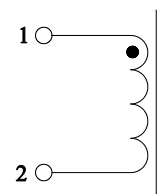

TAPE AND REEL ORIENTATION

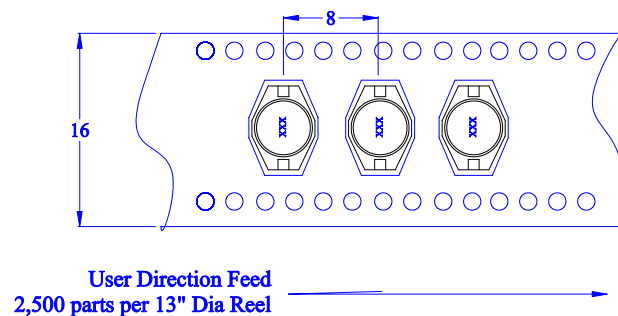

This Document Is Subject To Change Without Notice.

Notes:

- 1) All Dimensions are in millimeters unless otherwise specified.
- 2) Stamp as Shown above--
Line 1- xxx (xxx=inductance value per family chart)
- 3) Tolerances are +/-0.381mm unless otherwise specified.

Cooper Electronic Technologies

3601 Quantum Boulevard, Boynton Beach, FL 33426

Unipac 0.4SC (UP0.4SC) Inductor Line
SMD, 2.92mm max ht, Shielded Drum
core/header

Size	Drawing Number:	UP0.4SC-R Inductor Line
A	Revision Level:	B

CUSTOMER INFORMATION

Part Number	Rated Inductance (μH)	OCL nominal (μH) @20°C	Irms (max) (a)	Q min	DCR (Ω) max @ 20°C.	SRF typ (MHz)
UP0.4SC-1R0	1.0	1.0+/-20%	3.0	30 @ 200kHz	.040	250
UP0.4SC-1R5	1.5	1.5 +/-20%	2.8	30 @ 200kHz	.045	125
UP0.4SC-2R2	2.2	2.2+/-20%	1.8	40 @ 200kHz	.050	120
UP0.4SC-3R3	3.3	3.3+/-20%	1.6	40 @ 200kHz	.055	120
UP0.4SC-4R7	4.7	4.7+/-20%	1.4	40 @ 200kHz	.060	105
UP0.4SC-6R8	6.8	6.8+/-20%	1.2	40 @ 200kHz	.065	50
UP0.4SC-100	10.0	10.0+/-20%	1.0	40 @ 200kHz	.075	38
UP0.4SC-150	15.0	15.0+/-20%	0.80	40 @ 200kHz	.090	33
UP0.4SC-220	22.0	22.0+/-20%	0.70	40 @ 100kHz	.110	25
UP0.4SC-330	33.0	33.0+/-20%	0.60	40 @ 100kHz	.190	20
UP0.4SC-470	47.0	47.0+/-20%	0.50	40 @ 100kHz	.230	20
UP0.4SC-680	68.0	68.0+/-20%	0.40	40 @ 100kHz	.290	15
UP0.4SC-101	100	100+/-20%	0.30	40 @ 100kHz	.480	10
UP0.4SC-151	150	150+/-20%	0.26	40 @ 100kHz	.590	9
UP0.4SC-221	220	220+/-20%	0.22	40 @ 100kHz	.770	6
UP0.4SC-331	330	330+/-20%	0.20	40 @ 100kHz	1.4	5
UP0.4SC-471	470	470+/-20%	0.19	40 @ 100kHz	1.8	4
UP0.4SC-681	680	680+/-20%	0.18	40 @ 100kHz	2.2	3
UP0.4SC-102	1000	1000+/-20%	0.15	40 @ 100kHz	3.4	2
UP0.4SC-152	1500	1500+/-20%	0.12	50 @ 100kHz	4.2	2
UP0.4SC-222	2200	2200+/-20%	0.10	50 @ 100kHz	8.5	2
UP0.4SC-332	3300	3300+/-20%	0.08	50 @ 100kHz	11.0	1
UP0.4SC-472	4700	4700+/-20%	0.06	50 @ 100kHz	13.9	1
UP0.4SC-682	6800	6800+/-20%	0.04	50 @ 100kHz	25.0	1
UP0.4SC-103	10000	10000+/-20%	0.02	50 @ 100kHz	32.8	.08

Electrical Requirement Notes: 1) Test Frequency: 100KHz, 0.1V 2) DCR @ 20°C

This Document Is Subject To Change Without Notice.

General Specifications:

- a) Temp. Rise: 30°C typ at Irms
 - b) Operating Temp: -40°C -- +125°C
 - c) Storage Temp.: -25°C~+125°C
 - d) Resistance to Solder Heat: 260°C for 10 secs.
- Parts available in Tape and Reel. 13" diameter reel : 2,500 parts per reel.

Cooper Electronic Technologies

3601 Quantum Blvd, Boynton Beach, FL 33426
 Unipac 0.4SC (UP0.4SC) Inductor Line
 SMD, 2.92mm max ht, Shielded Drum core/header

Option Code (Suffix)	Description
-R	ROHS compliant Version

SIZE	Drawing Number:	UP0.4SC-R Inductor Line	
A	Revision Level:	B	Sheet 2 of 4