



Chipsmall Limited consists of a professional team with an average of over 10 year of expertise in the distribution of electronic components. Based in Hongkong, we have already established firm and mutual-benefit business relationships with customers from,Europe,America and south Asia,supplying obsolete and hard-to-find components to meet their specific needs.

With the principle of “Quality Parts,Customers Priority,Honest Operation,and Considerate Service”,our business mainly focus on the distribution of electronic components. Line cards we deal with include Microchip,ALPS,ROHM,Xilinx,Pulse,ON,Everlight and Freescale. Main products comprise IC,Modules,Potentiometer,IC Socket,Relay,Connector.Our parts cover such applications as commercial,industrial, and automotives areas.

We are looking forward to setting up business relationship with you and hope to provide you with the best service and solution. Let us make a better world for our industry!



Contact us

Tel: +86-755-8981 8866 Fax: +86-755-8427 6832

Email & Skype: info@chipsmall.com Web: www.chipsmall.com

Address: A1208, Overseas Decoration Building, #122 Zhenhua RD., Futian, Shenzhen, China



PRODUCT NUMBER	PITCH
V5xx31x100J0G	3.81mm

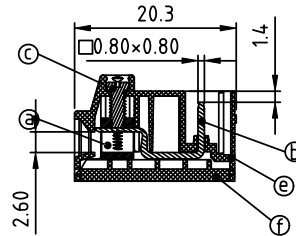
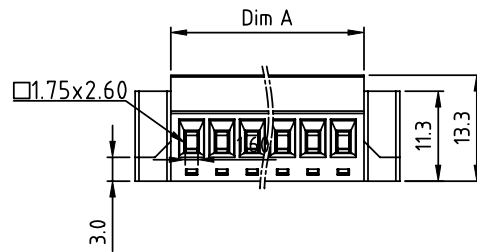
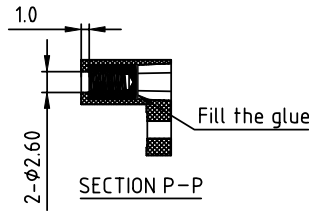
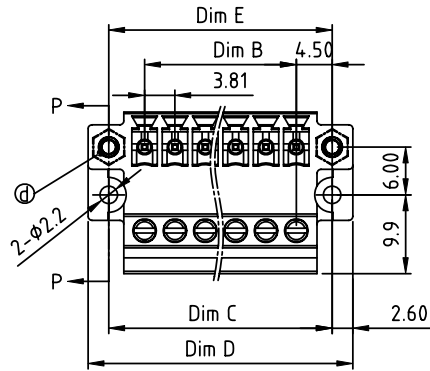

Material:

- Item① Clamp: Brass Ni plated
- Item② Pin: Brass, Tin plated.
- Item③ Terminal screw: Steel, Zinc plated
- Item④ With flange nut: Brass M2.5
- Item⑤ Terminal housing: Thermoplastic (UL94V-0)
- Item⑥ Terminal cover: Thermoplastic (UL94V-0)

Electrical: cULus

- Voltage rating: 300V
- Current rating: 8A
- Wire range:
- Solid wire(AWG):14-28
- Stranded wire(AWG):14-28
- Torque(Lb-In):2.17
- Screw: M2
- Wire strip length:6 mm
- Withstanding Voltage:1.6KV
- Operating temperature:-40°C to +115°C
- Safety Approval: cULus

N = Number of poles
 Dim A=Nx3.81+1.39
 Dim B=(N-1)x3.81
 Dim C=Nx3.81+5.19
 Dim D=Nx3.81+10.39
 Dim E=Nx3.81+5.19

Poles	Tolerance
2-6p	±0.15
7-12p	±0.20
13-18p	±0.30
19-24p	±0.35

PART NO.: V5 xx 31 x 1 00J0 G

Solid block		Color		RoHS compliant
No. of poles	2	Black (RAL9005)	2	Red (RAL3001/D)
	02	3 poles	3	Orange(RAL2011/P)
	03	...	4	Yellow(RAL1018/A)
	...	24 poles	5	Green(RAL6018/T)
	24		6	Blue (RAL5015/A)
			8	Grey(RAL7035/D)
			9	White(RAL1102)
			C	Green(RAL6018/U)

In copper Alloy

mat'l. code		surface ASME Y14.5	tolerance ASME Y14.5	projection	product family TERMINAL BLOCK
ltr	ecn no	dr	date	tolerances unless otherwise specified	title
				angles X±1°	TERMINAL BLOCK PLUGGABLE PLUG, WITH FLANGE BOTTOM COVER FIXED TYPE
				scale	MM
dr	EVIN ZHONG	050414			dwg no
enr	EVIN ZHONG	050414			sheet 1 of 1
chr	HANKE FENG	050414			size
appd	SHI JUN	050414			A4
sheet index	revision	A			V5xx31x100J0G
	sheet	1			type
					CUSTOMER Drawing