



Chipsmall Limited consists of a professional team with an average of over 10 year of expertise in the distribution of electronic components. Based in Hongkong, we have already established firm and mutual-benefit business relationships with customers from,Europe,America and south Asia,supplying obsolete and hard-to-find components to meet their specific needs.

With the principle of “Quality Parts,Customers Priority,Honest Operation,and Considerate Service”,our business mainly focus on the distribution of electronic components. Line cards we deal with include Microchip,ALPS,ROHM,Xilinx,Pulse,ON,Everlight and Freescale. Main products comprise IC,Modules,Potentiometer,IC Socket,Relay,Connector.Our parts cover such applications as commercial,industrial, and automotives areas.

We are looking forward to setting up business relationship with you and hope to provide you with the best service and solution. Let us make a better world for our industry!



## Contact us

Tel: +86-755-8981 8866 Fax: +86-755-8427 6832

Email & Skype: info@chipsmall.com Web: www.chipsmall.com

Address: A1208, Overseas Decoration Building, #122 Zhenhua RD., Futian, Shenzhen, China



	1	2	3	4	5	6	7																																																				
A								A																																																			
B								B																																																			
C								C																																																			
D								D																																																			
E								E																																																			
F								F																																																			
G	<p style="text-align: center;">Surface black anodized</p> <table border="1" style="width: 100%; border-collapse: collapse;"> <tr> <td style="width: 5%;">Scale</td> <td style="width: 10%;">FREE</td> <td style="width: 15%;"></td> <td style="width: 15%;"></td> <td style="width: 15%;"></td> <td style="width: 15%;"></td> <td style="width: 10%;">Date</td> <td style="width: 10%;">Name</td> <td style="width: 20%;">Customer-No.</td> </tr> <tr> <td colspan="2">TOLERANCE</td> <td></td> <td></td> <td></td> <td></td> <td>Drawn</td> <td>11.7.2012</td> <td>D. Šútorá</td> </tr> <tr> <td colspan="2" rowspan="3">ISO 2768-c</td> <td></td> <td></td> <td></td> <td></td> <td>Approved</td> <td>11.7.2012</td> <td>B. Dojčan</td> <td>ASSMANN WSW-No. V5583G</td> </tr> <tr> <td>①</td> <td>Change M2,5 to M3</td> <td>24.10.13</td> <td>A. Plate</td> <td colspan="2" rowspan="2" style="text-align: center;"> </td> <td>ASS_1848_HS</td> <td>rev01</td> </tr> <tr> <td>②</td> <td>Drawn</td> <td>11.7.2012</td> <td>D. Sutora</td> <td>Replace</td> <td>Sheet 1/1</td> </tr> <tr> <td></td> <td>Id.</td> <td>Modification</td> <td>Date</td> <td>Name</td> <td colspan="2"></td> <td></td> <td></td> </tr> </table>							Scale	FREE					Date	Name	Customer-No.	TOLERANCE						Drawn	11.7.2012	D. Šútorá	ISO 2768-c						Approved	11.7.2012	B. Dojčan	ASSMANN WSW-No. V5583G	①	Change M2,5 to M3	24.10.13	A. Plate			ASS_1848_HS	rev01	②	Drawn	11.7.2012	D. Sutora	Replace	Sheet 1/1		Id.	Modification	Date	Name					G
Scale								FREE					Date	Name	Customer-No.																																												
TOLERANCE						Drawn	11.7.2012	D. Šútorá																																																			
ISO 2768-c						Approved	11.7.2012	B. Dojčan	ASSMANN WSW-No. V5583G																																																		
		①	Change M2,5 to M3	24.10.13	A. Plate			ASS_1848_HS	rev01																																																		
		②	Drawn	11.7.2012	D. Sutora			Replace	Sheet 1/1																																																		
	Id.	Modification	Date	Name																																																							
H	<p style="text-align: center;"><b>RoHS compliant</b> Unit: mm</p>							H																																																			
	1	2	3	4	5	6	7																																																				

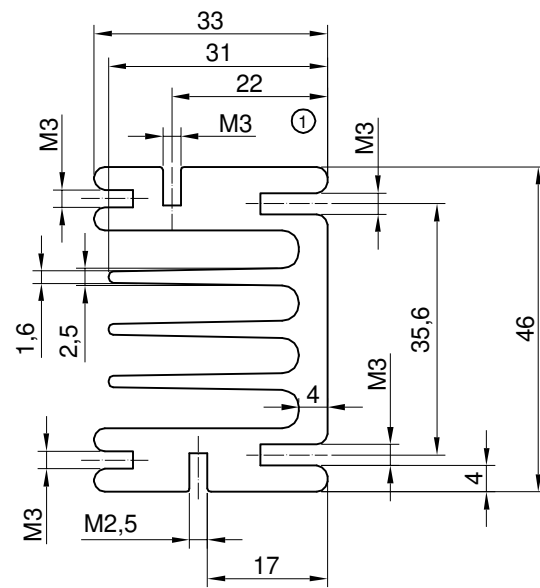
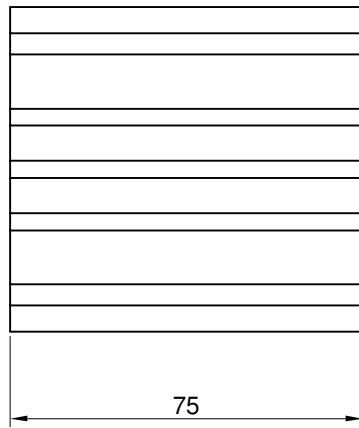

Surface black anodized

Scale	FREE					Date	Name	Customer-No.	
TOLERANCE						Drawn	11.7.2012	D. Šútorá	
ISO 2768-c						Approved	11.7.2012	B. Dojčan	ASSMANN WSW-No. V5583G
		①	Change M2,5 to M3	24.10.13	A. Plate			ASS_1848_HS	rev01
		②	Drawn	11.7.2012	D. Sutora			Replace	Sheet 1/1
	Id.	Modification	Date	Name					

**RoHS compliant**  
Unit: mm

