



Chipsmall Limited consists of a professional team with an average of over 10 year of expertise in the distribution of electronic components. Based in Hongkong, we have already established firm and mutual-benefit business relationships with customers from,Europe,America and south Asia,supplying obsolete and hard-to-find components to meet their specific needs.

With the principle of “Quality Parts,Customers Priority,Honest Operation,and Considerate Service”,our business mainly focus on the distribution of electronic components. Line cards we deal with include Microchip,ALPS,ROHM,Xilinx,Pulse,ON,Everlight and Freescale. Main products comprise IC,Modules,Potentiometer,IC Socket,Relay,Connector.Our parts cover such applications as commercial,industrial, and automotives areas.

We are looking forward to setting up business relationship with you and hope to provide you with the best service and solution. Let us make a better world for our industry!



## Contact us

Tel: +86-755-8981 8866 Fax: +86-755-8427 6832

Email & Skype: info@chipsmall.com Web: www.chipsmall.com

Address: A1208, Overseas Decoration Building, #122 Zhenhua RD., Futian, Shenzhen, China



1

2

3

4

5

6

7

A

B

C

D

E

F

G

H

A

B

C

D

E

F

G

H

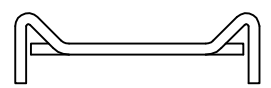
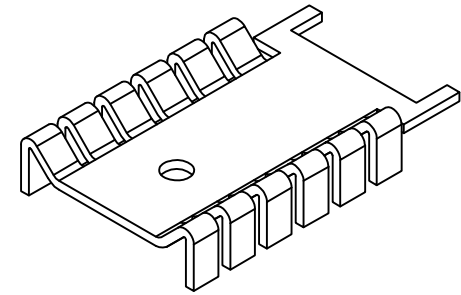
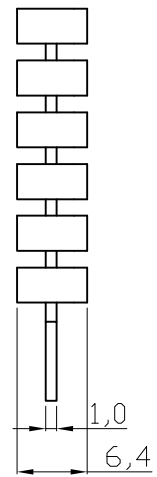
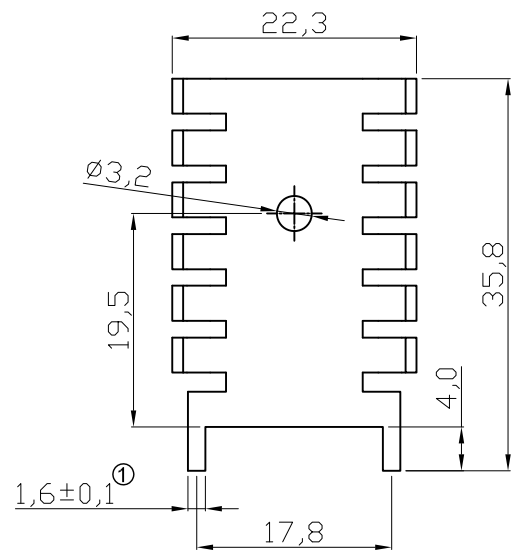
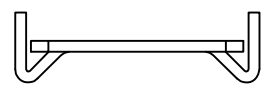

Notes  
Material: AL 1050,T=1.0mm

Option	Finish
V5641A-T	Black Anodized
② V5641B-T	Matte Tinned

**RoHS compliant**  
Unit:mm

Scale	Free					Date	Name	
TOLERANCE						Drawn	09.10.2010	Dean
UNIIT	0.25							
		③	Change production plant	23.09.2013	Amy	Approved	23.09.2013	Amy
		②	Update plating Type	19.06.2012	Lucas			
		①	Add tolerance	19.08.2011	Jason			
		④	Drawn	09.10.2010	Dean			
		Id.	Modification	Date	Name			

Customer-No.	
ASSMANN WSW-No.	V5641A-T V5641B-T
Drawing-No.	ASS 0989 HS
Replace	rev03
	Sheet

1

2

3

4

5

6

7