



Chipsmall Limited consists of a professional team with an average of over 10 year of expertise in the distribution of electronic components. Based in Hongkong, we have already established firm and mutual-benefit business relationships with customers from,Europe,America and south Asia,supplying obsolete and hard-to-find components to meet their specific needs.

With the principle of “Quality Parts,Customers Priority,Honest Operation,and Considerate Service”,our business mainly focus on the distribution of electronic components. Line cards we deal with include Microchip,ALPS,ROHM,Xilinx,Pulse,ON,Everlight and Freescale. Main products comprise IC,Modules,Potentiometer,IC Socket,Relay,Connector.Our parts cover such applications as commercial,industrial, and automotives areas.

We are looking forward to setting up business relationship with you and hope to provide you with the best service and solution. Let us make a better world for our industry!



Contact us

Tel: +86-755-8981 8866 Fax: +86-755-8427 6832

Email & Skype: info@chipsmall.com Web: www.chipsmall.com

Address: A1208, Overseas Decoration Building, #122 Zhenhua RD., Futian, Shenzhen, China



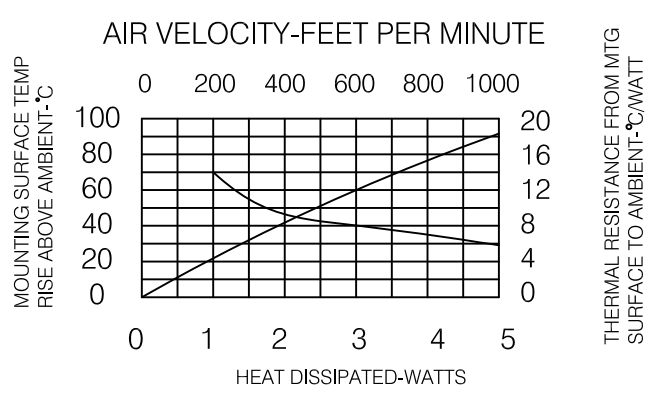
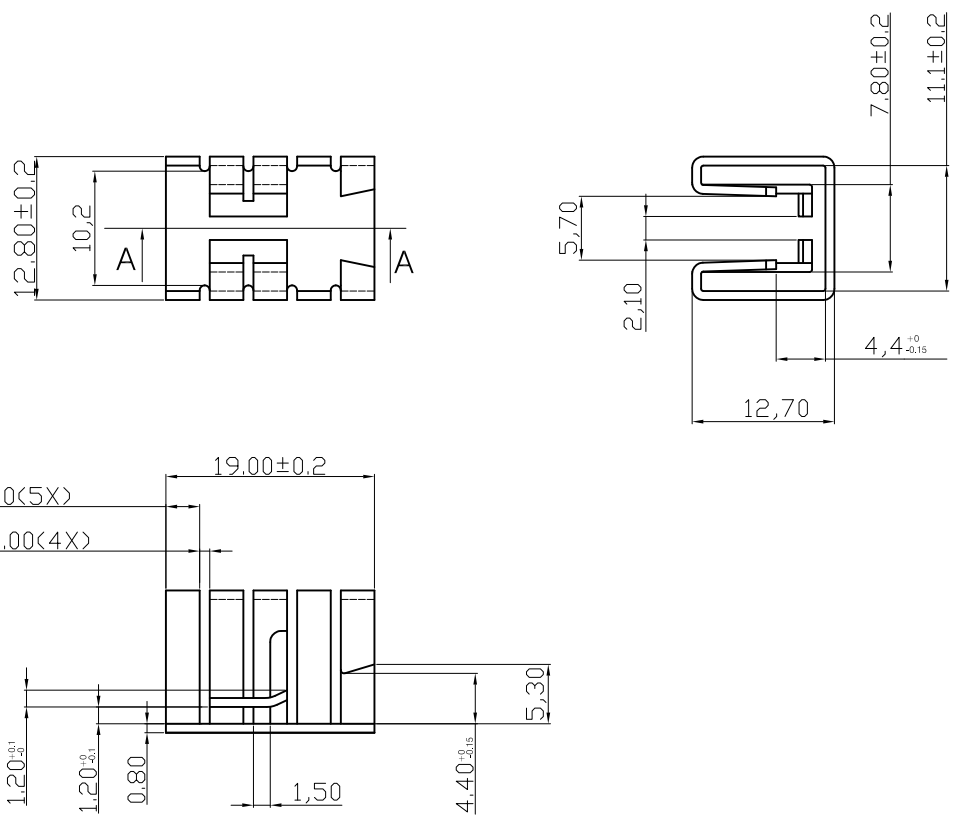

Notes
 Material : AL 5052 T=0.8±0.1 MM
 Finished : Black Anodize

RoHS compliant
 Unit: mm

Scale	FREE						Date	Name	Customer-No.
TOLERANCE						Drawn	22.07.2004	Hellwig	
Less 10	±0.15					Approved	07.06.2013	Amy	ASSMANN WSW-No.
10~30	±0.20	④	Update	07.06.2013	Amy				V8508A
31~50	±0.25	③	Modify drawing layout	10.03.2010	Alex				
51~100	±0.30	②	Update	11.08.2009	Dean				Drawing-No.
DIM	Tol	①	Drawn	22.07.2004	Hellwig				ASS 0387 HS
Angle	±1°	Id.	Modification	Date	Name				Replace