



Chipsmall Limited consists of a professional team with an average of over 10 year of expertise in the distribution of electronic components. Based in Hongkong, we have already established firm and mutual-benefit business relationships with customers from,Europe,America and south Asia,supplying obsolete and hard-to-find components to meet their specific needs.

With the principle of “Quality Parts,Customers Priority,Honest Operation,and Considerate Service”,our business mainly focus on the distribution of electronic components. Line cards we deal with include Microchip,ALPS,ROHM,Xilinx,Pulse,ON,Everlight and Freescale. Main products comprise IC,Modules,Potentiometer,IC Socket,Relay,Connector.Our parts cover such applications as commercial,industrial, and automotives areas.

We are looking forward to setting up business relationship with you and hope to provide you with the best service and solution. Let us make a better world for our industry!



## Contact us

Tel: +86-755-8981 8866 Fax: +86-755-8427 6832

Email & Skype: [info@chipsmall.com](mailto:info@chipsmall.com) Web: [www.chipsmall.com](http://www.chipsmall.com)

Address: A1208, Overseas Decoration Building, #122 Zhenhua RD., Futian, Shenzhen, China



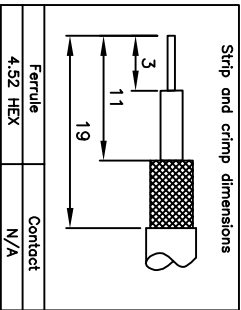
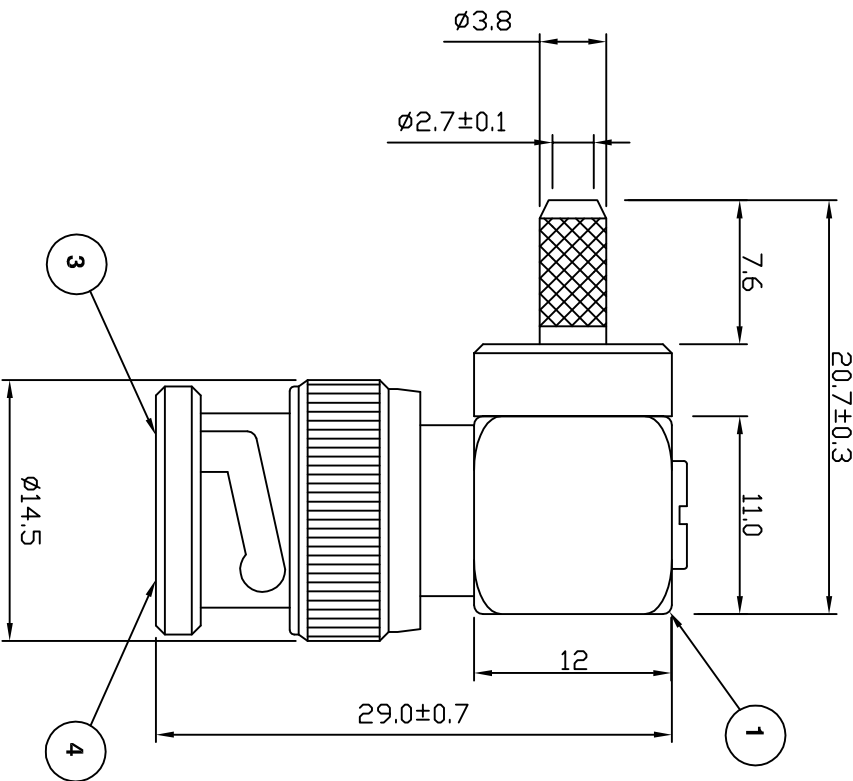
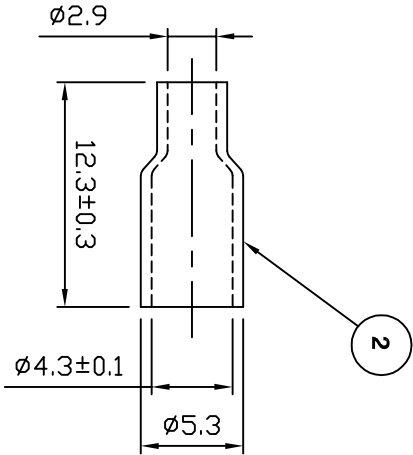

**Electrical Characteristics**

Nominal Impedance: 75 ohms  
Frequency Range: DC to 1 GHz  
VSWR: 1.3:1 maximum  
Insertion Loss: 0.2 dB at 1 GHz  
Operating Voltage (rms): 500 V maximum at sea level  
Dielectric Withstand Voltage (rms): 1500 V maximum at sea level  
Contact Resistance: 1.5 milliohms maximum  
Insulation Resistance: 5000 megohms minimum

**Mechanical Characteristics**

Mating Cycles: 500 cycles minimum  
Interface Dimensions: Conform to MIL-C-39012

**Environmental Characteristics**

Temperature Range: -65 °C to +165 °C

PART	DESCRIPTION
1	Body
2	Ferrule
3	Contact
4	Dielectric

Altered Address	KA	4	14 Aug 07
Changed Supplier	KA	3	03 Aug 07
CAD Issue	SN	2	19 Nov 01
First Issue	AT	1	25 Oct 94
DESCRIPTION OF REVISION	APPVD	ISS	DATE

PART NUMBER:

**VB20-2061**

PAGE: 1 of 1

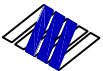

**Connectivity Solutions**  
7-13 Russel Way,  
Widford Industrial Estate,  
Chelmsford Essex,  
CM1 3AA, UK.  
Tel: +44 (0) 1245 359515  
Fax: +44 (0) 1245 358938

For stripping and assembly instructions see Drawing Number: VAIB2101