



Chipsmall Limited consists of a professional team with an average of over 10 year of expertise in the distribution of electronic components. Based in Hongkong, we have already established firm and mutual-benefit business relationships with customers from,Europe,America and south Asia,supplying obsolete and hard-to-find components to meet their specific needs.

With the principle of “Quality Parts,Customers Priority,Honest Operation,and Considerate Service”,our business mainly focus on the distribution of electronic components. Line cards we deal with include Microchip,ALPS,ROHM,Xilinx,Pulse,ON,Everlight and Freescale. Main products comprise IC,Modules,Potentiometer,IC Socket,Relay,Connector.Our parts cover such applications as commercial,industrial, and automotives areas.

We are looking forward to setting up business relationship with you and hope to provide you with the best service and solution. Let us make a better world for our industry!



Contact us

Tel: +86-755-8981 8866 Fax: +86-755-8427 6832

Email & Skype: info@chipsmall.com Web: www.chipsmall.com

Address: A1208, Overseas Decoration Building, #122 Zhenhua RD., Futian, Shenzhen, China



LAYOUT INSPECTION

69.85±0.2

2.80±0.2

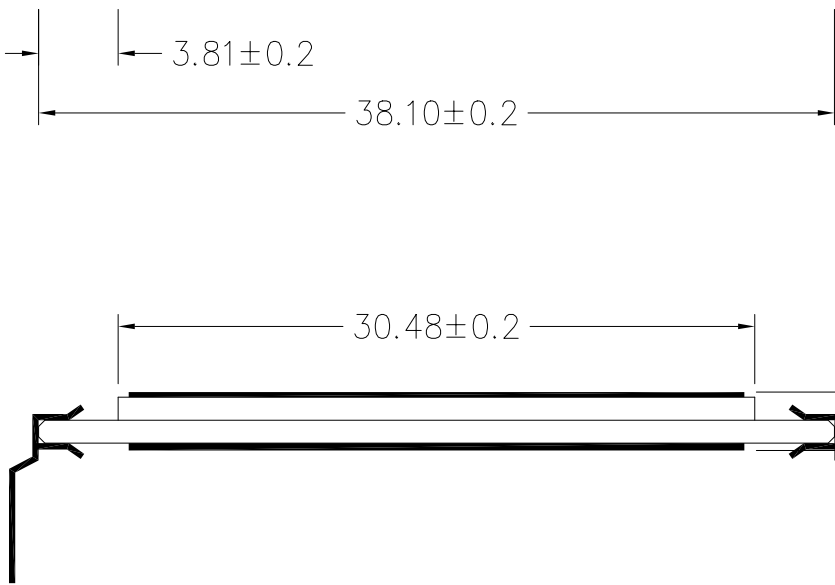
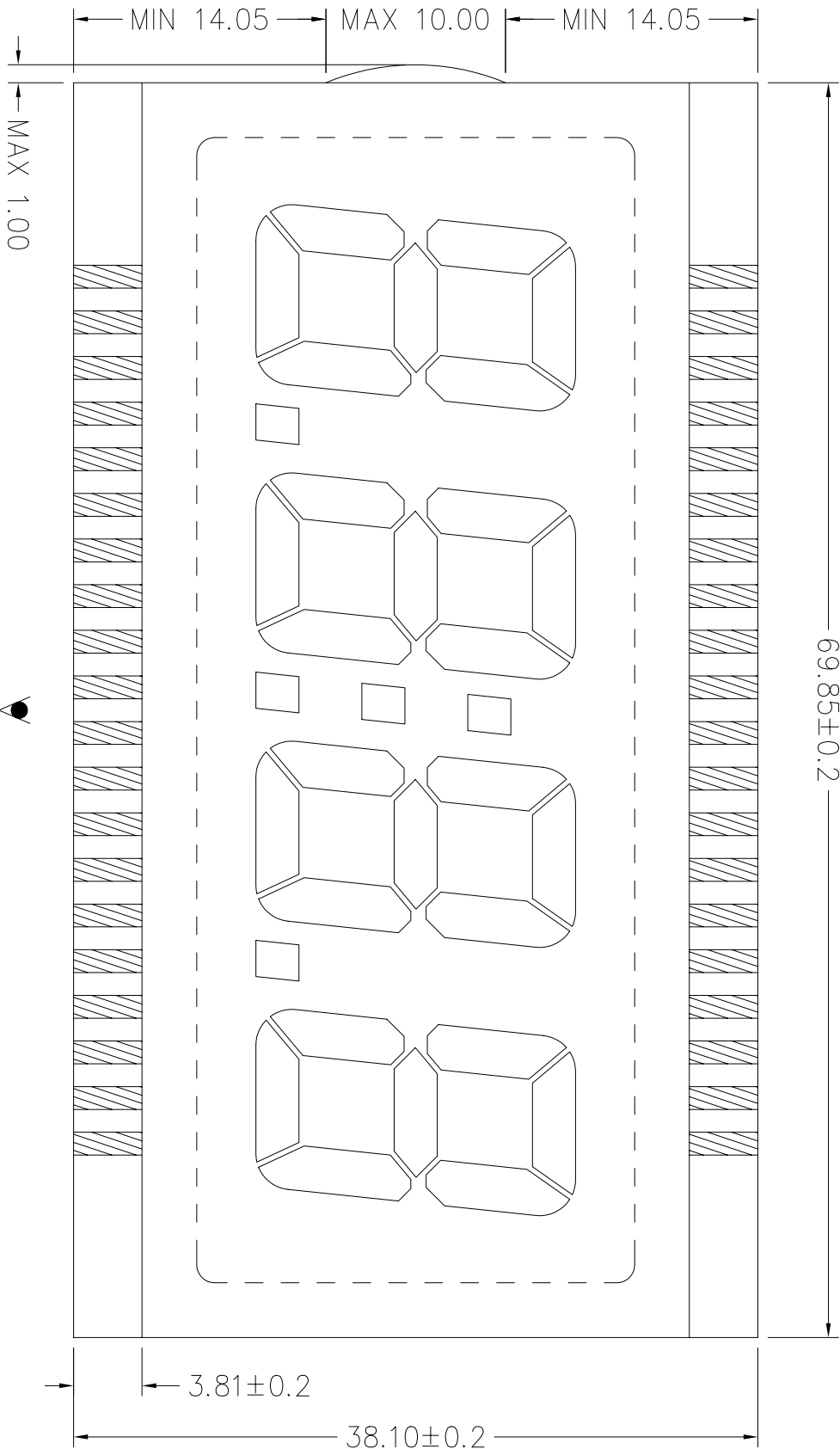

6

REMARKS: "◇" SPECIAL CHARACTERISTIC
 " + " SAFETY CHARACTERISTIC
 " () " REFERENCE ONLY

DWG NO : VI-415-1		REV : 10	
VARITRONIX LTD.		Dimension : mm	TOL : ±0.2 IF NOT SPECIFY
Drawn by : QMZ	SIGN :	DD NOT SCALE DRAWING	Date : 2004-11-29
Checked by : MAKD	SIGN :	Date :	3 rd ANGLE PROJECTION

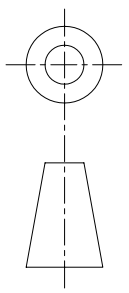

DWG.NO.: VI-415-1 (REV.0)

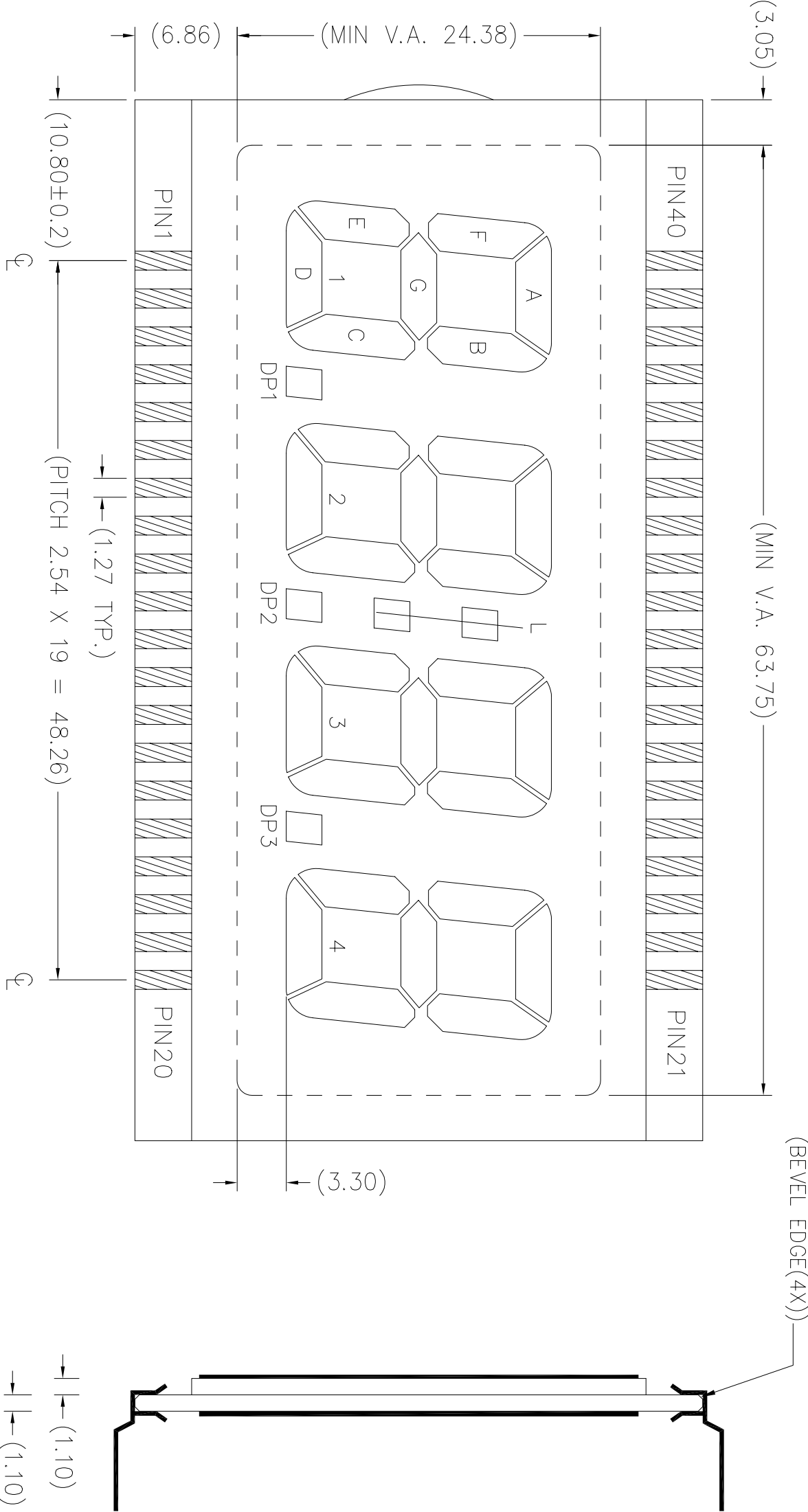

(BEVEL EDGE(4X))

(1.10)
(1.10)

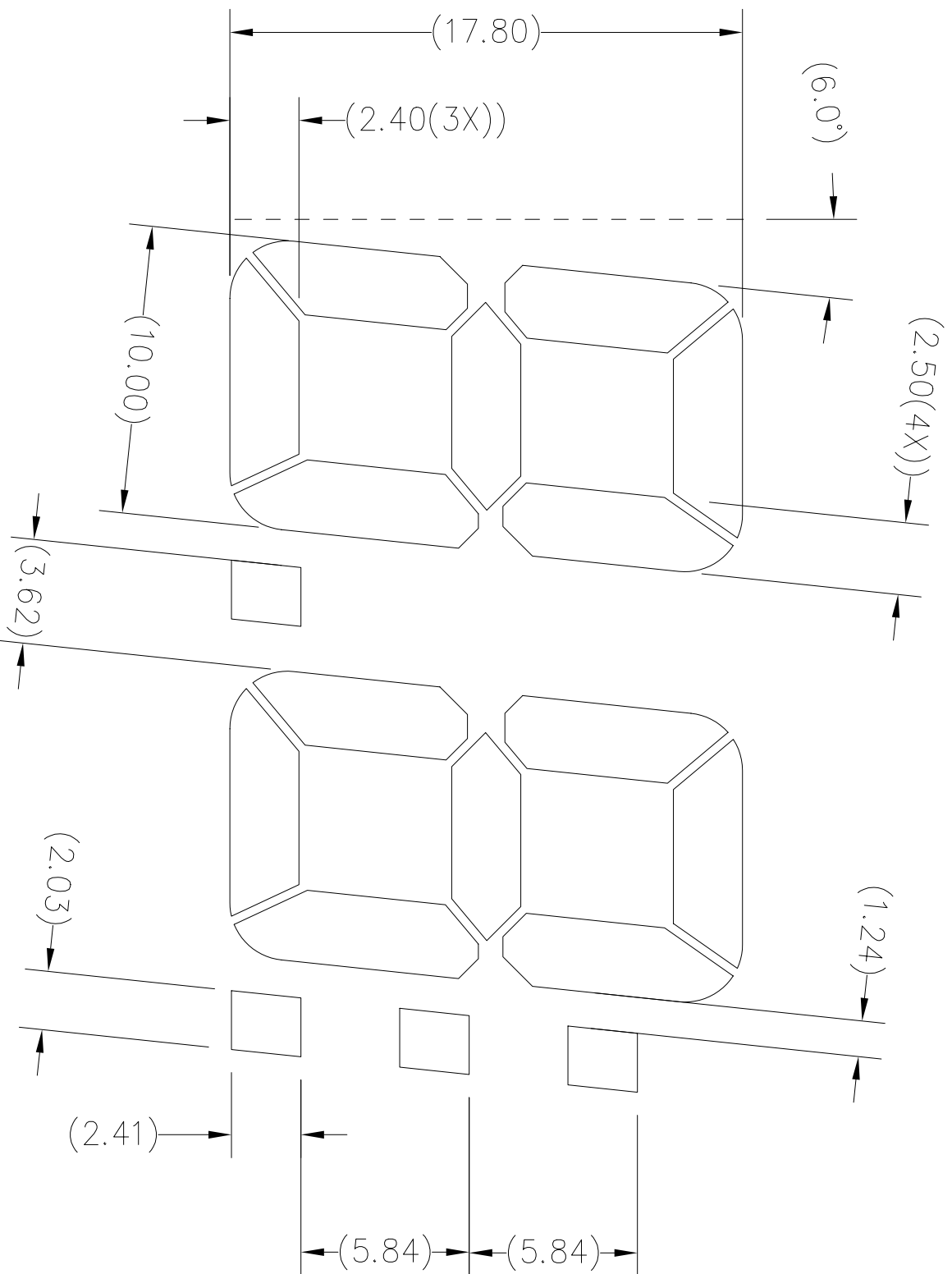

DWG.NO.: VI-415-1 (REV.0)

SEGMENT TRACKING

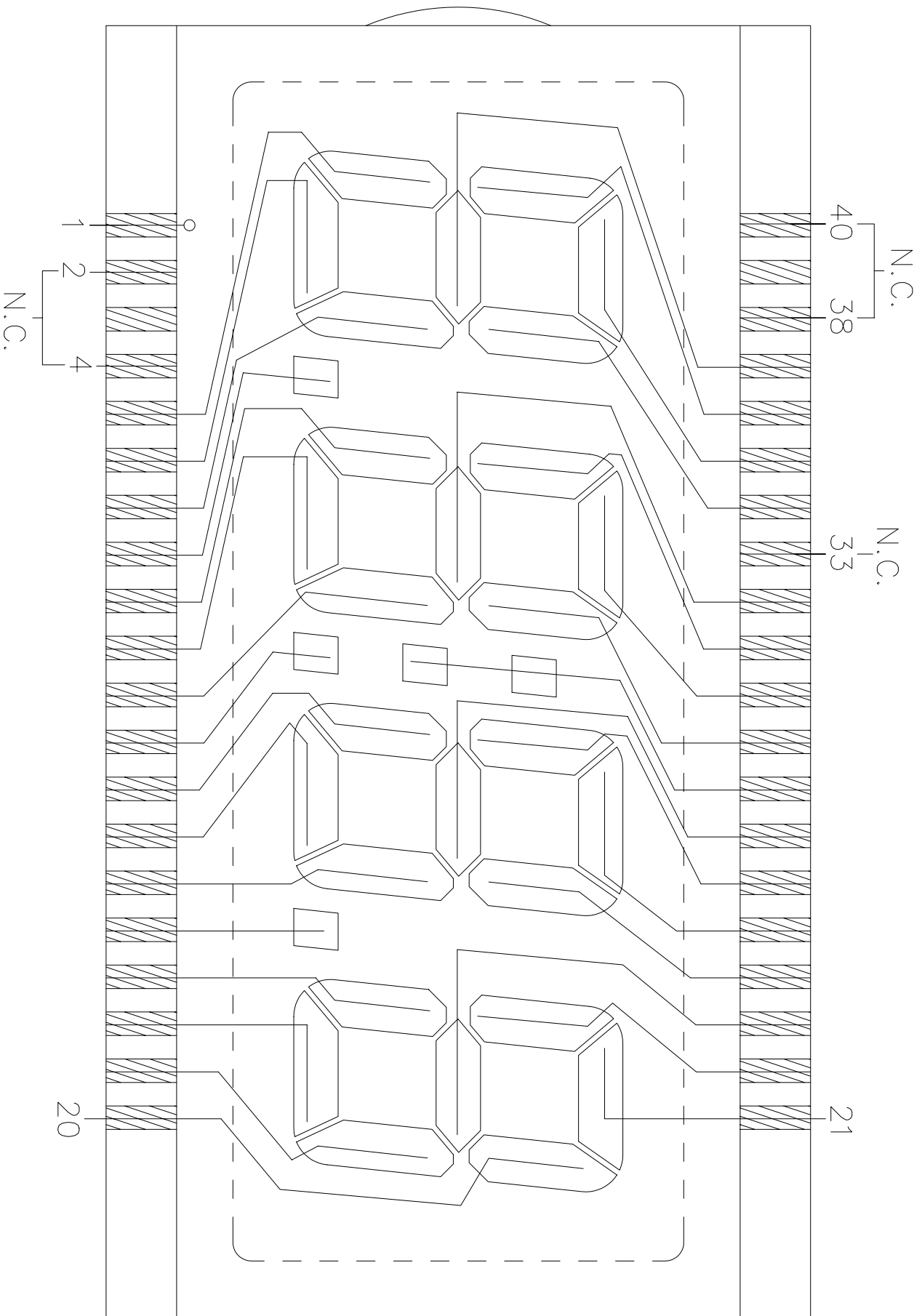

REMARKS: N.C. = NO CONNECTION

DWG.NO.: VI-415-1 (REV.0)

COMMON TRACKING

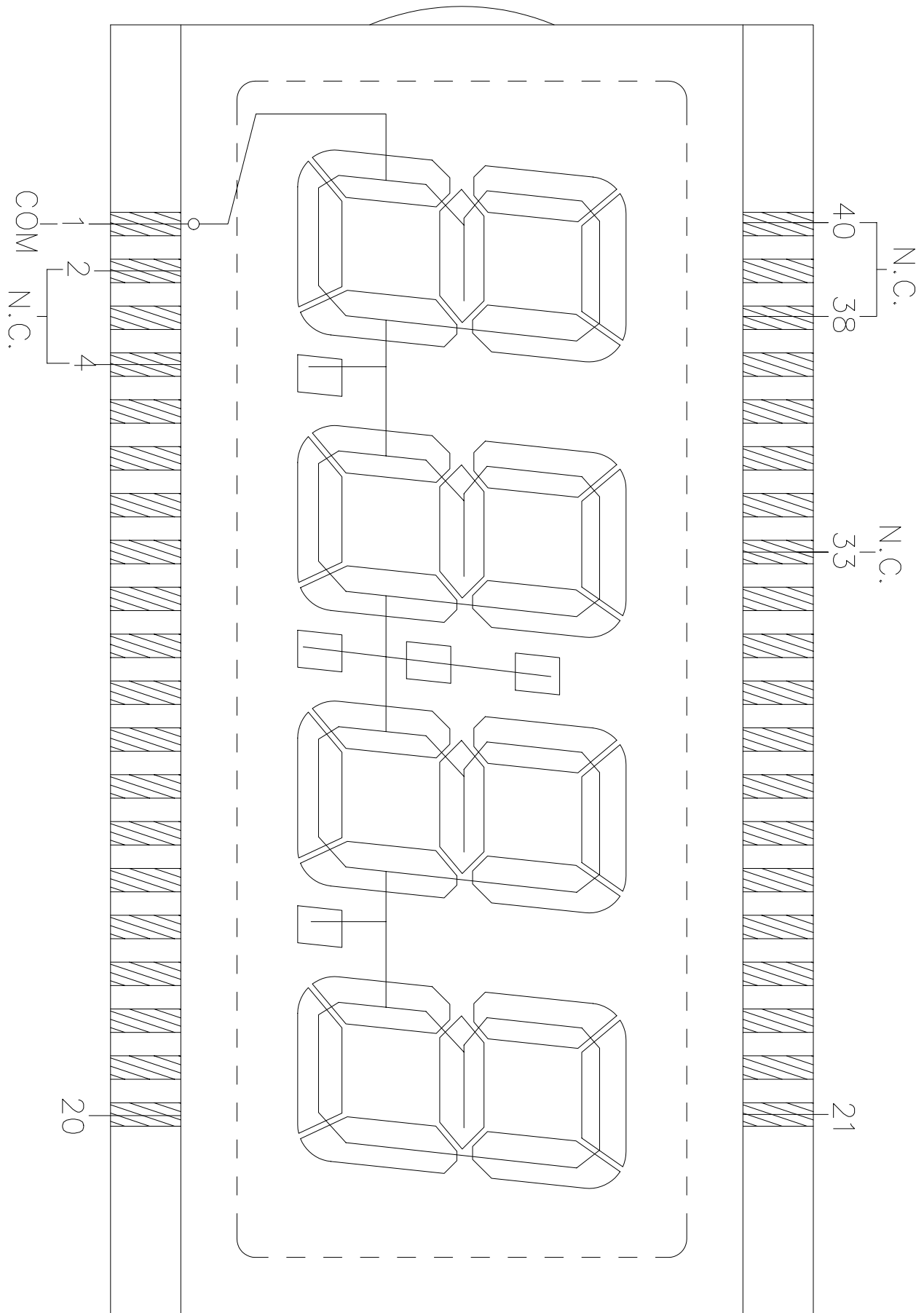

REMARKS : N.C. = NO CONNECTION

VARTRONIX LIMITED		OPEN LAYER :	SCALE
POLARIZER LOCATION DIAGRAM		P	Do not scale
DOC. NO. : PL-VI-415-1-01		Drawn by : QM/Z	Date : 2004-11-29
		Checked by : INA	Date :
		Approval by :	Date :

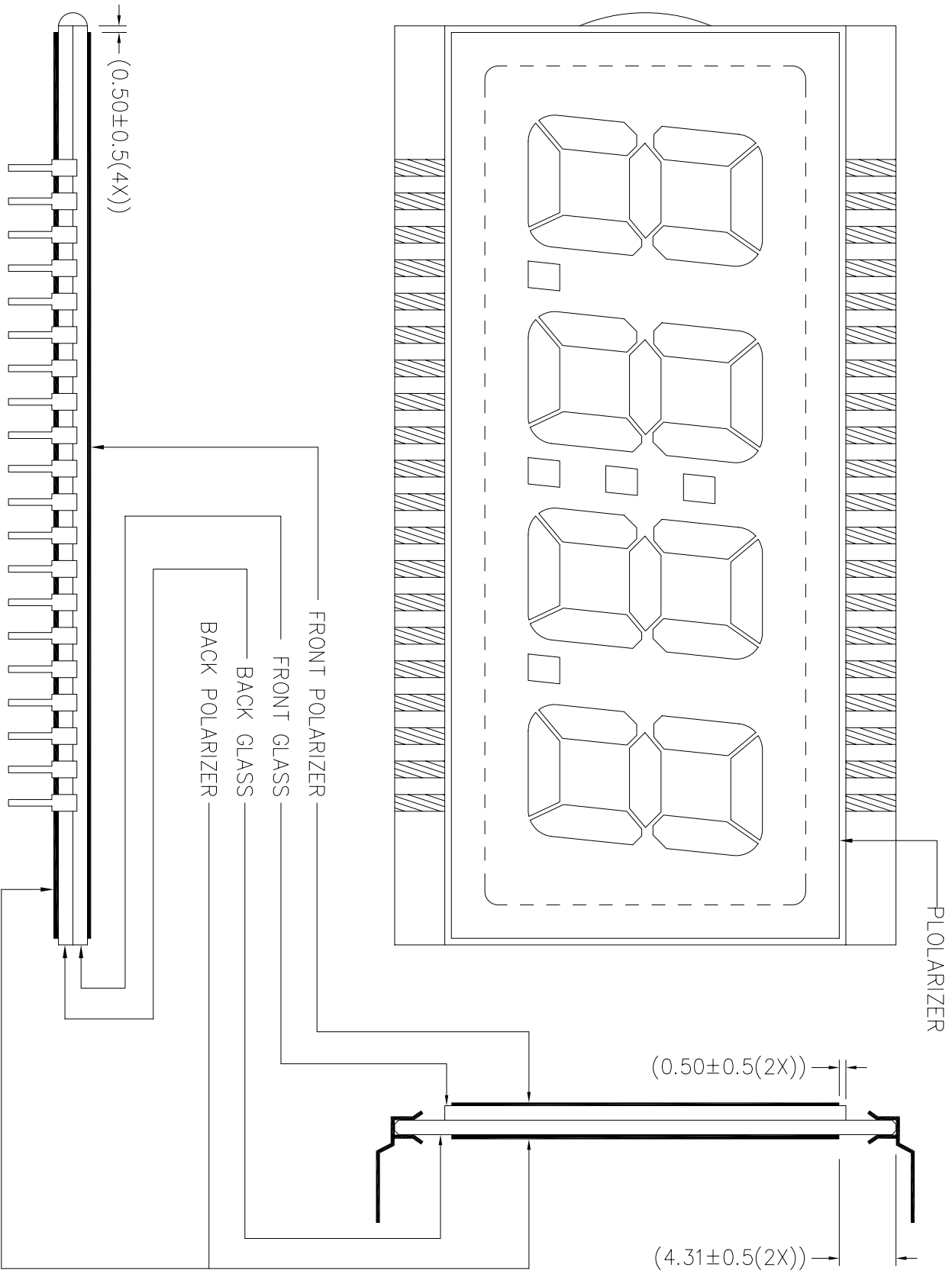

VARITRONIX LIMITED		OPEN LAYER :	SCALE
DIL-PIN DETAILS LOCATION DIAGRAM		DP-L0	Do not scale
DOC. NO. : DP-VI-415-1-01	Drawn by : QMZ	Checked by : INA	Date : 2004-11-29
ALL DIMENSIONS IN mm	Approval by :	Date :	

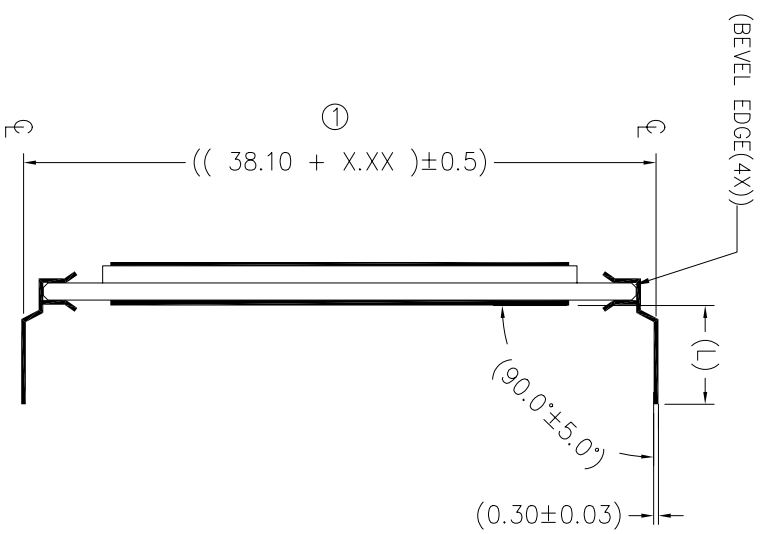
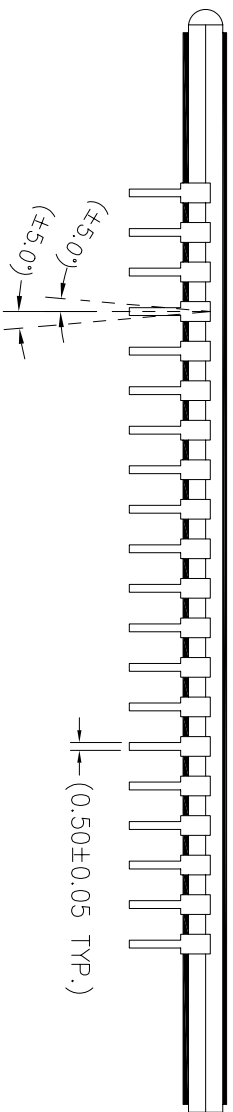
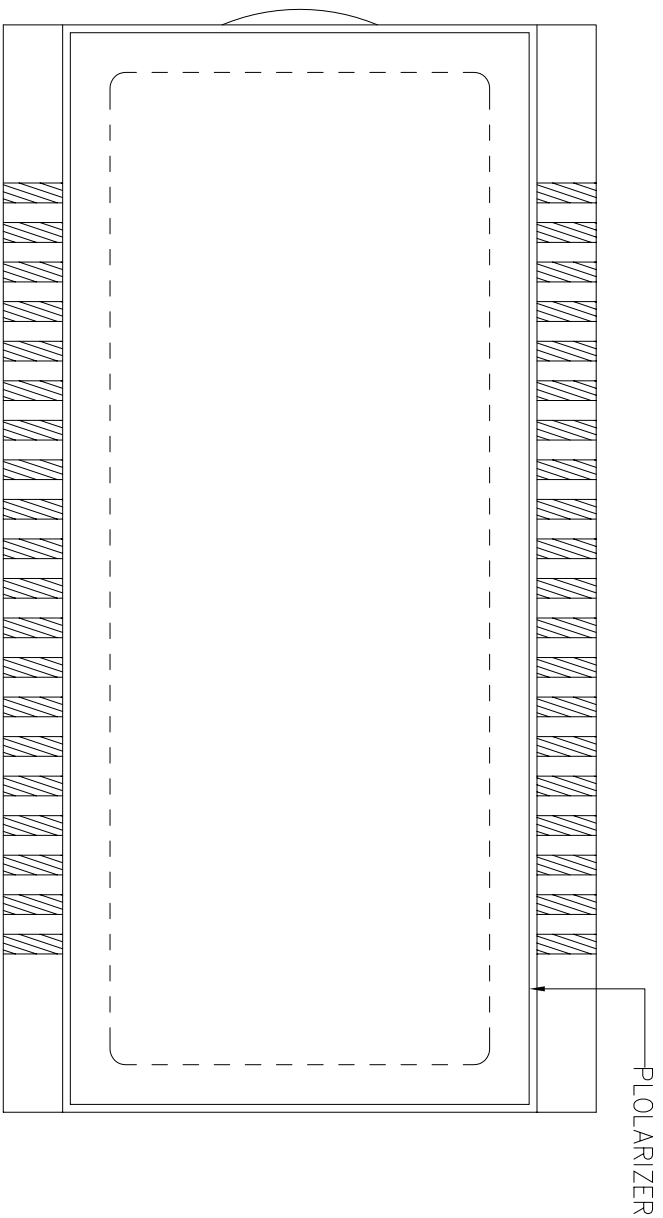

REMARKS: ① ----- X.XX=2.54 (FOR PIN LENGTH \geq 3.20 & \leq 10.00mm)
X.XX=1.75 (FOR PIN LENGTH $>$ 10.00 & \leq 19.50mm)
PIN LENGTH (L) REFER TO COVER PAGE

DWG.NO.: VI-415-1 (REV.0)

PIN	COM	PIN	COM	PIN	COM	PIN	COM
1	COM	11	2C	21	4A	31	2F
2	N.C.	12	DP2	22	4F	32	2G
3	N.C.	13	3E	23	4G	33	N.C.
4	N.C.	14	3D	24	3B	34	1B
5	1E	15	3C	25	3A	35	1A
6	1D	16	DP3	26	3F	36	1F
7	1C	17	4E	27	3G	37	1G
8	DP1	18	4D	28	L	38	N.C.
9	2E	19	4C	29	2B	39	N.C.
10	2D	20	4B	30	2A	40	N.C.

REMARKS: N.C. = NO CONNECTION