



Chipsmall Limited consists of a professional team with an average of over 10 year of expertise in the distribution of electronic components. Based in Hongkong, we have already established firm and mutual-benefit business relationships with customers from,Europe,America and south Asia,supplying obsolete and hard-to-find components to meet their specific needs.

With the principle of "Quality Parts,Customers Priority,Honest Operation,and Considerate Service",our business mainly focus on the distribution of electronic components. Line cards we deal with include Microchip,ALPS,ROHM,Xilinx,Pulse,ON,Everlight and Freescale. Main products comprise IC,Modules,Potentiometer,IC Socket,Relay,Connector.Our parts cover such applications as commercial,industrial, and automotives areas.

We are looking forward to setting up business relationship with you and hope to provide you with the best service and solution. Let us make a better world for our industry!



## Contact us

Tel: +86-755-8981 8866 Fax: +86-755-8427 6832

Email & Skype: info@chipsmall.com Web: www.chipsmall.com

Address: A1208, Overseas Decoration Building, #122 Zhenhua RD., Futian, Shenzhen, China



PRODUCT NUMBER	PITCH
VKxx12x000J0G	3.50 mm

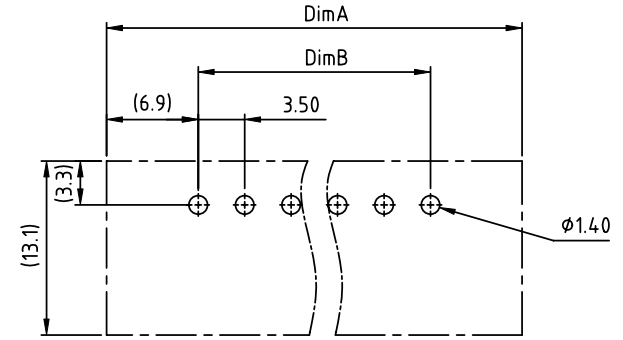
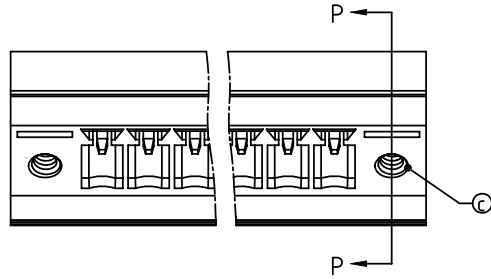

RECOMMENDED P.C.B. LAYOUT  
TOP VIEW

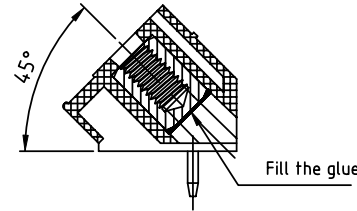
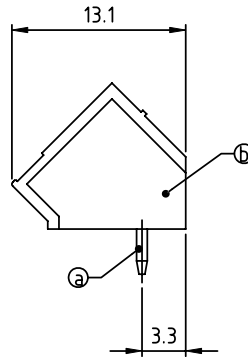
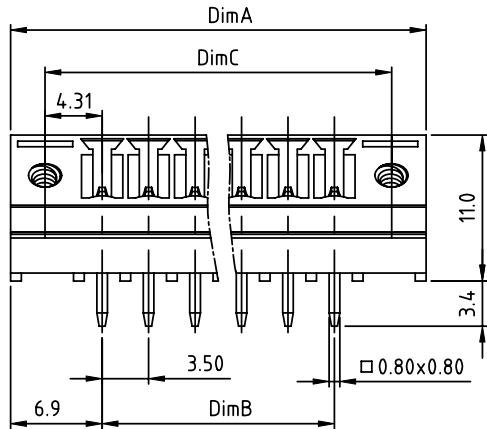

SECTION P-P

Material:

- Item (a) Male contact pin: Copper Tin plated
- Item (b) Terminal(housing): Thermoplastic (UL94V-0)
- Item (c) With flange nut: Brass ,M2.5

Electrical:

- Voltage rating: 300V/300V
- Current rating: 8A/10A
- Withstanding Voltage: 1.6 KV/2.5KV
- Operating temperature: -40°C to +115°C
- Soldering temperature: 260°C±5°C/5 Sec
- Safety Approval:

PART NO.: VK xx 12 x 0 00J0 G

$$\begin{aligned} \text{DimA} &= (N-1) \times 3.5 + 13.8 \\ \text{DimB} &= (N-1) \times 3.5 \\ \text{DimB} &= (N-1) \times 3.5 + 8.62 \end{aligned}$$

N= number of poles

Poles	Tolerance
2-6p	±0.15
7-12p	±0.20
13-18p	±0.25
19-24p	±0.30

Solid block	No. of poles	Color	RoHS compliant
0	2	Black (RAL9005)	(lead<4%) In copper Alloy
02	3	Red (RAL3001/D)	
03	4	Orange(RAL2011/P)	
...	...	Yellow(RAL1018/A)	
...	...	Green(RAL6018/T)	
24	6	Blue (RAL5015/A)	
	8	Grey(RAL7035/D)	
	9	White(RAL1102)	
	C	Green(RAL6018/U)	

mat'l. code				surface	tolerance	projection	product family
				ASME Y14.5	ASME Y14.5		TERMINAL BLOCK
itr ecn no dr date				tolerances unless otherwise specified		MM	title
				angles	X.±0.5		TERMINAL BLOCK
				±	X.X±0.3		PLUGGABLE SOCKET,45DEGREE INLET,WITH FLANGE
				X*±1"	X.XX±0.1	scale	dwg no
				dr	EVIN ZHONG 042214		sheet 1 of 1
				enr	EVIN ZHONG 042214		size
				chr	HANKE FENG 042214		VKxx12x000J0G
				appd	SHI JUN 042214		A4
							type
							CUSTOMER Drawing
sheet index	revision	A					
	sheet	1					