



Chipsmall Limited consists of a professional team with an average of over 10 year of expertise in the distribution of electronic components. Based in Hongkong, we have already established firm and mutual-benefit business relationships with customers from,Europe,America and south Asia,supplying obsolete and hard-to-find components to meet their specific needs.

With the principle of "Quality Parts,Customers Priority,Honest Operation,and Considerate Service",our business mainly focus on the distribution of electronic components. Line cards we deal with include Microchip,ALPS,ROHM,Xilinx,Pulse,ON,Everlight and Freescale. Main products comprise IC,Modules,Potentiometer,IC Socket,Relay,Connector.Our parts cover such applications as commercial,industrial, and automotives areas.

We are looking forward to setting up business relationship with you and hope to provide you with the best service and solution. Let us make a better world for our industry!



Contact us

Tel: +86-755-8981 8866 Fax: +86-755-8427 6832

Email & Skype: info@chipsmall.com Web: www.chipsmall.com

Address: A1208, Overseas Decoration Building, #122 Zhenhua RD., Futian, Shenzhen, China



PRODUCT NUMBER	PITCH
VQxx31x100J0G	3.81mm

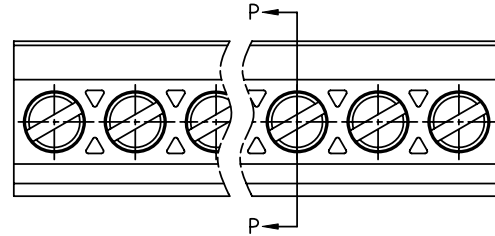

Diameter of metal-plated hole: $\phi 1.0 \pm 0.05$

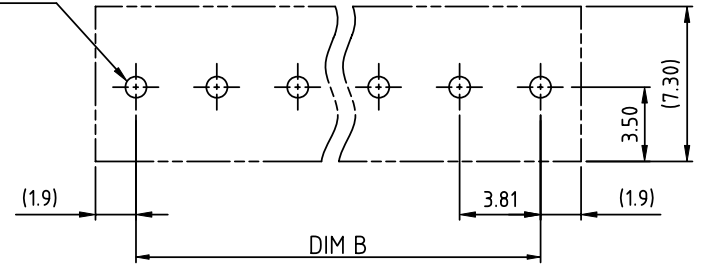

RECOMMENDED P.C.B LAYOUT
TOP VIEW

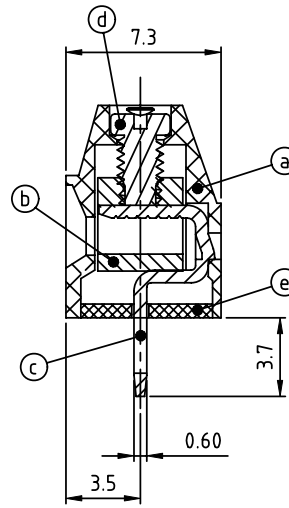
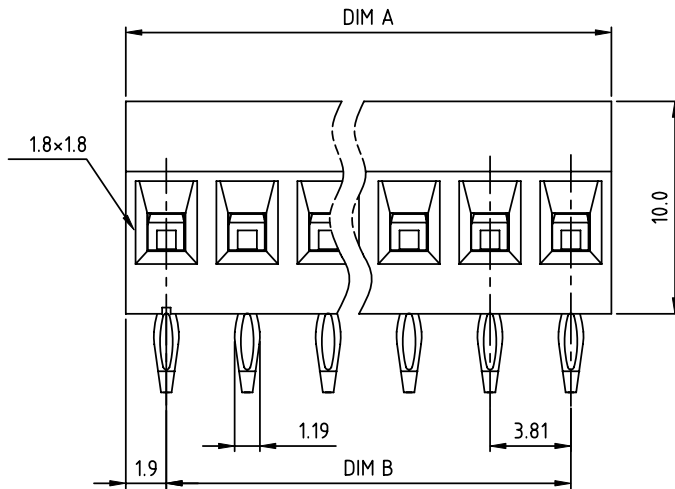

SECTION P-P

Material:

- Item (a) Terminal housing : Thermoplastic (UL 94V-0)
- Item (b) Clamp : Brass, Ni plated
- Item (c) solder pin : Brass, Tin plated
- Item (d) Terminal screw: Steel Zinc plating"-slot type
- Item (e) Terminal housing (cover): Thermoplastic (UL 94V-0)

Electrical: cULus

- Voltage rating: 300V
- Current rating: 10A
- Wire range:
 - Solid wire(AWG): 16-30
 - Stranded wire(AWG): 16-30
- Torque: 1.7 Lb-In
- Diameter of metal - plated hole : $\phi 1.0$
- Screw: M2
- Wire strip length: 5-6mm
- Withstanding Voltage: 1.6 KV
- Operating temperature: -40°C to +115°C
- Soldering temperature: 260°C \pm 5°C/5 Sec
- Safety Approval:

N= Number of poles

DIM A	Nx3.81
DIM B	(N-1)x3.81

Poles	Tolerance
2p-6p	± 0.15
7p-12p	± 0.25
13p-19p	± 0.35
20p-24p	± 0.40

PART NO.: VQ xx 3 1 x 1 00J0 G

- | | | | |
|--------------|----------|---------------------|--|
| Solid Block | 0 | Black (RAL9005) | RoHS compliant
(lead<4%)
In copper Alloy |
| No. of poles | 2 | Red (RAL3001/D) | |
| 02 | 2 poles | 3 Orange(RAL2011/P) | |
| 03 | 3 poles | 4 Yellow(RAL1018/A) | |
| ... | ... | 5 Green(RAL6018/T) | |
| 24 | 24 poles | 6 Blue (RAL5015/A) | |
| | | 8 Grey(RAL7035/D) | |
| | | 9 White(RAL1102) | |
| | | C Green(RAL6018/U) | |

mat'l. code		surface ASME Y14.5	tolerance ASME Y14.5	projection	product family TERMINAL BLOCK
ltr	ecn no	dr	date		title
				tolerances unless otherwise specified	TERMINAL BLOCK
				angles ϕ	RISING CLAMP, 180D WIRE INLET, PRESS FIT
				$X \pm 1^*$	scale
				dr	dwg no
				ENGR	sheet 1 of 1
				chr	size
				appd	VQxx31x100J0G
					A4
					type
					CUSTOMER Drawing
sheet index	revision	A			
	sheet	1			