



Chipsmall Limited consists of a professional team with an average of over 10 year of expertise in the distribution of electronic components. Based in Hongkong, we have already established firm and mutual-benefit business relationships with customers from,Europe,America and south Asia,supplying obsolete and hard-to-find components to meet their specific needs.

With the principle of “Quality Parts,Customers Priority,Honest Operation,and Considerate Service”,our business mainly focus on the distribution of electronic components. Line cards we deal with include Microchip,ALPS,ROHM,Xilinx,Pulse,ON,Everlight and Freescale. Main products comprise IC,Modules,Potentiometer,IC Socket,Relay,Connector.Our parts cover such applications as commercial,industrial, and automotives areas.

We are looking forward to setting up business relationship with you and hope to provide you with the best service and solution. Let us make a better world for our industry!



## Contact us

Tel: +86-755-8981 8866 Fax: +86-755-8427 6832

Email & Skype: info@chipsmall.com Web: www.chipsmall.com

Address: A1208, Overseas Decoration Building, #122 Zhenhua RD., Futian, Shenzhen, China



PRODUCT NUMBER	PITCH
VSxx52x000J0G	5.08 mm

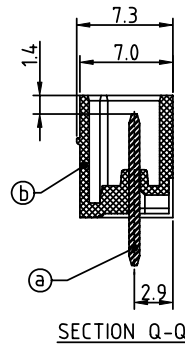
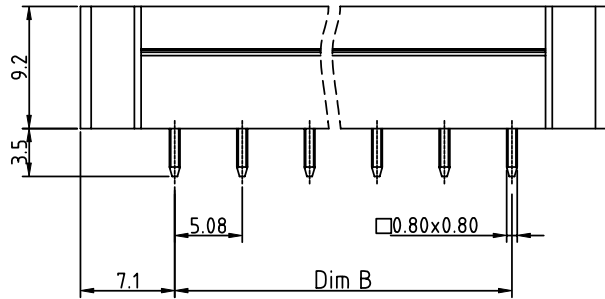
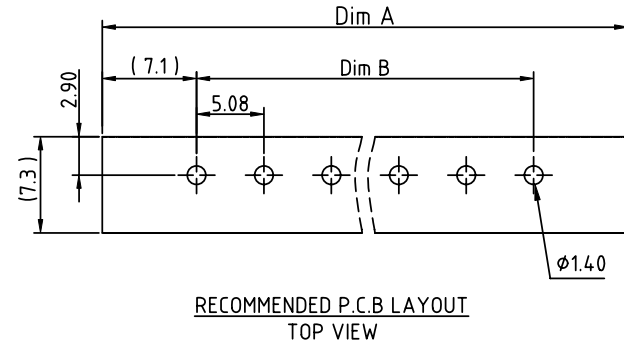
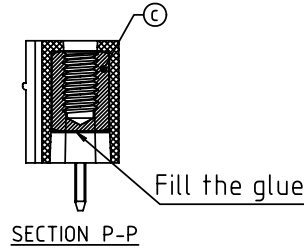
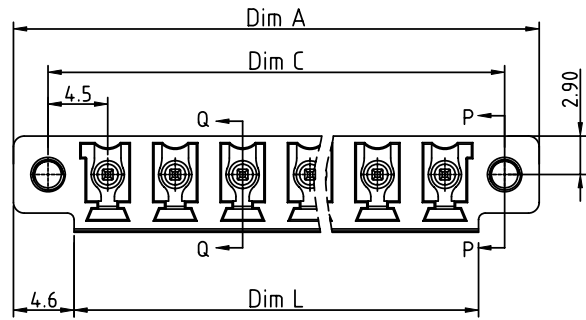

- Material:
- Item ① Male contact pin: Copper, Tin plated
  - Item ② Terminal(housing): Thermoplastic (UL94V-0)
  - Item ③ With flange nut: Brass ,M2.5
- Electrical:
- Voltage rating: 300V
  - Current rating: 10A
  - Withstanding Voltage: 1.6 KV
  - Operating temperature: -40°C to +115°C
  - Soldering temperature: 260°C±5°C/5 Sec
  - Safety Approval:

N = Number of poles  
 Dim L=Nx5.08  
 Dim A=(N-1)x5.08+14.2  
 Dim B=(N-1)x5.08  
 Dim C=(N-1)x5.08+9.0

Poles	Tolerance
2-5p	±0.15
6-10p	±0.25
11-15p	±0.30
16-24p	±0.40

PART NO.: VS xx 52 x 0 00J0 G

Solid block	0	Color		RoHS compliant
No. of poles	2			(lead<4%)
02 2 poles	3	Black (RAL9005)		In copper Alloy
03 3 poles	4	Red (RAL3001/D)		
...	5	Orange(RAL2011/P)		
24 24 poles	6	Yellow(RAL1018/A)		
	8	Green(RAL6018/T)		
	9	Blue (RAL5015/A)		
	9	Grey(RAL7035/D)		
	9	White(RAL1102)		
	C	Green(RAL6018/U)		

mat'l. code		surface	tolerance	projection	product family
ltr ecn no dr date		ASME Y14.5	ASME Y14.5		TERMINAL BLOCK
		tolerances unless otherwise specified		MM	title
		angles	X.±0.5		TERMINAL BLOCK
		$X^{\circ} \pm 1'$	X.X±0.3	scale	PLUGGABLE SOCKET, VERTICAL, WITH FLANGE
		dr	EVIN ZHONG 042214		dwg no
		enr	EVIN ZHONG 042214		sheet 1 of 1
		chr	HANKE FENG 042214		size
		appd	SHI JUN 042214		A4
					VSxx52x000J0G
				type	CUSTOMER Drawing
sheet index	revision	A			
	sheet	1			