



Chipsmall Limited consists of a professional team with an average of over 10 year of expertise in the distribution of electronic components. Based in Hongkong, we have already established firm and mutual-benefit business relationships with customers from,Europe,America and south Asia,supplying obsolete and hard-to-find components to meet their specific needs.

With the principle of "Quality Parts,Customers Priority,Honest Operation,and Considerate Service",our business mainly focus on the distribution of electronic components. Line cards we deal with include Microchip,ALPS,ROHM,Xilinx,Pulse,ON,Everlight and Freescale. Main products comprise IC,Modules,Potentiometer,IC Socket,Relay,Connector.Our parts cover such applications as commercial,industrial, and automotives areas.

We are looking forward to setting up business relationship with you and hope to provide you with the best service and solution. Let us make a better world for our industry!



Contact us

Tel: +86-755-8981 8866 Fax: +86-755-8427 6832

Email & Skype: info@chipsmall.com Web: www.chipsmall.com

Address: A1208, Overseas Decoration Building, #122 Zhenhua RD., Futian, Shenzhen, China



THIS COPY IS PROVIDED ON A RESTRICTED BASIS AND IS NOT TO BE USED IN ANY WAY DETRIMENTAL TO THE INTERESTS OF PANDUIT CORP.

PANDUIT PART NUMBER *	WEIGHT lbs/100 pcs (g)/100 pcs	MAXIMUM BUNDLE CAPACITY	PANEL DIMENSIONS	
			THICKNESS	HOLE SIZE
VWS106----	0.397 (180)	1.06 (26.9)	UP TO 0.090 (UP TO 2.29)	0.187 (4.76)

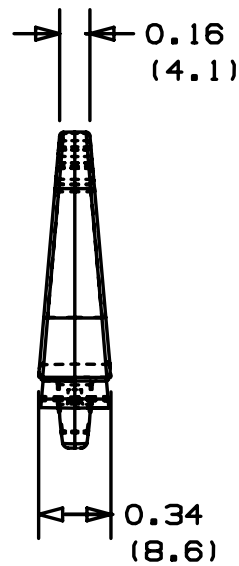
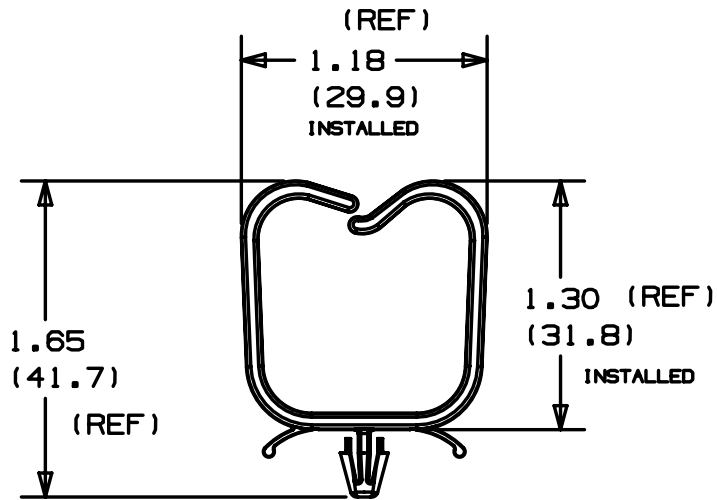

- NOTES:
* 1. SEE CURRENT PRICE SHEET FOR PART NUMBER SUFFIX DESIGNATION FOR PACKAGE SIZE.
2. -20 MATERIAL DESIGNATION IS PIGMENTED BLACK

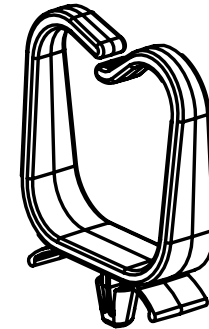

DIMENSIONS IN BRACKETS ARE METRIC [mm]

CAD FILENAME/LAYERS G01332BB_PB_VWS106_03

PANDUIT CORP. TINLEY PARK, ILLINOIS

VWS106-
VERTICAL WIRE SADDLE

UNLESS OTHERWISE SPECIFIED,
DIMENSIONAL TOLERANCES ARE:
(.X) ±0.05 (1.3) (.XXX) ±0.010 (0.25)
(.XX) ±0.02 (0.5) ANGLES ± 5°

UNLESS OTHERWISE SPECIFIED,
ALL DIMENSIONS ARE GIVEN
IN INCHES, THIRD ANGLE PROJECTION.

DRAWN BY JAD MAT'L:

SCALE NONE

DATE 7-24-97

NYLON 6/6

DRAWING NO.

GB1332BB

DWG
A
SIZE

REV	DATE	BY	CHK	DESCRIPTION	ECN	R	CUST	SUP
3	7-03-01	LGG		UPDATED AND ADDED REF	G01332BB	3		
2	4-21-98	MLD		DIM 0.34 (8.6) WAS 0.36 (9.1)	G01332BB	2		
1	7-29-97	JAD		MAX PANEL THICKNESS CHANGED FROM .105 TO .090. ADDED 1.18 DIM, ADDED 'INSTALLED' TO 1.3 DIM.	G01332BB	1		
R	7-24-97	JAD		INITIAL RELEASE	G01332BB	R		