



Chipsmall Limited consists of a professional team with an average of over 10 year of expertise in the distribution of electronic components. Based in Hongkong, we have already established firm and mutual-benefit business relationships with customers from,Europe,America and south Asia,supplying obsolete and hard-to-find components to meet their specific needs.

With the principle of “Quality Parts,Customers Priority,Honest Operation,and Considerate Service”,our business mainly focus on the distribution of electronic components. Line cards we deal with include Microchip,ALPS,ROHM,Xilinx,Pulse,ON,Everlight and Freescale. Main products comprise IC,Modules,Potentiometer,IC Socket,Relay,Connector.Our parts cover such applications as commercial,industrial, and automotives areas.

We are looking forward to setting up business relationship with you and hope to provide you with the best service and solution. Let us make a better world for our industry!



Contact us

Tel: +86-755-8981 8866 Fax: +86-755-8427 6832

Email & Skype: info@chipsmall.com Web: www.chipsmall.com

Address: A1208, Overseas Decoration Building, #122 Zhenhua RD., Futian, Shenzhen, China



SPECIFICATION CONTROL DRAWING

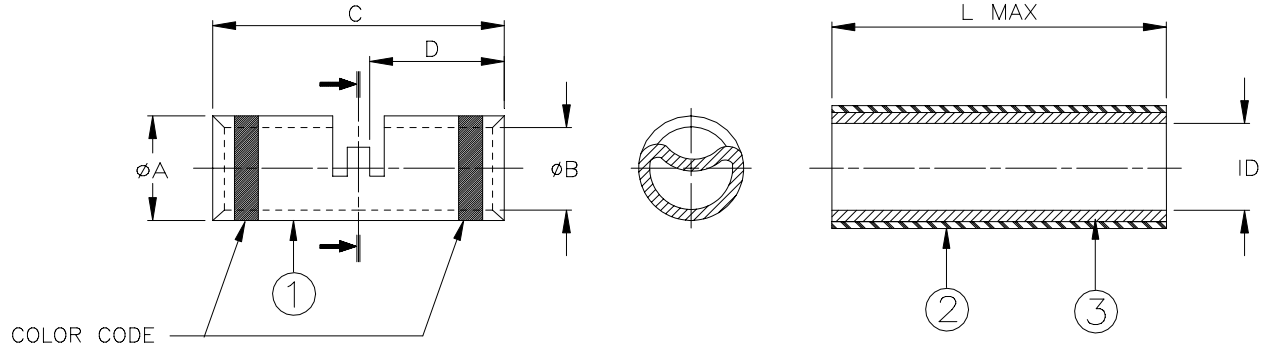

| Product Revision | | Crimp Splice | | | | | | Sealing Sleeve | | |
|------------------|---|-------------------------------|-------------------------------|-------------------------------|-------------------------------|--|------------|-----------------|-----------------|------------------|
| Product Name | C | ϕA | ϕB | C | D | Size Range mm ² (CMA) | Color Code | I.D.* | | L max |
| | | ± 0.08 (± 0.003) | ± 0.05 (± 0.002) | ± 0.25 (± 0.001) | ± 0.25 (± 0.001) | | | min (a) | max (b) | |
| W-096-01 | C | 1.97 (0.076) | 1.20 (0.047) | 12.70 (0.500) | 5.97 (0.235) | 0.15 to 0.75 (304 – 1510) | red | 3.30 (0.130) | 0.00 | 38.00 (1.500) |
| W-096-02 | C | 2.62 (0.103) | 1.70 (0.067) | 14.60 (0.575) | 6.86 (0.270) | 0.39 to 1.34 (779 – 2680) | blue | 3.30 (0.130) | 0.00 | 38.00 (1.500) |
| W-096-03 | C | 3.81 (0.150) | 2.54 (0.100) | 14.60 (0.575) | 6.86 (0.270) | 0.95 to 3.37 (1900 – 6755) | yellow | 4.80 (0.189) | 1.80 (0.071) | 38.00 (1.500) |

* I.D.: (a) As received; (b) After unrestricted recovery.

MATERIALS

1. CRIMP SPLICE: Base Metal: Copper Alloy 102 per ASTM B-75.
Plating: Nickel per QQ-N-290.
Color Code: Two color-coded stripes, see table.
2. SEALING SLEEVE: Heat-shrinkable, transparent clear, polytetrafluoroethylene (PTFE).
3. MELTABLE LINER: Fluorinated ethylene propylene. Color: clear.

APPLICATION

1. These devices provide an immersion resistant one-to-one in-line crimp splice in wires rated for at least 200°C. Multiple wire assemblies are also possible within the size range shown in the table above. Immersion resistance of multiple wire assemblies requires mechanical deformation of sealing sleeve during installation.
2. These devices are rated at 260°C maximum.
3. For installation procedure, see RPIP-685-00.
4. Parts will meet all performance requirements of EN 3373-001 and EN 3373-013 when installed according to installation procedure specified above.

| | | | | | | | |
|---|---|---|-----------------|--|----------------------|------------------|--|
| tyco / Electronics / Raychem 307 Constitution Drive Menlo Park, CA 94025, USA | | Wire and Harnessing Products | | TITLE: IN-LINE SEALED CRIMP SPLICE | | | |
| Unless otherwise specified dimensions are in millimeters. Inches dimensions are in between brackets. | | | | DOCUMENT NO.: W-096-01/-02/-03 | | | |
| TOLERANCES: 0.00 N/A 0.0 N/A 0 N/A | ANGLES: N/A ROUGHNESS IN MICRON | Tyco Electronics reserves the right to amend this drawing at any time. Users should evaluate the suitability of the product for their application. | | DCR NUMBER: D020029 | REPLACES: D990387 | | |
| DRAWN BY: mforonda | DATE: 25-Jan-02 | PROD. REV. SEE TABLE | DOC ISSUE: 4 | SCALE: None | SIZE: A | SHEET: 1 of 1 | |

If this document is printed it becomes uncontrolled. Check for the latest revision.