



Chipsmall Limited consists of a professional team with an average of over 10 year of expertise in the distribution of electronic components. Based in Hongkong, we have already established firm and mutual-benefit business relationships with customers from,Europe,America and south Asia,supplying obsolete and hard-to-find components to meet their specific needs.

With the principle of “Quality Parts,Customers Priority,Honest Operation,and Considerate Service”,our business mainly focus on the distribution of electronic components. Line cards we deal with include Microchip,ALPS,ROHM,Xilinx,Pulse,ON,Everlight and Freescale. Main products comprise IC,Modules,Potentiometer,IC Socket,Relay,Connector.Our parts cover such applications as commercial,industrial, and automotives areas.

We are looking forward to setting up business relationship with you and hope to provide you with the best service and solution. Let us make a better world for our industry!



Contact us

Tel: +86-755-8981 8866 Fax: +86-755-8427 6832

Email & Skype: info@chipsmall.com Web: www.chipsmall.com

Address: A1208, Overseas Decoration Building, #122 Zhenhua RD., Futian, Shenzhen, China



WC3-BLANK
 ASSEMBLY STICK SHOWN
 WITH 30 CLIP TAGS



FULL SCALE

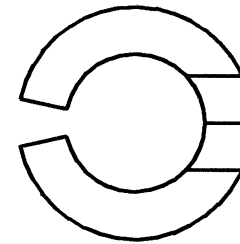
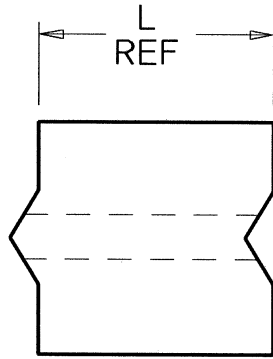

DESCRIPTION OF PART NUMBER

WC1-
 SIZE ——— LEGEND
 SEE NOTE 1

L	GAUGE	WIRE O.D. (inches)	PART NUMBER
.096	22	.039 - .055	WC1-__
.096	18	.055 - .071	WC2-__
.140	18-16	.075 - .104	WC3-__
.137	16	.102 - .138	WC6-__
.140	16-10	.128 - .177	WC9-__
.156	10	.177 - .236	WC12-__

NOTES:

1) AVAILABLE STANDARD LEGENDS INCLUDE: 0-9, A TO Z,
 AND BLANK

INVENTORS	HellermannTyton		DIMENSIONS TOLERANCES UNLESS OTHERWISE SPECIFIED units inches	PART	number SEE CHART	phase PRODUCTION	DRAWING	FORMAT AH version L	CAD	PD	scale 10X
	ALL PROPRIETARY RIGHTS IN THIS SUBJECT MATTER SHOWN ON THIS DRAWING ARE EXCLUSIVE PROPERTY OF HELLERMANNTYTON				name	CLIP-TAGS		computer file number	previous number		
	name	date			city, state	material		type	SERIES	checked	approved
	DRAWING				level	by AAM		date 03/23/99	ECN # 001168	part level A	number WM2000001SER