



Chipsmall Limited consists of a professional team with an average of over 10 year of expertise in the distribution of electronic components. Based in Hongkong, we have already established firm and mutual-benefit business relationships with customers from,Europe,America and south Asia,supplying obsolete and hard-to-find components to meet their specific needs.

With the principle of "Quality Parts,Customers Priority,Honest Operation,and Considerate Service",our business mainly focus on the distribution of electronic components. Line cards we deal with include Microchip,ALPS,ROHM,Xilinx,Pulse,ON,Everlight and Freescale. Main products comprise IC,Modules,Potentiometer,IC Socket,Relay,Connector.Our parts cover such applications as commercial,industrial, and automotives areas.

We are looking forward to setting up business relationship with you and hope to provide you with the best service and solution. Let us make a better world for our industry!



## Contact us

Tel: +86-755-8981 8866 Fax: +86-755-8427 6832

Email & Skype: info@chipsmall.com Web: www.chipsmall.com

Address: A1208, Overseas Decoration Building, #122 Zhenhua RD., Futian, Shenzhen, China



THIS COPY IS PROVIDED ON A RESTRICTED BASIS AND IS NOT TO BE USED IN ANY WAY DETRIMENTAL TO THE INTERESTS OF PANDUIT CORP.

PANDUIT PART NO.	LENGTH	WEIGHT
WCM35DW8	96.00 ±.18 [ 2438 ±4.6 ]	1.17 LBS/96 IN [ 530.7 G/2438 MM ]

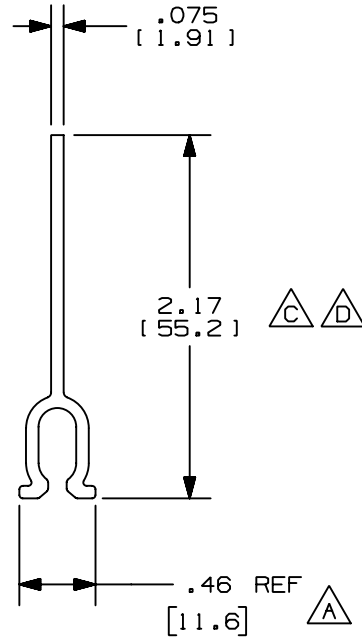

NOTES:

1. SEE CURRENT CATALOG FOR ADDITIONAL PART NUMBER SUFFIXES TO INDICATE COLOR AND/OR PACKAGE QUANTITY.
2. THIS PRODUCT IS INTENDED TO BE USED WITH PANDUIT TYPE WCM35 RACEWAY.
3. DIMENSIONS IN PARENTHESIS ARE IN METRIC.



CAD FILENAME/LAYERS D37786CG\_DC\_WCM35DW\_02A.PRT

PANDUIT CORP. TINLEY PARK, ILLINOIS  
**3.5 INCH COVE MOLDING DIVIDER WALL (WCM35DW) CUSTOMER DRAWING**

REV	DATE	BY	CHK	DESCRIPTION	ECN	CHK	CUST	SUP	DRAWN BY	MAT'L:	SCALE	DRAWING NO.	DWG SIZE
4	10-20-04	JBN	BKR	F. REVISED PART GEOMETRY	37786-15	RGRO	RGRO		JBN		NONE	37786-15	A
3	12-15-03	JBN	BKR	E. REVISED WEIGHT: WAS 1.08 LBS [ 490.0 G ] D. REVISED DIMENSION: WAS 2.18 [ 55.4 ]	37786-15	RGRO	RGRO		JBN		NONE	37786-15	A
2	11-14-02	JBN	BKR	C. REVISED DIMENSION: WAS 2.11 [ 53.6 ]	37786-15	RGRO	RGRO		JBN		NONE	37786-15	A
-	-----	----	---	RELEASED TO PRODUCTION	-----	----	----		JBN		NONE	37786-15	A
1	11-04-02	JHEP	BKR	B. REVISED PART DESCRIPTION A. REVISED DIMENSION TO REFERENCE	37786-15	RGRO	RGRO		JBN	PVC	NONE	37786-15	A
R	04-09-02	JBN	BKR	DRAWING RELEASED					JBN	PVC	NONE	37786-15	A
REV	DATE	BY	CHK	DESCRIPTION	ECN	CHK	CUST	SUP	CHK'D				

UNLESS OTHERWISE SPECIFIED, DIMENSIONAL TOLERANCES ARE:  
 (.X)± (.XXX) ± .015 (.38)  
 (.XX)± .03 (.8) ANGLES ±

UNLESS OTHERWISE SPECIFIED, ALL DIMENSIONS ARE GIVEN IN INCHES, THIRD ANGLE PROJECTION.

DRAWN BY: JBN  
 DATE: 04-09-02  
 MAT'L: PVC  
 SCALE: NONE  
 DRAWING NO.: 37786-15  
 DWG SIZE: A