



Chipsmall Limited consists of a professional team with an average of over 10 year of expertise in the distribution of electronic components. Based in Hongkong, we have already established firm and mutual-benefit business relationships with customers from,Europe,America and south Asia,supplying obsolete and hard-to-find components to meet their specific needs.

With the principle of “Quality Parts,Customers Priority,Honest Operation,and Considerate Service”,our business mainly focus on the distribution of electronic components. Line cards we deal with include Microchip,ALPS,ROHM,Xilinx,Pulse,ON,Everlight and Freescale. Main products comprise IC,Modules,Potentiometer,IC Socket,Relay,Connector.Our parts cover such applications as commercial,industrial, and automotives areas.

We are looking forward to setting up business relationship with you and hope to provide you with the best service and solution. Let us make a better world for our industry!



Contact us

Tel: +86-755-8981 8866 Fax: +86-755-8427 6832

Email & Skype: info@chipsmall.com Web: www.chipsmall.com

Address: A1208, Overseas Decoration Building, #122 Zhenhua RD., Futian, Shenzhen, China



PRODUCT NUMBER	PITCH
YK304xx0x0J0G	7.62 mm

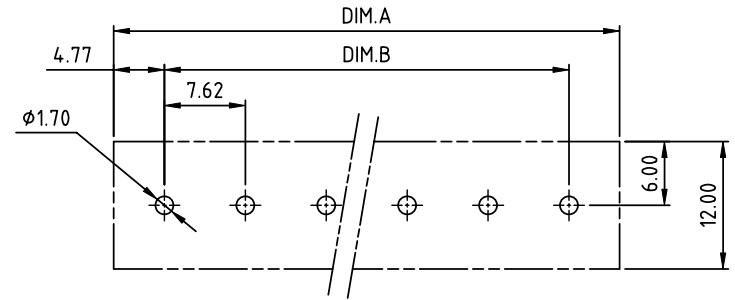
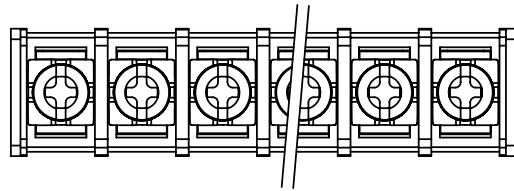

RECOMMENDED P.C.B LAYOUT
TOP VIEW

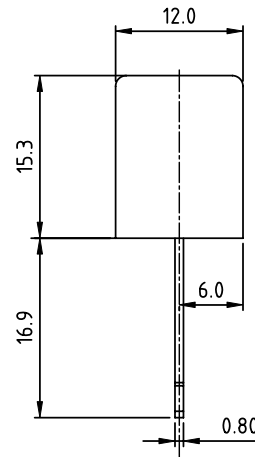
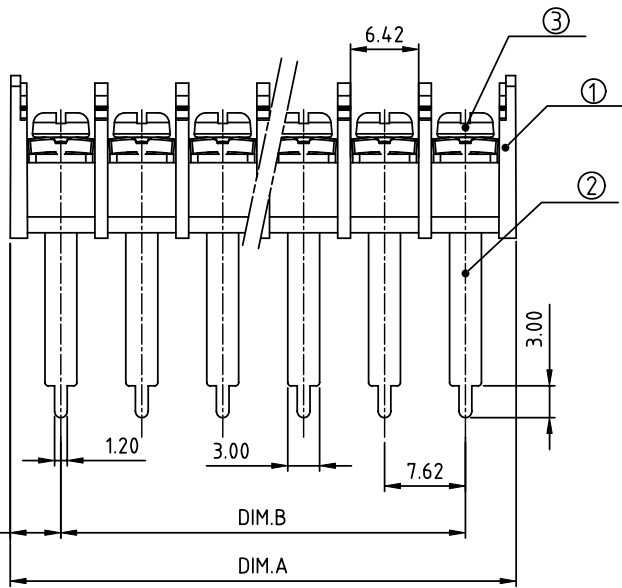

- MATERIALS ELECTRICAL
- | | |
|------------------------------|--------------------------------|
| RATED VOLTAGE & CURRENT: | 300 V, 15 A |
| WITHSTAND VOLTAGE: | AC 2000 V/Min |
| INSULATION RESISTANCE: | 1000 MΩ OR MORE AT DC 500 V |
| OPERATING TEMPERATURE RANGE: | -40 °C ~ +115 °C |
| SCREW TORQUE VALUE: | 5.2 Lb-In. |
| WIRE RANGE: | 14 ~ 22 AWG |
| 1) HOUSING: | THERMOPLASTIC, UL 94 V-0 BLACK |
| 2) TERMINAL: | BRASS, 0.8t |
| 3) TERMINAL SCREWS: | STEEL, M3 |

DIMENSION

Dim A	(N-1)×7.62+9.54
Dim B	(N-1)×7.62

N=Number of poles

Poles	Tolerance
2p-4p	±0.20
5p-10p	±0.30
11p-16p	±0.40
17p-20p	±0.50

PART NO.: YK 304xx 0 x 0 J0G

No. of poles	Plated			RoHS compliant (lead<4%) In copper Alloy	
	02 2 poles	Code	Terminal		Screw
	03 3 poles	0	G/F		G/F
	1	G/F		Zinc
20 20 poles	2	Tin	G/F		
	3	Tin	Zinc		

mat'l. code		surface ASME Y14.5	tolerance ASME Y14.5	projection	product family
ltr	ecn no	dr	date		TERMINAL BLOCK
tolerances unless otherwise specified				MM	title
angles				scale	TERMINAL BLOCK
X°±1'					BARRIER TYPE
X.X±0.5					dwg no
X.XX±0.3					sheet 1 of 1
X.XX±0.1					size
dr	HANKE FENG	060914			YK304xx0x0J0G
enr	HANKE FENG	060914			A4
chr	HANKE FENG	060914			
appd	SHI JUN	060914			type
					CUSTOMER Drawing
sheet index	revision	A			
	sheet	1			