



Chipsmall Limited consists of a professional team with an average of over 10 year of expertise in the distribution of electronic components. Based in Hongkong, we have already established firm and mutual-benefit business relationships with customers from,Europe,America and south Asia,supplying obsolete and hard-to-find components to meet their specific needs.

With the principle of "Quality Parts,Customers Priority,Honest Operation,and Considerate Service",our business mainly focus on the distribution of electronic components. Line cards we deal with include Microchip,ALPS,ROHM,Xilinx,Pulse,ON,Everlight and Freescale. Main products comprise IC,Modules,Potentiometer,IC Socket,Relay,Connector.Our parts cover such applications as commercial,industrial, and automotives areas.

We are looking forward to setting up business relationship with you and hope to provide you with the best service and solution. Let us make a better world for our industry!



## Contact us

Tel: +86-755-8981 8866 Fax: +86-755-8427 6832

Email & Skype: [info@chipsmall.com](mailto:info@chipsmall.com) Web: [www.chipsmall.com](http://www.chipsmall.com)

Address: A1208, Overseas Decoration Building, #122 Zhenhua RD., Futian, Shenzhen, China

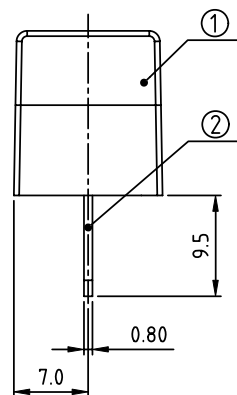
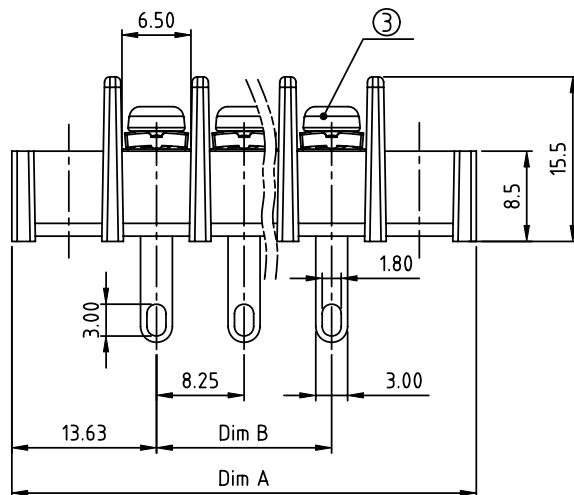
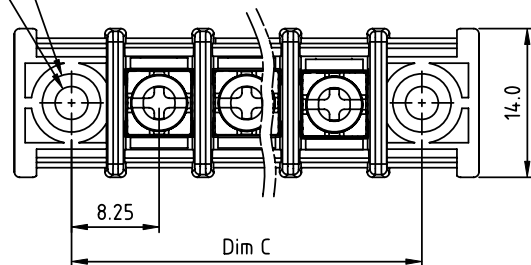

PRODUCT NUMBER	PITCH
YK413xx3x0J0G	8.25 mm

2- $\phi$ 5.5 Depth:4.52- $\phi$ 3.1

MATERIALS & ELECTRICAL  
 RATED VOLTAGE & CURRENT:  
 WITHSTAND VOLTAGE:  
 INSULATION RESISTANCE:  
 OPERATING TEMPERATURE RANG:  
 SCREW TORQUE VALUE:  
 WIRE RANGE:  
 1) HOUSING:  
 2) TERMINAL:  
 3) TERMINAL SCREWS:  
 APPROVAL: us

300 V, 20 A  
 AC 2000 V/Min  
 1000 M $\Omega$  OR MORE AT DC 500 V  
 -40 °C ~ +115 °C  
 8.8 Lb-In.  
 22 - 12 AWG  
 THERMOPLASTIC, UL 94 V-0 BLACK  
 BRASS, 0.8t  
 STEEL, M3

## DIMENSION

Dim A	(N+2)×8.25+2.5
Dim B	(N-1)×8.25
Dim C	(N+1)×8.25

N=Number of poles

Poles	Tolerance
2p-5p	±0.25
6p-10p	±0.35
11p-18p	±0.40
19p-30p	±0.50

PART NO.: YK 413xx 3 x 0 J0G

No. of poles  
 02 2 poles  
 03 3 poles  
 ...  
 30 30 poles

Plated

Code	Terminal	Screw
0	G/F	G/F
1	G/F	Zinc
2	Tin	G/F
3	Tin	Zinc

RoHS compliant  
 (lead<4%)  
 In copper Alloy

mat'l. code				surface	tolerance	projection	product family	
ltr	ecn	no	dr	date	ASME Y14.5 ✓	ASME Y14.5	TERMINAL BLOCK	
					tolerances unless otherwise specified		title	
					angles	X.±0.5	TERMINAL BLOCK	
					hole	X.X±0.3	BARRIER TYPE, WITH FLANGE	
					X'±1"	X.XX±0.1	scale	
					dr	EVAN LU 061314	dwg no	
					enr	EVAN LU 061314	sheet 1 of 1	
					chr	HANKE FENG 061314	size	
					appd	SHI JUN 061314	A4	
							type	
							CUSTOMER Drawing	
sheet index	revision	A						
	sheet	1						