



Chipsmall Limited consists of a professional team with an average of over 10 year of expertise in the distribution of electronic components. Based in Hongkong, we have already established firm and mutual-benefit business relationships with customers from,Europe,America and south Asia,supplying obsolete and hard-to-find components to meet their specific needs.

With the principle of “Quality Parts,Customers Priority,Honest Operation,and Considerate Service”,our business mainly focus on the distribution of electronic components. Line cards we deal with include Microchip,ALPS,ROHM,Xilinx,Pulse,ON,Everlight and Freescale. Main products comprise IC,Modules,Potentiometer,IC Socket,Relay,Connector.Our parts cover such applications as commercial,industrial, and automotives areas.

We are looking forward to setting up business relationship with you and hope to provide you with the best service and solution. Let us make a better world for our industry!



## Contact us

Tel: +86-755-8981 8866 Fax: +86-755-8427 6832

Email & Skype: info@chipsmall.com Web: www.chipsmall.com

Address: A1208, Overseas Decoration Building, #122 Zhenhua RD., Futian, Shenzhen, China



|                |         |
|----------------|---------|
| PRODUCT NUMBER | PITCH   |
| YK601xx0x0JOG  | 10.00mm |

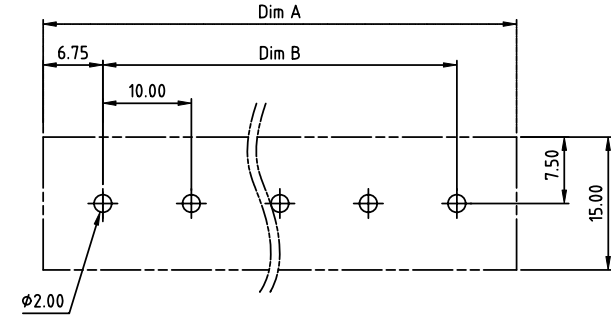
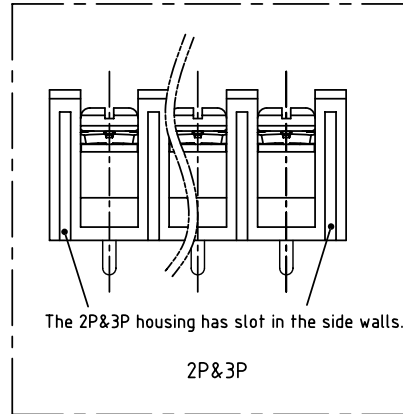
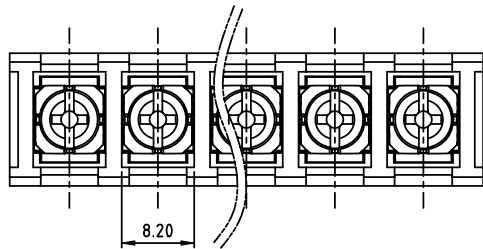

RECOMMENDED P.C.B LAYOUT  
TOP VIEW

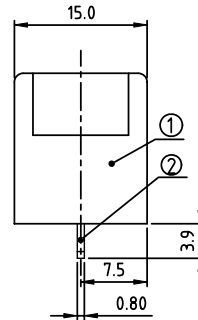
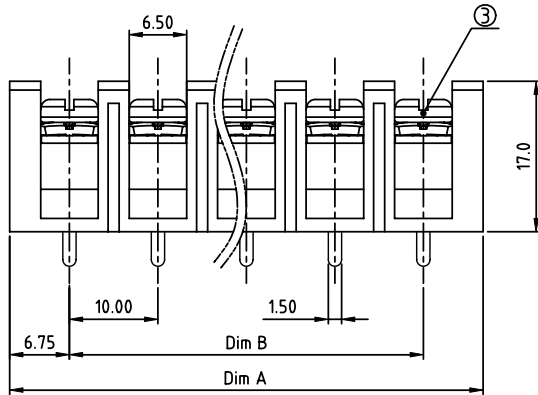

MATERIALS ELECTRICAL  
 RATED VOLTAGE & CURRENT: 300 V, 20 A  
 WITHSTAND VOLTAGE: AC 2000 V/Min  
 INSULATION RESISTANCE: 1000 M $\Omega$  OR MORE AT DC 500 V  
 OPERATING TEMPERATURE RANG: -40 °C ~ +115 °C  
 SCREW TORQUE VALUE: 12Lb-In.  
 WIRE RANGE: 22 - 12 AWG  
 1) HOUSING: THERMOPLASTIC, UL 94 V-0 BLACK  
 2) TERMINAL: BRASS, 0.8t  
 3) SCREWS: STEEL, M3.5  
 APPROVAL:

DIMENSION

|       |                           |
|-------|---------------------------|
| Dim A | N $\times$ 10.0 $\pm$ 3.5 |
| Dim B | (N-1) $\times$ 10.0       |

N=Number of poles

| Poles   | Tolerance  |
|---------|------------|
| 2p-4p   | $\pm$ 0.20 |
| 5p-10p  | $\pm$ 0.30 |
| 11p-24p | $\pm$ 0.40 |
| 25p-30p | $\pm$ 0.50 |

PART NO.: YK 601xx 0 x 0 JOG

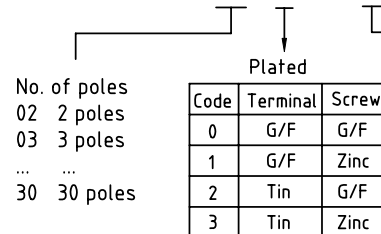

RoHS compliant  
(lead<4%)  
In copper Alloy

|             |          |                       |                         |                                       |                                  |
|-------------|----------|-----------------------|-------------------------|---------------------------------------|----------------------------------|
| mat'l. code |          | surface<br>ASME Y14.5 | tolerance<br>ASME Y14.5 | projection<br>                        | product family<br>TERMINAL BLOCK |
| ltr         | ecn no   | dr                    | date                    | tolerances unless otherwise specified | title<br>TERMINAL BLOCK          |
|             |          |                       |                         | angles<br>$\phi$<br>X $\pm$ 1°        | BARRIER TYPE                     |
|             |          |                       |                         | dr<br>EVAN LU 061214                  | scale                            |
|             |          |                       |                         | enr<br>EVAN LU 061214                 | FCI                              |
|             |          |                       |                         | chr<br>HANKE FENG 061214              | dwg no<br>YK601xx0x0JOG          |
|             |          |                       |                         | appd<br>SHI JUN 061214                | sheet 1 of 1 size<br>A4          |
| sheet index | revision | A                     |                         | type                                  | CUSTOMER Drawing                 |
|             | sheet    | 1                     |                         |                                       |                                  |