



Chipsmall Limited consists of a professional team with an average of over 10 year of expertise in the distribution of electronic components. Based in Hongkong, we have already established firm and mutual-benefit business relationships with customers from,Europe,America and south Asia,supplying obsolete and hard-to-find components to meet their specific needs.

With the principle of “Quality Parts,Customers Priority,Honest Operation,and Considerate Service”,our business mainly focus on the distribution of electronic components. Line cards we deal with include Microchip,ALPS,ROHM,Xilinx,Pulse,ON,Everlight and Freescale. Main products comprise IC,Modules,Potentiometer,IC Socket,Relay,Connector.Our parts cover such applications as commercial,industrial, and automotives areas.

We are looking forward to setting up business relationship with you and hope to provide you with the best service and solution. Let us make a better world for our industry!



Contact us

Tel: +86-755-8981 8866 Fax: +86-755-8427 6832

Email & Skype: info@chipsmall.com Web: www.chipsmall.com

Address: A1208, Overseas Decoration Building, #122 Zhenhua RD., Futian, Shenzhen, China





SURFACE MOUNT WHITE LED SIDE VIEW 2.8 X 1.2 X 0.8mm

FEATURES

- SIDE VIEW WHITE
- LED (2.8 x 1.2 x 0.8mm)
- WHITE SMT PACKAGE
- LEAD FRAME PACKAGE WITH INDIVIDUAL 2-PINS
- InGaN WITH YELLOW PHOSPHOR
- WIDE VIEW ANGLE (X: 120°/Y: 120°)
- IR REFLOW SOLDERING
- ESD PROTECTION

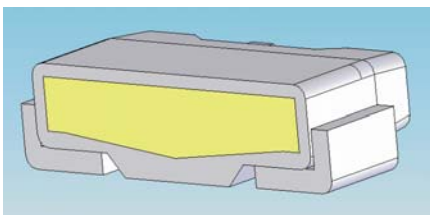
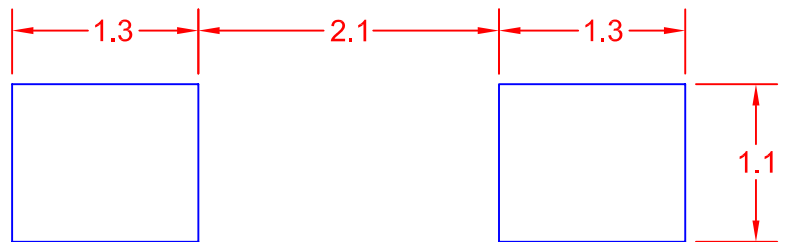
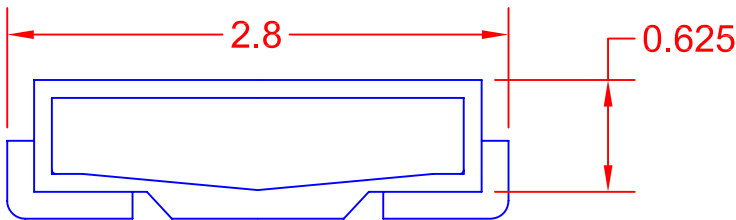
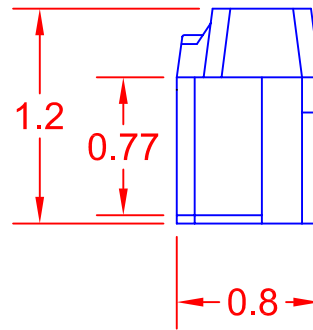
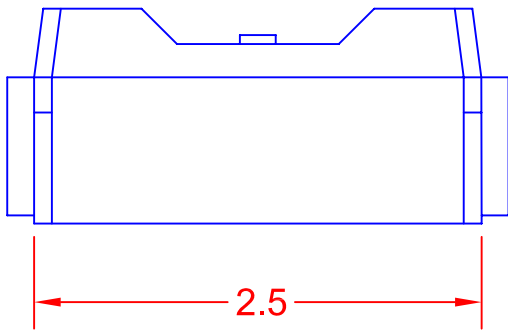

JKL PART NO.: ZSM-S2808-W

RECOMMENDED SOLDERING PAD LAYOUT





SURFACE MOUNT WHITE LED SIDE VIEW 2.8 X 1.2 X 0.8mm

SPECIFICATIONS

ABSOLUTE MAXIMUM RATINGS (TA = 25°C)
(LED die)

ITEM	SYMBOL	ABSOLUTE MAXIMUM RATING	UNIT
Forward Current	I_F	30	mA
Pulse Forward Current*	I_{FP}	100	mA
Reverse Voltage	V_R	5	V
Power Dissipation	P_D	120	mW
Operating Temperature	T_{opr}	-30 ~ +85	°C
Storage Temperature	T_{stg}	-40 ~ +100	°C
Soldering Temperature	T_{sld}	Reflow Soldering: 260° C for 10 secs Hand Soldering: 350° C for 3 secs	

(Zener diode)

ITEM	SYMBOL	CONDITION	MIN	MAX	UNIT
Reverse Leakage Current	I_R	$V_R = 5V$	---	0.5	uA
Zener Voltage	V_Z	$I_Z = 5mA$	5.8	6.8	V
Forward Voltage	V_F	$I_F = 20mA$	---	1.2	V

* I_{FP} Conditions: Pulse Width $\leq 10msec$, and duty $\leq 1/10$

ELECTRICAL & OPTICAL OPERATING CHARACTERISTICS (TA = 25°C)

ITEM	SYMBOL	CONDITION	MIN	MAX	UNIT
Forward Voltage	V_F	$I_F = 20mA$	2.8	3.6	Volt
Luminous Intensity	L_V	$I_F = 20mA$	1000	1400	mcd
Color Coordinates	x, y	$I_F = 20mA$.267	.304	x
			.260	.290	y
Viewing Angle	---	$I_F = 20mA$	120° x	120° y	Degrees



SURFACE MOUNT WHITE LED SIDE VIEW 2.8 X 1.2 X 0.8mm

		K1			
x		0.2890	0.2835	0.2788	0.2843
y		0.2900	0.2800	0.2800	0.2900
		K3			
x		0.2780	0.2725	0.2673	0.2730
y		0.2700	0.2600	0.2600	0.2700
		W2			
x		0.2886	0.2831	0.2780	0.2835
y		0.2800	0.2700	0.2700	0.2800
		X1			
x		0.2993	0.2938	0.2886	0.2941
y		0.2900	0.2800	0.2800	0.2900
		X3			
x		0.2883	0.2829	0.2778	0.2831
y		0.2700	0.2600	0.2600	0.2700
		Y2			
x		0.2987	0.2932	0.2883	0.2938
y		0.2800	0.2700	0.2700	0.2800

		K2			
x		0.2835	0.2780	0.2730	0.2788
y		0.2800	0.2700	0.2700	0.2800
		W1			
x		0.2941	0.2886	0.2835	0.2890
y		0.2900	0.2800	0.2800	0.2900
		W3			
x		0.2831	0.2778	0.2725	0.2780
y		0.2700	0.2600	0.2600	0.2700
		X2			
x		0.2938	0.2883	0.2831	0.2886
y		0.2800	0.2700	0.2700	0.2800
		Y1			
x		0.3042	0.2987	0.2938	0.2993
y		0.2900	0.2800	0.2800	0.2900
		Y3			
x		0.2932	0.2879	0.2829	0.2883
y		0.2700	0.2600	0.2600	0.2700

BIN RANGE OF CHROMATICITY COORDINATES

*If color binning is required, only one color group is allowed for each chip within a reel.

Chromaticity coordinate groups are measured with an accuracy of ± 0.01 .

*Color coordinate is derived from the CIE 1931 chromaticity.

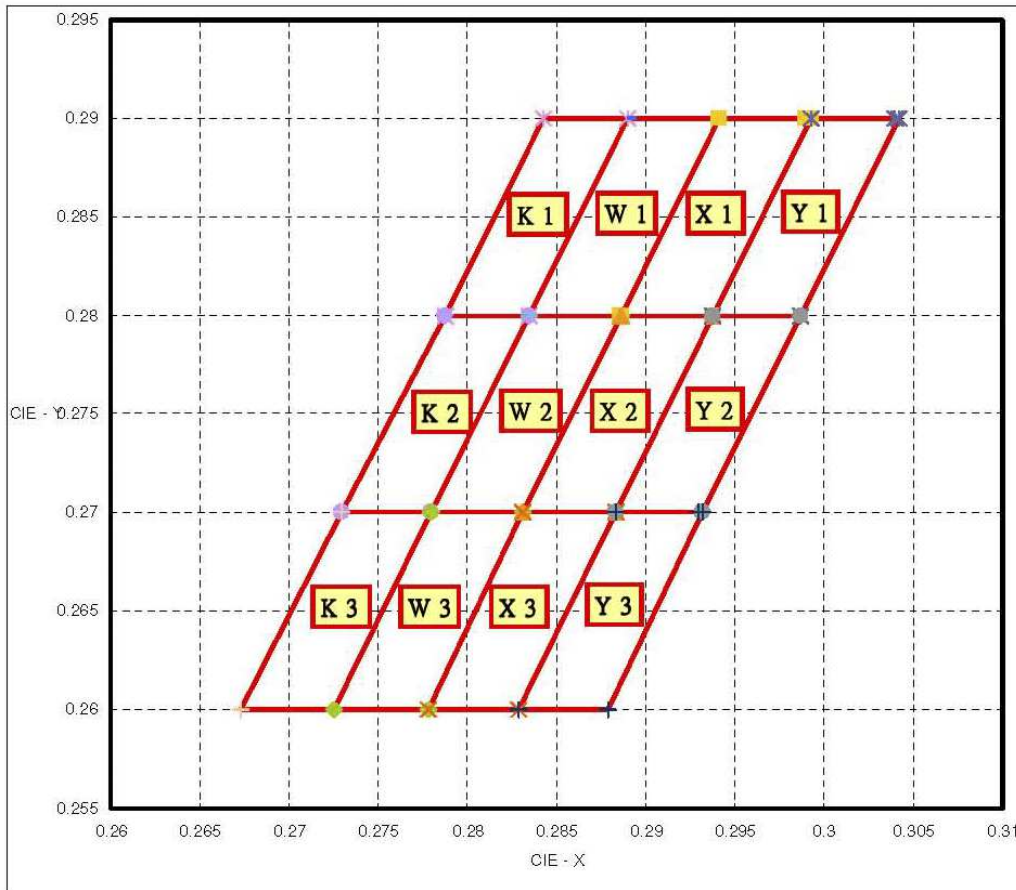



SURFACE MOUNT WHITE LED SIDE VIEW 2.8 X 1.2 X 0.8mm

TYPICAL ELECTRO-OPTICAL CHARACTERISTICS CURVES

Forward voltage vs. Forward current

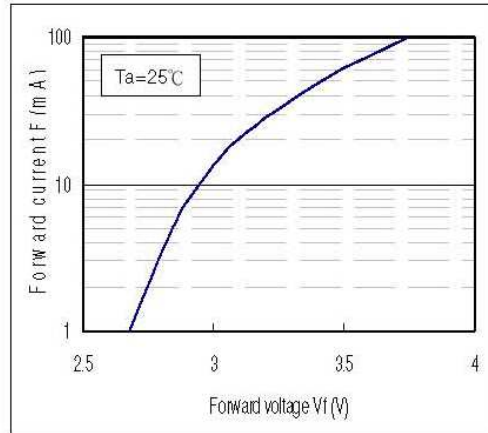

Forward current vs. Relative luminosity

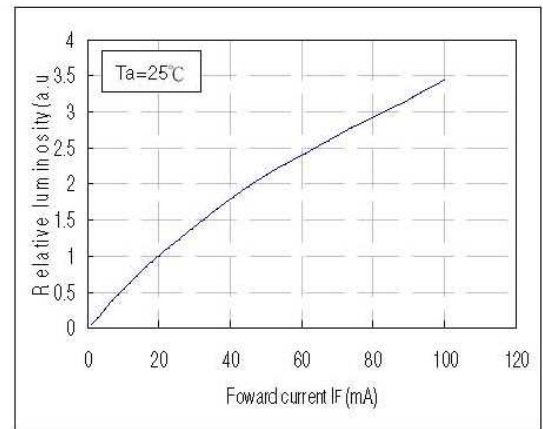

Duty ratio vs. Allowable forward current

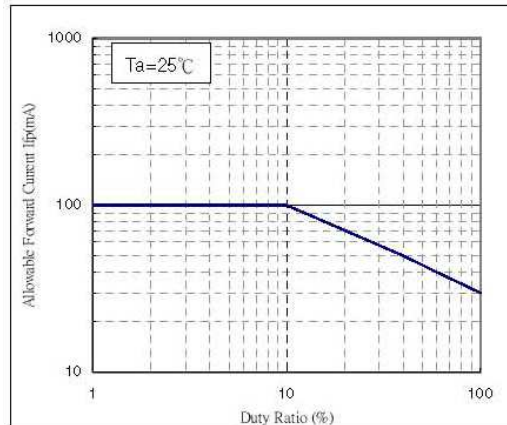

Ambient temperature vs. Forward voltage

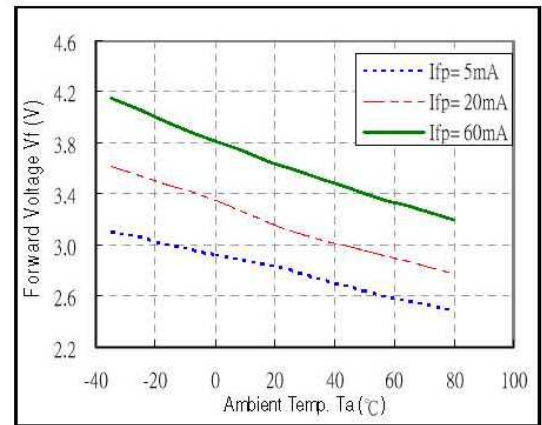

Ambient temperature vs. Relative luminosity

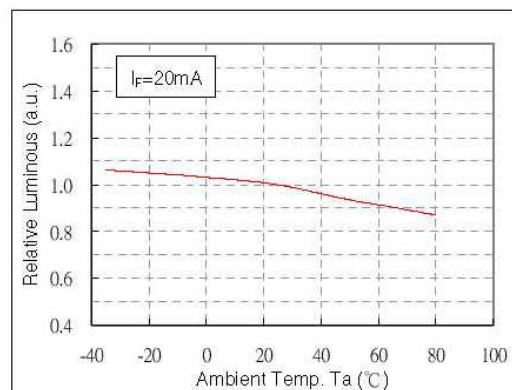

Ambient temperature vs. Allowable forward current

